

LEGEND

○ = Corner having information on form 5680-2 in this file.

Legend conforms to Reporting forms MPMCC 11/79

FILING INSTRUCTION

File 5680-2 card record by letter and number coordinates behind the file guide for the township in which it falls.

File the 5680-2 card record by letter and then by number i.e., all A cards first, then B cards etc.

The first card behind the file guide (if data have been obtained and recorded) will be card A-1 for N.W. Township Corner, then card A-2 for 1/16 corner then card A-3 for 1/4 corner etc.

Index

File No. ~~1152~~ 0151

CORNER RECORD (SEARCH)

Contract or Survey No. 53-0444-3-02829

T 16 S. R. 10 E.

R.D. SISTERS

Survey No.

Cor. No. A-01

Merid. Willamette

N.F. Deschutes

County DESCHUTES

CC

Cor. of

State Oregon

Section 156

CORNER DIAGRAM, per legend

DESCRIBE CORNER MONUMENT FOUND

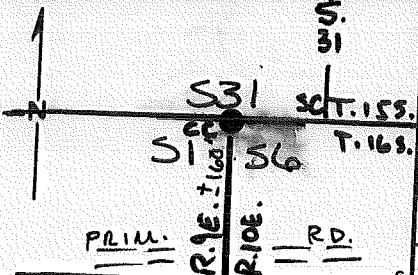

FD. ORIG. 20X13X8 BASALT STONE WITH 6 NOTCHES AND CC CHISELED ON FACE

STONE LYING LOOSE ON GROUND

STONE NOW MEASURED 20X13X8

DESCRIBE BEARING TREES OR OTHER OFFICIAL ACCESSORIES FOUND

FOUND TWO ORIGINAL TREES TREE IN SW QUADRANT IS A DEAD SNAG

TREE IN SE QUADRANT ALIVE & WELL

PHOTO IDENTIFICATION DATA

Photo No. _____
 Filed At. _____
 Object Ident. _____
 Ident. By _____
 Signature _____

DESCRIBE CORNER LOCATION RELATIVE TO NEAR-BY FEATURES, ALSO HOW TO REACH CORNER

FOLLOWING THREE CREEKS RD. TO THE SUMMIT ON SQUAW CREEK RIDGE FIRST DIRT TO THE WEST FOLLOW THE SOUTHERN MOST RD TO FENCE LINE ANGLE PT 1/4 1/6 CORNER LIES NORTH JUST OVER RIDGE CREST

CORNER LEGEND:

- FS or Contr. Unverified
- Other Searched For/Not Found
- Evidence Found/Accept.
- Permanent Mon. Set/Fd.

Searched By: RCC

RCC

Title PLS 1632

Division

Headquarters

Date

3/28/84

CORNER RECORD (PERPETUATION)

MONUMENT: DESCRIBE NEW MONUMENT SET, OR WORK DONE TO PRESERVE EXISTING MONUMENT

SET STANDARD USFS 2 1/2" X 30" GALV. PIPE & BRASS CAP FIRMLY IN GROUND RISING 5" ABOVE GROUND ERECTED STONE ^{MOULD} ~~PIPS~~ AROUND MONUMENT

MONUMENT STAMPED

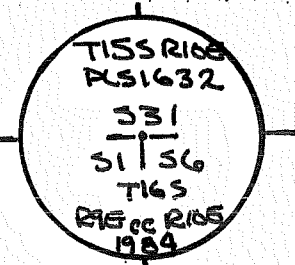

ACCESSORIES: DESCRIBE NEW BT'S WITNESS OBJECTS ETC. ESTABLISHED, OR WORK DONE TO PRESERVE EXISTING EVIDENCE

8" DOUGLAS FIR BEAR S57 1/2° E 42.83 FT SCRIBED
"CC TIGS R10E 56 BT"; 60d NAIL IN SW BASE.

6" DBH P. PINE BEARS S27° 30' W 86.71 FT SCRIBED
"CC TIGS R9E 51 BT"; 60d NAIL IN NW BASE.

Work Done By RCC Title PLS Date _____ State Registration No. 1632
or Agency _____
Established or Record Prepared Yes No Filed At: Desch. Co. Surveyor's Office Date 3 MAY 1984

History of Surveys, G.L.O., etc. WM. ~~CAMP~~ CAMPBELL IN 1901 SET A STONE 18 X 12 X 8
PINE 30" DIA BEARS S22° E 68 LKS
PINE 30" DIA BEARS S45° W 68 LKS

Index File No. 0151 ~~16~~ S., R. 10 E., W.M. Contract or Surv. No. 53-0466-3-02829 Cor. A-01

USDA-FOREST SERVICE

Index

File No. 0551

CORNER RECORD (SEARCH)

(Ref. FSM 7151.4)

Tract or Survey No. 53-044-3-02227

A-05

T 16 S R. 10 E

R.D. SISTERS

County DESCHUTES

Cor. No. C. COENER

OF SEC. 5/6

Merid. W M

N.F. DESCHUTES

State OREGON

CORNER DIAGRAM

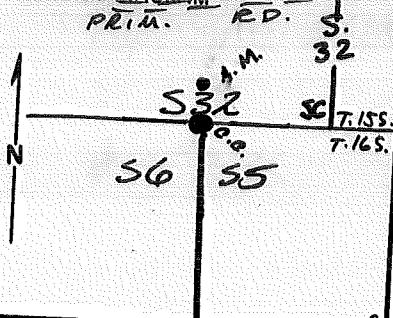

DESCRIBE CORNER MONUMENT FOUND

FOUND ORIG. 24X15X8 BASALT STONE WITH "CC" ON SOUTH FACE & 5 GROVES ON EAST FACE & 1 GROVE ON WEST FACE

DESCRIBE BEARING TREES OR OTHER OFFICIAL ACCESSORIES FOUND

FOUND REMAINS OF 24" DIA PINE BT BEARS 554°E 25 LKS. SCRIBED "T16S R10E 55 BT"

FOUND REMAINS OF 20" DIA PINE BT BEARS 578°W 31 LKS SCRIBED T16S R10E 56 BT

DESCRIBE CORNER LOCATION RELATIVE TO NEAR-BY FEATURES, ALSO HOW TO REACH CORNER

CORNER LIES ON SMALL ROCK OUTCROPPING 150' ± SOUTH OF DIRT RD. NUMBER UNKNOWN

PHOTO IDENTIFICATION DATA

Photo No. _____
Filed At. _____
Object Ident. _____
Ident. By _____
Signature _____

PLANE COORDINATE POSITION DATA

State _____ Zone _____
X _____
Y _____
Estab. By _____
Agency _____

Signature

RCC

Title

PLS1632

Division

+

Headquarters

Date

5/31/84

7100-52-(3/68)

CORNER RECORD (PERPETUATION)

MONUMENT: DESCRIBE NEW MONUMENT SET, OR WORK DONE TO PRESERVE EXISTING MONUMENT

SET STANDARD USFS 2 1/2" X 30" GALV. PIPE & BRASS CAP
 FIRMLY IN GROUND RISING 6" ABOVE NATURAL GROUND
 ERECTED STONE ^{MOUND} ~~MARK~~ AROUND MONUMENT MARKED
 AS STATION. AM & CC IN SAME MOUND AT E. SIDE OF
 30" X 24" BOULDER RISING 30"; ± 150' S. OF PRIMITIVE ROAD.

TISS RIDE
 PLS 1632
 1984
 AM 532
 56 1/2
 TISS RIDE
 AM RSG. 4"

ACCESSORIES: DESCRIBE NEW BT'S WITNESS OBJECTS ETC. ESTABLISHED, OR WORK DONE TO PRESERVE EXISTING EVIDENCE

DOUBLE BLAZED TWIN ~~TRUNK~~ ^{TRUNK} JUNIPER SCRIBED 5" DBH MAIN TRUNK
 CC T16S R10E S6 IN UPPER & BT IN LOWER BEARS ^{60d NAIL IN SE BASE} 556°W 49.38 FT. TO AM
 7" DBH P. PINE BEARS ^{TO A.M.} 547°E 50.03 FT SCRIBED CC T16S R10E S5 BT
^{55°30'W 48.76 FT. TO T.C.}
 549°E 49.41 FT. TO T.C. ^{60d NAIL IN SW BASE}

Work Done By RCC Title PLS 1632 Date 5/84 State Registration No. _____
 or Agency _____
 Certified Cor. Record Prepared? Yes No Filed At: DES. CO. SURV. OFFICE Date 12 JUNE 1984

TISS RIDE 10
 PLS 1632
 1984
 532
 55 1/2
 CC
 T16S R10E 11
 TC RSG. 6"

REMARKS
 C. CAMPBELL IN 1902 SET A 24 X 15 X 8 BASALT STONE &
 24" DIA. PINE BEARS 554°E 25 LKS SCRIBED T16S R10E S5 BT
 20" DIA. PINE BEARS 578°W 31 LKS SCRIBED T16S R10E S6 BT

Index File No. 0551 T. 16S R. 10E M. WM Tract or Surv. No. 53-0966-3-02827 Cor. A 05
 U.S. G.P.O. 1977-725-576/586

USDA-FOREST SERVICE

Index

File No. A-09

T 165 R. 10E

CORNER RECORD (SEARCH)

(Ref. FSM 7151.4)

Tract or Survey No. _____

Cor. No. 951

Merid. NH

R.D. SISTERS

County DESCHUTES

NW COR SEC 4

N.F. DESCHUTES

State OREGON

CORNER DIAGRAM

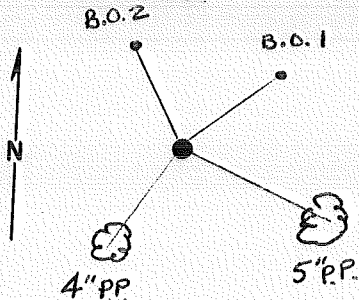

DESCRIBE CORNER MONUMENT FOUND

F.D. 5/8" I.R. BY PLS 540 AT ORIG. CORNER POSITION
(AMENDED COR.), NORTHERLY, 1.74 FT.

DESCRIBE BEARING TREES OR OTHER OFFICIAL ACCESSORIES FOUND

PHOTO IDENTIFICATION DATA

Photo No. _____

Filed At. _____

Object Ident. _____

Ident. By _____

Signature

PLANE COORDINATE POSITION DATA

State _____ Zone _____

X _____

Y _____

Estab. By _____

Agency

Signature

FAST

Title

PLS

Division

Headquarters

Date

1-21-91

FS-7100-52 (3/68)

CORNER RECORD (PERPETUATION)

MONUMENT: DESCRIBE NEW MONUMENT SET, OR WORK DONE TO PRESERVE EXISTING MONUMENT

SET 2 1/2" x 30" BRASS CAPPED I.P. RSG. 0.3 FT.

T155 RIDE
 S 33
 S5 | S4
 T165 CC RIDE
 1991
 PLS 1938

9

ACCESSORIES: DESCRIBE NEW BT'S WITNESS OBJECTS ETC. ESTABLISHED OR WORK DONE TO PRESERVE EXISTING EVIDENCE

4" P.P. - S34°W - 82.4 FT. SCRIBED (C 14 1/2 RIDE 30 BOT)

5" P.P. - S42°E - 65.8 FT. SCRIBED (C 14 1/2 RIDE 30 BOT)

ALUM. NAIL BRASS WASHER
PLS 1938

SET 5/8" x 30" IR W/ 1/2" ALUM. CAP N24°W - 54.31 FT.

B02
 PLS 1938
 1991

SET 5/8" x 30" IR W/ 1/2" ALUM. CAP N43°E - 56.85 FT.

B01
 PLS 1938
 1991

10

Work Done By: F. AST Title: PLS Date: 1-21-91 State Registration No. or Agency: PLS 1938

Certified Cor. Record Prepared? Yes No Filed At: DESCHUTES CO. Date: 1-21-91

11

(FIND PLAT)

REMARKS

G.L.O. BY NEWMAN - 1871
SURVEY BY P.L.S. 540 DATED Nov. 3, 1969

12

Index File No. A-09 T. 165 R. 10E WM. Tract or Surv. No. Cor. 13
 GPO : 1984 O - 439-095

USDA-FOREST SERVICE

Index
File No. A-13

CORNER RECORD (SEARCH)
(Ref. FSM 7151.4)

Tract or
Survey No. _____

Cor.
No. 1351

(9)

T 165 R. 10 E

R.D. SISTERS

County DESCHUTES

NE COR

Merid. WM

N.F. DESCHUTES

State OREGON

SEC 4

CORNER DIAGRAM

DESCRIBE CORNER MONUMENT FOUND

F.D. 518" I. R. SET BY P.L.S. 540 AT ORIGINAL
CORNER POSITION WHICH FALLS 1.7 FT NORTH OF
THE STANDARD PARALLEL.

DESCRIBE BEARING TREES OR OTHER OFFICIAL ACCESSORIES FOUND

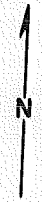

PHOTO IDENTIFICATION DATA

Photo No. _____
Filed At. _____
Object Ident. _____
Ident. By _____
Signature _____

PLANE COORDINATE POSITION DATA

State _____ Zone _____
X _____
Y _____
Estab. By _____
Agency _____

DESCRIBE CORNER LOCATION RELATIVE TO NEAR-BY FEATURES, ALSO HOW TO REACH CORNER

Signature
F. AST

Title
PLS

Division

Headquarters

Date
1-21-91

FS-7100-52 (3/68)

CORNER RECORD (PERPETUATION)

MONUMENT: DESCRIBE NEW MONUMENT SET, OR WORK DONE TO PRESERVE EXISTING MONUMENT

9

ACCESSORIES: DESCRIBE NEW BT'S WITNESS OBJECTS ETC. ESTABLISHED, OR WORK DONE TO PRESERVE EXISTING EVIDENCE

10

Work Done By F. AST Title PLS Date 1-21-91 State Registration No. PLS 1938
or Agency

PLAT
Certified Cor-Record Prepared? Yes No Filed At: DESCHUTES CO Date 1-21-91

11

REMARKS

G.L.O. BY NEWMAN - 1871

SURVEY BY PLS. 540 DATED NOV. 3, 1969

12

Index File No. T. 165 R. 10E WM. Tract or Surv. No. Cor.

13

Index File No. 1751 CORNER RECORD (SEARCH) Contract or Survey No.
 (Ref. FSM 7151.4) Merid. T 16 S. R. 10 E. R.D. Sisters County Deschutes Cor. No. A-17
Willamette N.F. Deschutes State Oregon Section 35 Cor. of 3/2

CORNER DIAGRAM, per legend

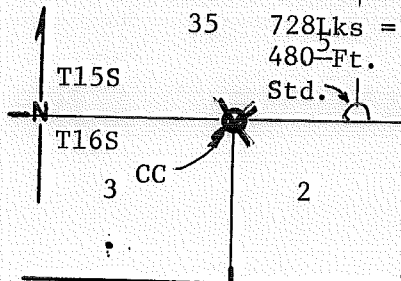

DESCRIBE CORNER MONUMENT FOUND

Stone "15 x 9" x 7" Mkd. 2 notches on east side

DESCRIBE BEARING TREES OR OTHER OFFICIAL ACCESSORIES FOUND

24" juniper bears S 70°W @21° Mkd. T16S R10E S3

PHOTO IDENTIFICATION DATA

Photo No.
 Filed At.
 Object Ident.
 Ident. By
 Signature

DESCRIBE CORNER LOCATION RELATIVE TO NEAR-BY FEATURES, ALSO HOW TO REACH CORNER

Directions same as 1/4 3&2

CORNER LEGEND:

- FS or Unverified
- Contr. Other
- Searched For/Not Found
- ◇ Searched For/Not Found
- ⊗ Evidence Found/Accept.
- ⊗ Evidence Found/Accept.
- Permanent Mon. Set/Pd.
- ◆ Permanent Mon. Set/Pd.

Searched By: S.C. C.B. Title S.T. S.A. Division Survey Headquarters SO Date 5-19-83

CORNER RECORD (PERPETUATION)

MONUMENT: DESCRIBE NEW MONUMENT SET, OR WORK DONE TO PRESERVE EXISTING MONUMENT

MONUMENT STAMPED

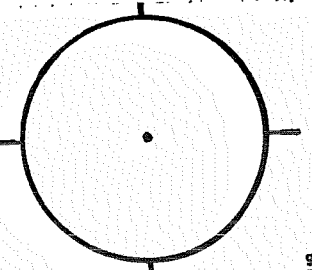

9

ACCESSORIES: DESCRIBE NEW BT'S WITNESS OBJECTS ETC. ESTABLISHED, OR WORK DONE TO PRESERVE EXISTING EVIDENCE

10

Work Done By _____ Title _____ Date _____ State Registration No. or Agency _____

Plat of _____
Certified Cor. Record Prepared? Yes No Filed At: _____ Co. Surveyor's Office Date _____

11

History of Surveys, G.L.O., etc.
1871: Stone 15 x 9 x 7
9" Jun. S70°W @ 21¹/₂ Ft. (32 L.)

12

Index File No. 1751 T. 16 S., R.10 E., W.M. Contract or Surv. No. Cor. A-17

13

Index File No. 2151 CORNER RECORD (SEARCH) Contract or Survey N^o. _____
 T 16 S. R. 10 E. R.D. Sisters (Ref. FSM 7151.4) County Deschutes Cor. A-21 No. _____
 Merid. Willamette N.F. Deschutes State Oregon CC Cor. of Section 2 & 1

CORNER DIAGRAM, per legend

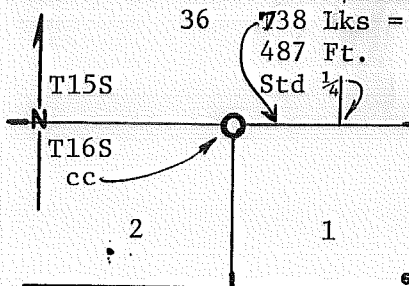

DESCRIBE CORNER MONUMENT FOUND

S.F.N.F.

DESCRIBE BEARING TREES OR OTHER OFFICIAL ACCESSORIES FOUND

Corner falls in pasture. Has been cleared for years.

PHOTO IDENTIFICATION DATA

Photo No. _____
 Filed At. _____
 Object Ident. _____
 Ident. By _____
 Signature _____

DESCRIBE CORNER LOCATION RELATIVE TO NEAR-BY FEATURES, ALSO HOW TO REACH CORNER

CORNER LEGEND:

- FS or Unverified
- Contr. Other
- ◊ Searched For/Not Found
- ⊗ ⊗ Evidence Found/Accept.
- ◆ Permanent Mon. Set/Fd.

Searched By: SC Title S.T. Division _____ Headquarters _____ Date _____
CB S.A. Survey SO 5-19-83

CORNER RECORD (PERPETUATION)

MONUMENT STAMPED

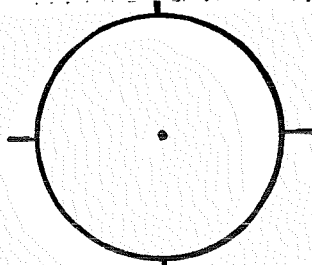

MONUMENT: DESCRIBE NEW MONUMENT SET, OR WORK DONE TO PRESERVE EXISTING MONUMENT

ACCESSORIES: DESCRIBE NEW BT'S WITNESS OBJECTS ETC. ESTABLISHED, OR WORK DONE TO PRESERVE EXISTING EVIDENCE

At std. $\frac{1}{4}$ to East ~~Grate~~ probably set #5 SR ~~as~~ he shows 2 RPS
 6" Jun. N01°W 1520 ~~ft~~ and 14" Jun. N 85°W 10 ~~ft~~

Grate, 1972 - Set #5 SR 2 RPS: 16" June N 85 E 35¹³ & 22" Jun. S16W 183⁴⁰

Work Done By _____ Title _____ Date _____ State Registration No. or Agency _____

Plat DE Cor. Record Prepared? Yes No Filed At: _____ Co. Surveyor's Office Date _____

History of Surveys, G.L.O., etc.

1871: Post	Mansfield apparently fd in
12" Jun. S84E @ 78 ⁵ (119 L.)	1976 but doesn't say <u>what</u>
10" Jun. S42W @ 149 ⁸ (227 L.)	he found
12" Pine N27W @ 116 ⁸ (177 L.)	1972: Grate Set #5 SR on TrueLine.

RP 16" Jun. N85E 35¹³ RP 22" Jun. S16W 183⁴⁰
 Also fd. orig. CC from BTs & Set #5 SR 8.26 Ft.

Index File No. 2151 T. 16 S., R. 10 E., W.M. Contract or Surv. No. Cor. **A-21** 13

Index
File No. 0153

CORNER RECORD (SEARCH) Contract or
(Ref. FSM 7151.4) Survey No. _____

Cor.
No. C-01

T 16 S. R. 10 E. R.D. SISTERS County DESCHUTES

Merid. Willamette N.F. Deschutes State Oregon Section 6 W/4 Cor. of

CORNER DIAGRAM per legend

DESCRIBE CORNER MONUMENT FOUND

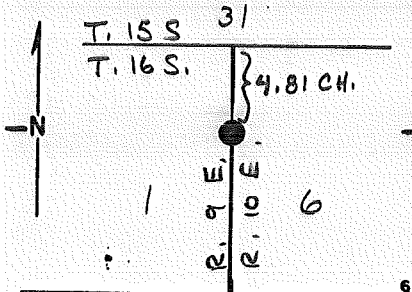

STONE MARKED $\frac{1}{4}$ 12" X 12" X 11" - WELL BEDDED.

DESCRIBE BEARING TREES OR OTHER OFFICIAL ACCESSORIES FOUND

PHOTO IDENTIFICATION DATA

Photo No. _____

Filed At. _____

Object Ident. _____

Ident. By _____

Signature

DESCRIBE CORNER LOCATION RELATIVE TO NEAR-BY FEATURES, ALSO HOW TO REACH CORNER

CORNER LEGEND:

- | | | |
|--------|------------|------------------------|
| FS or | Unverified | |
| Contr. | Other | |
| ○ | ◇ | Searched For/Not Found |
| ⊗ | ⊗ | Evidence Found/Accept. |
| ● | ◆ | Permanent Mon. Set/Fd. |

Searched By: W. MILLER

Title LS

Division ENG

Headquarters SO

Date 5-10-83

CORNER RECORD (PERPETUATION)

MONUMENT: DESCRIBE NEW MONUMENT SET, OR WORK DONE TO PRESERVE EXISTING MONUMENT

SET 2 1/2" X 30" BCSP RSG. 4" IN MOUND OF STONE
2 3/4 FT SE OF FNC. TURN POST. BURIED 1/4 STONE
AT SE. SIDE OF S.P.

MONUMENT STAMPED

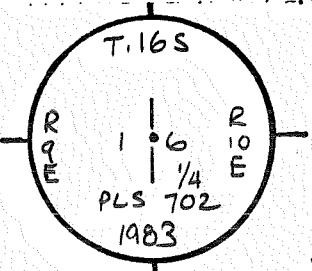

ACCESSORIES : DESCRIBE NEW BT'S WITNESS OBJECTS ETC. ESTABLISHED, OR WORK DONE TO PRESERVE EXISTING EVIDENCE

7" P. PINE N 79 1/4° W, 92.80 FT TO 60d NAIL IN S. BASE MKD E/4 S1 BT
6" P. PINE S 54° E, 69 2/3 FT TO 60d NAIL IN SW BASE, MKD W/4 S6 BT

Work Done By R. OMAN Title PLS Date 5-10-83 State Registration No. or Agency OR-702

Platted PE For Record Prepared? Yes No Filed At: _____ Co. Surveyor's Office Date _____

History of Surveys, G.L.O., etc. STONE - 12" X 10" X 10"

Index File No. 6153 T. 16 S., R. 10 E., W.M. Contract or Surv. No. _____ Cor. C-01

USDA-FOREST SERVICE

Index

File No. 0553

T 16S R. 10E

Merid. W/M

CORNER RECORD (SEARCH)

(Ref. FSM 7151.4)

R.D. SISTERS

County

DESCHUTES

N.F. DESCHUTES

State

OREGON

53-0465-3-02829

Tract or

Survey No.

Cor.

No. W 1/4

C-05

OF

SEC 5

CORNER DIAGRAM

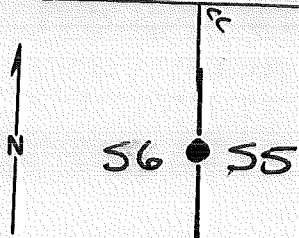

DESCRIBE CORNER MONUMENT FOUND

FOUND ORIGINAL CORNER TREE 18" PINE
SCRIBED 1/4 56 WEST FACE, 1/4 55 ON EAST
FACE

DESCRIBE BEARING TREES OR OTHER OFFICIAL ACCESSORIES FOUND

FOUND ORIG STUMP 10" BT BEARS N65°E SLKS
SCRIBED 1/4 55 BT

FOUND ~~BT~~ REMAINS OF ORIG. BT BEARS
N70°W 35LKS SCRIBED 1/4 56 BT

DESCRIBE CORNER LOCATION RELATIVE TO NEAR-BY FEATURES, ALSO HOW TO REACH CORNER

CORNER LIES SOUTH OF CLOSING CORNER
277.15 FT. IN A LOW SWELL APPROX.
400 FT SOUTH OF DIRT SPOR No. UNKNOWN

PHOTO IDENTIFICATION DATA

Photo No. _____

Filed At. _____

Object Ident. _____

Ident. By _____

Signature

PLANE COORDINATE POSITION DATA

State _____ Zone _____

X _____

Y _____

Estab. By _____

Agency

Signature

RCC

Title

PLS 1632

Division

+

Headquarters

Date

5/25/84

7100-52-(3/68)

T
CORNER RECORD (PERPETUATION)

MONUMENT: DESCRIBE NEW MONUMENT SET, OR WORK DONE TO PRESERVE EXISTING MONUMENT

SET STANDARD USFS 2 1/2 x 30" GALV PIPE & BRASS CAP
 FIRMLY IN GROUND RISING 5" ABOVE GROUND ERECTED
 STONE ~~MONUMENT~~ ^{MOUND} FLUSH WITH TOP OF BRASS CAP T16S R105E
 1/4
 36 1/2 35
 1984-9

ACCESSORIES: DESCRIBE NEW BT'S WITNESS OBJECTS ETC. ESTABLISHED, OR WORK DONE TO PRESERVE EXISTING EVIDENCE PLS 1632

SCRIBED ^{5"} 3 1/2" JUNIPER BEARS N55°W 52.88 FT SCRIBED
 1/4 S 6 BT 1" A DOUBLE BLAZE; 60d NAIL IN NE BASE.
 A ^{16"} 2 1/2" DBH PINE BEARS N53°30'E 48.43 FT SCRIBED 1/4 S 5 BT;
 60d NAIL IN SE BASE.

Work Done By RCC Title PLS 1632 Date 5/84 State Registration No. OR-1632
 or Agency
 Certified Cor. Record Prepared? Yes No Filed At DES. CO. SURV. OFFICE Date 12 JUNE 1984

REMARKS

W.E. CAMPBELL SCRIBED A PINE FOR 1/4 CORNER SCRIBED
 1/4 S 6 BT ON WEST FACE & 1/4 S 5 BT ON EAST FACE
 SCRIBED A 20" DIA. PINE BEARS N65°E 51 LKS
 A 20" DIA N70°W 35 LKS

Index File No.

0553

T.

16S

R.

R105E

M.

W1/4

Tract or Surv. No.

53-0466-3-02827 W 1/4 12

U.S. G.P.O. 1977-225-576 ^{AS} 76-0

Index File No. 1353

CORNER RECORD (SEARCH) Contract or Survey No. _____
(Ref. FSM 7151.4) Sisters County Deschutes

Cor. No. C-13

T 16 S. R. 10 E. R.D. _____

Merid. Willamette

N.F. Deschutes

County _____

State Oregon

Section 4&3 $\frac{1}{2}$ Cor. of _____

CORNER DIAGRAM per legend

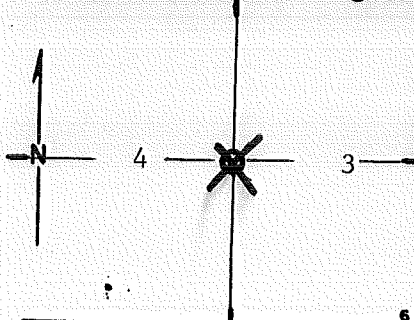

DESCRIBE CORNER MONUMENT FOUND

5/8" rebar RISING 2" above in rock mound

Did not find org. stone

DESCRIBE BEARING TREES OR OTHER OFFICIAL ACCESSORIES FOUND

PHOTO IDENTIFICATION DATA

Photo No. _____

Filed At. _____

Object Ident. _____

Ident. By _____

Signature

DESCRIBE CORNER LOCATION RELATIVE TO NEAR-BY FEATURES, ALSO HOW TO REACH CORNER

Rd 1534 out of Sisters to 1492, go left (east)

for 3 miles (Rd turns into 1139) follow

for $\frac{1}{4}$ mile, turn right (west) on spur, follow

for $\frac{1}{5}$ miles, sign board on east side of road.

(1056 Ft. west of board)

CORNER LEGEND:

FS or Unverified
 Contr. Other

Searched For/Not Found

Evidence Found/Accept.

Permanent Mon. Set/Yd.

Searched By: S.C.
C.B.

Title S.T. Division S.A.

Headquarters SQ

Date 5-17-83

CORNER RECORD (PERPETUATION)

MONUMENT: DESCRIBE NEW MONUMENT SET, OR WORK DONE TO PRESERVE EXISTING MONUMENT

MONUMENT STAMPED

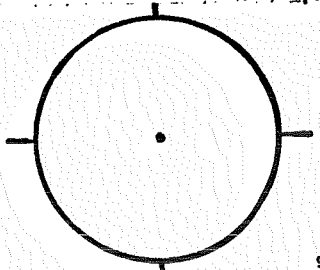

ACCESSORIES : DESCRIBE NEW BT's WITNESS OBJECTS ETC. ESTABLISHED, OR WORK DONE TO PRESERVE EXISTING EVIDENCE

Work Done By _____ Title _____ Date _____ State Registration No. _____
 or Agency _____

Plat or Certified Cor. Record Prepared? Yes No Filed At: **Co. Surveyor's Office** Date

**History
 of
 Surveys,
 G.L.O.,
 etc.**

1871" Stone 12 x 11 x 8 1969: Cook Set #5 S.R.
 RP NW 14" Pine 42.41 Feet
 RP SW 8" Juniper 12.01 Feet
 Fd. Stone Mkd. 1/4

Index File No. 1353 T. 16 S., R. 10 E., W.M. Contract or Surv. No. Cor. C-13

USDA-FOREST SERVICE D-7100-52(2/82)

Index File No. 1753 CORNER RECORD (SEARCH) Contract or Survey No. Cor. No. C-17
 (Ref. FSM 7151.4)
 T 16 S. R. 10 E. R.D. Sisters County Deschutes $\frac{1}{4}$ Cor. of
 Merid. Willamette N.F. Deschutes State Oregon Section 3&2

CORNER DIAGRAM per legend

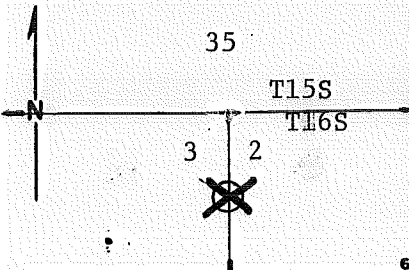

DESCRIBE CORNER MONUMENT FOUND

Stone 19" x 13" x 12" mkd. $\frac{1}{4}$ on west face

DESCRIBE BEARING TREES OR OTHER OFFICIAL ACCESSORIES FOUND

Corner Falls in Rd. Stone 10' east of point.
 Tag on tree.
 Ground flat and good shape. Juniper and pine Forest.

PHOTO IDENTIFICATION DATA

Photo No.
 Filed At.
 Object Ident.
 Ident. By
Signature

DESCRIBE CORNER LOCATION RELATIVE TO NEAR-BY FEATURES, ALSO HOW TO REACH CORNER

Rd 1000 east from Sisters appx. 5⁰ miles,
 take spur on left of Rd. 1000, Rd runs parallel
 to 1000. Sign board on east side of Rd. (Fence corner).

CORNER LEGEND:

- FS or Unverified
- Contr. Other
- Searched For/Not Found
- Evidence Found/Accept.
- Permanent Mon. Set/Fd.

Searched By: S.C. C.B. Title S.T. Division Headquarters SO Date 5-19-83
S.A. Survey

CORNER RECORD (PERPETUATION)

MONUMENT: DESCRIBE NEW MONUMENT SET, OR WORK DONE TO PRESERVE EXISTING MONUMENT

MONUMENT STAMPED

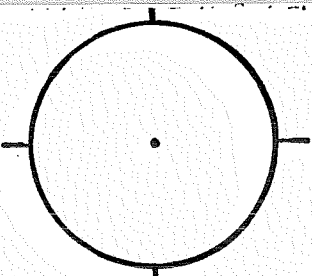

ACCESSORIES : DESCRIBE NEW BT'S WITNESS OBJECTS ETC. ESTABLISHED, OR WORK DONE TO PRESERVE EXISTING EVIDENCE

Work Done By _____ Title _____ Date _____ State Registration No. _____
or Agency _____

Plat of _____
Certified Cor. Record Prepared? Yes No Filed At: _____ Co. Surveyor's Office Date _____

History of Surveys, G.L.O., etc.
1871: Stone 18 x 12 x 8

Index File No. 1753 T. 16 S., R. 10 E., W.M. Contract or Surv. No. _____ Cor. C-17

9

10

11

12

13

Index File No. 0155

CORNER RECORD (SEARCH) Contract or
(Ref. FSM 7151.4) Survey N^o.

Cor. No. E-01

T 16 S. R. 10 E.

R.D. SISTERS

County DES.

SW

Cor. of

Merid. Willamette

N.F. Deschutes

State Oregon

Section 6

CORNER DIAGRAM per Legend

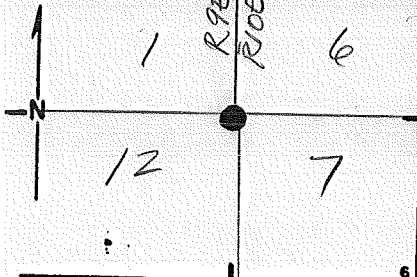

DESCRIBE CORNER MONUMENT FOUND

STONE - PLANTED 16" X 10"
RISING 7" 1 CHISEL MARK ON NW EDGE

DESCRIBE BEARING TREES OR OTHER OFFICIAL ACCESSORIES FOUND

DOWN AND ROTTING LOG - BLAZE T  E.S.
IN LOCATION N 64° E @ 140 - TAGGED W/OLD F.S. TAG

PHOTO IDENTIFICATION DATA

Photo No. _____

Filed At. _____

Object Ident. _____

Ident. By _____

Signature

DESCRIBE CORNER LOCATION RELATIVE TO NEAR-BY FEATURES, ALSO HOW TO REACH CORNER

LOCATION SIGN (BROOKS-SCANLON)
GO TO RD # 1648 - TURN LEFT - GO 0.1 MI. TAKE SPUR LEFT
AT JUNCTION OF 1648 E - PROCEED 0.2 MI. PUT LOCATION POST-
ER ON B-S LINE POST.

CORNER LEGEND:

- | | | |
|----------------------------------|-------------------------------------|------------------------|
| FS or | Unverified | |
| Contr. | Other | |
| <input type="radio"/> | <input type="checkbox"/> | Searched For/Not Found |
| <input checked="" type="radio"/> | <input checked="" type="checkbox"/> | Evidence Found/Accept. |
| <input checked="" type="radio"/> | <input checked="" type="checkbox"/> | Permanent Mon. Set/Fd. |

Searched By: W. MILLER

Title LS

Division ENG

Headquarters 50

Date 4-29-83

CORNER RECORD (PERPETUATION)

MONUMENT: DESCRIBE NEW MONUMENT SET, OR WORK DONE TO PRESERVE EXISTING MONUMENT

SET 2 1/2" X 30" BCSP IN PLACE OF STONE (CENTROID) RSG. 5"
 AND TILTED VERY SLIGHTLY SOUTH IN MOUND OF STONE
 BURIED ORG. STONE

MONUMENT STAMPED

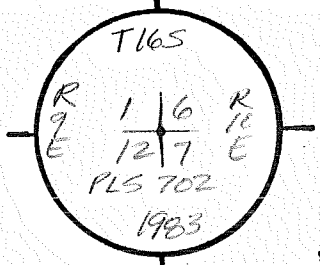

ACCESSORIES : DESCRIBE NEW BT'S WITNESS OBJECTS ETC. ESTABLISHED, OR WORK DONE TO PRESERVE EXISTING EVIDENCE

3" P. PINE - N 81 1/2° E @ 42¹⁵ FT - SCRIBED (X BT) 60D NAIL IN S. BASE
 5" P. PINE - S 05³/4° E @ 19⁸⁸ FT - " (T16SRIDE 5 BT) " " " ENE "
 6" P. PINE - S 54° W @ 4³² FT. - " (T16SR 9E S12 BT) " " " SE "
 5" P. PINE - N 20° W @ 25⁶² FT - " (T16SR 9E S1 BT) " " " W "

Work Done By _____ Title _____ Date 5-9-83 State Registration No. _____
 or Agency _____
 Certified Cor. Record Prepared? Yes No Filed At: _____ Co. Surveyor's Office Date _____

History of Surveys, G.L.O., etc.
STONE - 16 X 7 X 7
14" PINE - N 65° E @ 125

Index File No. D155 T. 16 S., R. 10 E., W.M. Contract or Surv. No. _____ Cor. ED1

5
USDA-FOREST SERVICE

Index

File No. _____

CORNER RECORD (SEARCH)

(Ref. FSM 7151.4)

Tract or Survey No. _____

Cor. No. E-17

T 16 S. R. 10 E.

R.D. Sisters

County Deschutes

Cor. of Sec. Sec.

Merid. WILLAMETTE

N.F. DESCHUTES

State OREGON

Cor. of Sec. Car. of Sec.

CORNER DIAGRAM

DESCRIBE CORNER MONUMENT FOUND

Original Stone and 5/8" x 30" s.p. (15" x 10" x 6")

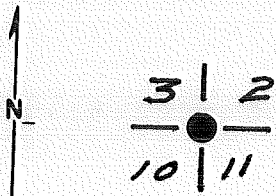

DESCRIBE BEARING TREES OR OTHER OFFICIAL ACCESSORIES FOUND

Old BT Stump bears S 39° W 23.9'

PHOTO IDENTIFICATION DATA

Photo No. _____

Filed At. _____

Object Ident. _____

Ident. By _____

Signature _____

PLANE COORDINATE POSITION DATA

State _____ Zone _____

X _____

Y _____

Estab. By _____

Agency _____

DESCRIBE CORNER LOCATION RELATIVE TO NEAR-BY FEATURES, ALSO HOW TO REACH CORNER

From intersection of U.S.F.S. Rds. #1585 and 1139; southerly on 1139 1.3 miles; ~~#442~~ S 44° W 350' ± up draw to corner. Location posted on tree - West side of road

Signature _____

Title _____

Division _____

Headquarters _____

Date _____

D-7100-52 (10/78)

3/82

PLS 1020

CORNER RECORD (PERPETUATION)

MONUMENT: DESCRIBE NEW MONUMENT SET, OR WORK DONE TO PRESERVE EXISTING MONUMENT

*Set a 2" x 30" iron pipe w/brass cap marked.
Buried original stone alongside.*

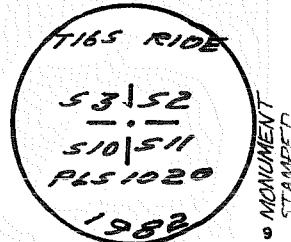

ACCESSORIES DESCRIBE NEW BT'S WITNESS OBJECTS ETC. ESTABLISHED, OR WORK DONE TO PRESERVE EXISTING EVIDENCE

8"	Pond. Pine brs.	N 38° E	18 98'	scribed "T165 RIDE S 2 BT"	60 P SPIKE IN NW BASE W/BRASS WASHER
"	"	"	5 78° E 16 37'	"	"T165 RIDE S 11 BT"
1 1/4"	Juniper	"	S 24° W 32 12'	"	60 P SPIKE IN NE BASE
8"	Pond. Pine brs.	N 76° W	28 67'	"	"T165 RIDE S 3 BT"
					60 P SPIKE IN WEST BASE
					60 P SPIKE IN S. BASE

NOTE: ALL SPIKES HAVE A BRASS
WASHER W/PLS 1020 10

Work Done By *Angelo...* Title *Surveyor* Date *3/82* State Registration No. *ORLS 1020* or Agency

Certified Cor. Record Prepared? Filed At *Des. Co. Surv. office* Date *3/82* 11

REMARKS

Index
File No. E-19

①

T 16 S. R. 10 E.

CORNER RECORD (SEARCH) Contract or
(Ref. FSM 7151.4) Survey No.

Cor. No. 1955

Merid. Willamette

R.D. SISTERS

County DESCHUTES

1/4 Cor. of
Section 2

CORNER DIAGRAM, per legend

N.F. Deschutes

State Oregon

DESCRIBE CORNER MONUMENT FOUND

FD. 2" I.P. W/2" BRASS CAP. RSGO. 7 FT. IN A ROCK
MOUND. CARB. POST 2.5 FT NORTH W/LSM

DESCRIBE BEARING TREES OR OTHER OFFICIAL ACCESSORIES FOUND

7" JUN. - N56°W - 41.72 FT. (1/4 S2 BT)
8" JUN. - S34°W - 11.20 FT. (1/4 S11 BT)

BT'S HAVE NAIL & WASHER "PLS 102G" SIDE CENTER

DESCRIBE CORNER LOCATION RELATIVE TO NEAR-BY FEATURES, ALSO HOW TO REACH CORNER

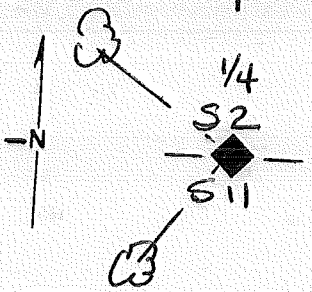

PHOTO IDENTIFICATION DATA

Photo No. _____
Filed At. _____
Object Ident. _____
Ident. By _____
Signature _____

CORNER LEGEND:

- FS or Unverified
- Contr. Other
- Searched For/Not Found
- ◇ Searched For/Not Found
- ⊗ Evidence Found/Accept.
- ⊗ Evidence Found/Accept.
- Permanent Mon. Set/Fd.
- ◆ Permanent Mon. Set/Fd.

Searched By: FAST

Title PLS

Division

Headquarters

Date 7/87

CORNER RECORD (PERPETUATION)

MONUMENT. DESCRIBE NEW MONUMENT SET, OR WORK DONE TO PRESERVE EXISTING MONUMENT

MONUMENT STAMPE

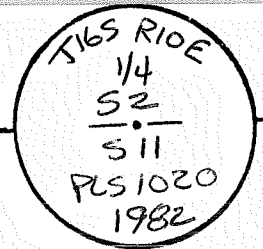

ACCESSORIES. DESCRIBE NEW BT'S WITNESS OBJECTS ETC. ESTABLISHED, OR WORK DONE TO PRESERVE EXISTING EVIDENCE

Work Done By FAST Title P.L.S Date _____ State Registration No. PLS 1938
or Agency _____

Plat DE FAST For Record Prepared? Yes No Filed At DESH-Co. Surveyor's Office Date _____

History of Surveys, G.L.O., etc. G.L.O BY G. NEWMAN, CONTRACT # 141, APPROVED 8/13/1870

Index File No. E-19 T. 16S., R. 10 E., W.M. Contract or Surv. No _____ Cor. _____

Index
File No. E-21

T 16 S. R. 10 E.

Merid. Willamette

CORNER RECORD (SEARCH) Contract or
(Ref. FSM 7151.4) Survey No.

R.D. SISTERS

County DESCHUTES

Cor. No. 2155

N.F. Deschutes

State Oregon

Nw Cor. of
Section 12

CORNER DIAGRAM, per legend

DESCRIBE CORNER MONUMENT FOUND

FD 2 "IP. w/2" BRASS CAP, RØG 0.3 FT IN A ROCK
COLLAR. CAR. Post 4.0 FT SOUTH w/LSM

DESCRIBE BEARING TREES OR OTHER OFFICIAL ACCESSORIES FOUND

10" P. PINE - N35°W - 47.06 FT FACE GROWN OVER I
11" JUN. - S65°W - 25.86 FT (TIGS RIDE S11 BT) BT'S HAVE NAIL & WASHERS
17" JUN. - S54°E - 38.57 FT (TIGS RIDE S12 BT) PLS 1020" SIDE CENTER
ORIG BT - 30" PINE DOWN & DEAD - S65°E - 44.1 FT
9" JUN. - N76°E - 64.92 FT. (TIGS RIDE S1 BT)

DESCRIBE CORNER LOCATION RELATIVE TO NEAR-BY FEATURES, ALSO HOW TO REACH CORNER

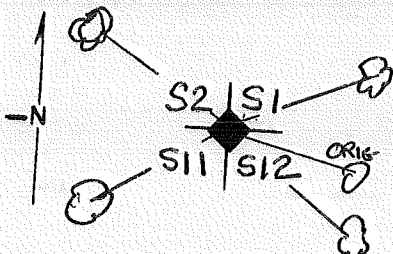

PHOTO IDENTIFICATION DATA

Photo No. _____
Filed At. _____
Object Ident. _____
Ident. By _____

Signature _____

CORNER LEGEND:

- | | | |
|---------|------------|------------------------|
| PS or | Unverified | |
| Constr. | Other | |
| ○ | ◇ | Searched For/Not Found |
| ⊗ | ⊗ | Evidence Found/Accept. |
| ● | ◆ | Permanent Mon. Set/Fd. |

Searched By: FAST

Title PLS

Division _____

Headquarters _____

Date 7/89

CORNER RECORD (PERPETUATION)

MONUMENT. DESCRIBE NEW MONUMENT SET, OR WORK DONE TO PRESERVE EXISTING MONUMENT

SET GALV. POST 5.0 FT SOUTH W/PB
SET GALV. POST 3.0 FT WEST W/LSM & PB

MONUMENT STAMPED

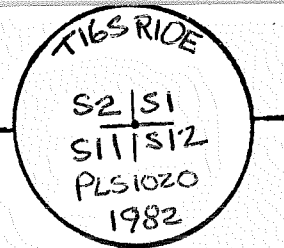

ACCESSORIES DESCRIBE NEW BT'S WITNESS OBJECTS ETC. ESTABLISHED, OR WORK DONE TO PRESERVE EXISTING EVIDENCE

Work Done By F.A.S.T. Title P.L.S. Date _____ State Registration No. PLS1938
or Agency _____
Elected Cor Record Prepared? Yes No Filed At BESCH. Co. Surveyor's Office Date _____

History of Surveys, G.L.O., etc. G.L.O BY G. NEWMAN, CONTRACT # 141, APPROVED 8/13/1870

Index File No.

E-21

T.16 S., R.10 E., W.M.

Contract or Surv. No

Cor.

Index
File No. E-22

CORNER RECORD (SEARCH) Contract or
(Ref. FSM 7151.4) Survey No.

T 16 S. R. 10 E.

R.D. SISTERS

County DESCHUTES

Cor. No. 2255

Merid. Willamette

N.F. Deschutes

State Oregon

W 1/16 Cor. of
Section 12

CORNER DIAGRAM per legend

DESCRIBE CORNER MONUMENT FOUND

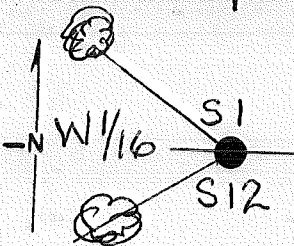

FD. 5/8" I.R. w/YELLOW CAP "PLS 1078", RSG. 0.4 FT.

DESCRIBE BEARING TREES OR OTHER OFFICIAL ACCESSORIES FOUND

19" JUN. - N 52° W - 15.49 FT.

11" JUN. - S 54° W - 8.08 FT.

RP'S HAVE SMALL FINISH NAIL w/BRASS WASHER "LS 1078" @ SIDE CENTER

DESCRIBE CORNER LOCATION RELATIVE TO NEAR-BY FEATURES, ALSO HOW TO REACH CORNER

PHOTO IDENTIFICATION DATA

Photo No. _____
Filed At. _____
Object Ident. _____
Ident. By _____

Signature

CORNER LEGEND:

- FS or Unverified
- Contr. Other
- Searched For/Not Found
- Evidence Found/Accept.
- Permanent Mon. Set/Yd.

Searched By: FAST

Title PLS

Division

Headquarters

Date 7/89

CORNER RECORD (PERPETUATION)

MONUMENT. DESCRIBE NEW MONUMENT SET, OR WORK DONE TO PRESERVE EXISTING MONUMENT

SET A 2 1/2" x 30" I.P. w/ 2 1/2" BRASS CAP, RSG. 1.8 FT. IN
 A ROCK MOUND. SET GALV. POST 4.0 FT EAST w/ LSH & PB
 AND SET POST 2.5 FT. SOUTH w/ PB.
 PLACED 5/8" I.R. INSIDE I.P.

MONUMENT STAMPED

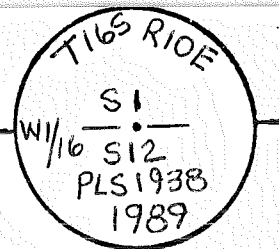

ACCESSORIES DESCRIBE NEW BT'S WITNESS OBJECTS ETC. ESTABLISHED, OR WORK DONE TO PRESERVE EXISTING EVIDENCE

REFERENCE TREES:

19" JUNIPER - N 52° W, 15.5
 11" JUNIPER - S 54° W, 8.1

REFERENCE MONUMENT:

1" x 24" IRON ROD - N 44° E, 8.70'

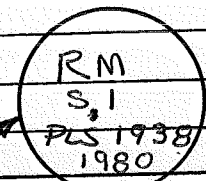

Work Done By F. AST Title PLS. Date _____ State Registration No. PLS 1938
 or Agency _____

Flat or Record Prepared? Yes No Filed At DESCH. Co. Surveyor's Office Date _____

History
 of
 Surveys,
 G.L.O.,
 etc.

Index File No. T. 16S., R. 10E., W.M. Contract or Surv. No. _____ Cor. _____

E-22

9

10

11

12

13

INDEX SERVICE D-7100-52(4/82)

Index File No. E-23

CORNER RECORD (SEARCH) Contract or Survey No.
(Ref. FSM 7151.4)

Cor. No. 2355 4

T 16 S. R. 10 E. R.D. SISTERS County DESCHUTES N 1/4 Cor. of
Merid. Willamette N.F. Deschutes State Oregon Section 12

CORNER DIAGRAM per Legend

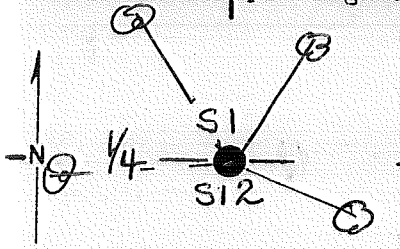

DESCRIBE CORNER MONUMENT FOUND

FD. 5/8" IR., RSG. 0.6 FT.

FD. ORIG. 16" x 12" x 11" STONE w/ 1/4 VIS.

DESCRIBE BEARING TREES OR OTHER OFFICIAL ACCESSORIES FOUND 2

PHOTO IDENTIFICATION DATA

Photo No.
Filed At.
Object Ident.
Ident. By
Signature

DESCRIBE CORNER LOCATION RELATIVE TO NEAR-BY FEATURES, ALSO HOW TO REACH CORNER 3

CORNER LEGEND:

- FS or Unverified
- Contr. Other
- Searched For/Not Found
- ⊗ Evidence Found/Accept.
- Permanent Mon. Set/Pd.

Searched By: FAST

Title P.L.S.

Division

Headquarters

Date 7/89

CORNER RECORD (PERPETUATION)

MONUMENT STAMPED

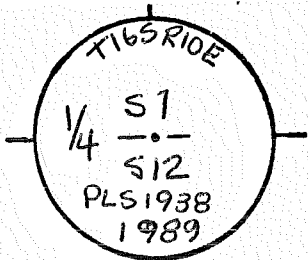

MONUMENT. DESCRIBE NEW MONUMENT SET, OR WORK DONE TO PRESERVE EXISTING MONUMENT

SET 2 1/2" x 30" I.P. w/ 1/2" BRASS CAP, RSG. 0-7 FT. IN A
 MOUND OF STONE. BURIED ORIG. STONE ON WEST SIDE OF
 MONUMENT. PLACED 5/8" IR. INSIDE IRON PIPE.
 SET GALV. POST 3.0 FT. WEST W/ 2 1/2" x 30" I.P.

ACCESSORIES DESCRIBE NEW BT'S WITNESS OBJECTS ETC. ESTABLISHED, OR WORK DONE TO PRESERVE EXISTING EVIDENCE

11" JUNIPER RP. - N 30° W - 55.43 FT. ALUM NAIL & BRASS WASHER 'PLS 1938' SIDE CENTER
 11" JUNIPER - RP. - N 82° W - 30.10 FT. ALUM. NAIL & BRASS WASHER 'PLS 1938' SIDE CENTER
 8" JUNIPER - N 33° E - 50.10 FT. (1/4 S1 BOT) ALUM NAIL & BRASS WASHER 'PLS 1938'
 7" JUNIPER - S 73° E - 16.40 FT. (1/4 S12 BOT) OFFFACE BETWEEN BOT.

Work Done By F. AST Title PLS Date _____ State Registration No. PLS 1938
 or Agency _____

Platted or Record Prepared? Yes No Filed At DESCH. Co. Surveyor's Office Date _____

History of Surveys, G.L.O., etc. G.L.O. BY G. NEWMAN, CONTRACT # 141, APPROVED 8/13/1870

Index File No. T. 16 S., R. 10 E., W.M. Contract or Surv. No. _____ Cor. _____

5

USDA-FOREST SERVICE D-7100-52(2/82)

Index
File No. E-24

CORNER RECORD (SEARCH) Contract or
(Ref. FSM 7151.4) Survey No.

Cor.
No. 2455

T 16 S. R. 10 E. R.D. SISTERS

County DESCHUTES

Merid. Willamette

N.F. Deschutes

State Oregon

E 1/16 Cor. of
Section 12

CORNER DIAGRAM, per Legend

DESCRIBE CORNER MONUMENT FOUND

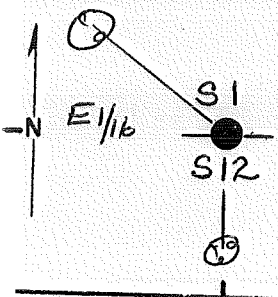

FD. 5/8" I.R. w/ YELLOW CAP PLS 1938 "

DESCRIBE BEARING TREES OR OTHER OFFICIAL ACCESSORIES FOUND

PHOTO IDENTIFICATION DATA

Photo No. _____
Filed At. _____
Object Ident. _____
Ident. By _____
Signature

DESCRIBE CORNER LOCATION RELATIVE TO NEAR-BY FEATURES, ALSO HOW TO REACH CORNER

CORNER LEGEND:

- FS or Unverified
- Contr. Other
- ◇ Searched For/Not Found
- ⊗ ⊗ Evidence Found/Accept.
- ◆ Permanent Mon. Set/Fd.

Searched By: FAST

Title
PLS

Division

Headquarters

Date 7/89

CORNER RECORD (PERPETUATION)

MONUMENT: DESCRIBE NEW MONUMENT SET, OR WORK DONE TO PRESERVE EXISTING MONUMENT

SET 2 1/2" I.P. W/ 2 1/2" BRASS CAP, RSG. 1.2 FT. IN A MOUND OF STONE. PLACED 5/8" IR. INSIDE 2 1/2" PIPE.
SET GALV. POST 4.0 FT. EAST W/LSH & PA

MONUMENT STAMPED

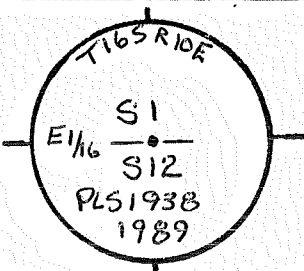

ACCESSORIES DESCRIBE NEW BT'S WITNESS OBJECTS ETC. ESTABLISHED, OR WORK DONE TO PRESERVE EXISTING EVIDENCE

5" JUN. - N40°W - 38.00 FT. (E 1/16 S1 B.T.)
3" JUN. - SOUTH. - 27.55 FT. (E 1/16 S12 B.T.)
BOTH BT'S HAVE ALUM. NAIL & BRASS WASHER PLS1938 "BETWEEN B.T.

Work Done By: F. AST Title: P.L.S. Date: _____ State Registration No. PLS1938
or Agency _____

Plat or Cor. Record Prepared? Yes No Filed At DESCH, Co. Surveyor's Office Date _____

History of Surveys, G.L.O., etc.

Index File No. E-24 T. 16 S., R. 10 E., W.M. Contract or Surv. No. _____ Cor. _____

Index
File No. E-25

CORNER RECORD (SEARCH) Contract or
(Ref. FSM 7151.4) Survey No.

T 16 S. R. 10 E.

R.D. SISTERS

County DESCHUTES

Cor. No. 2555

Merid. Willamette

N.F. Deschutes

State Oregon

NE Cor. of
Section 12

CORNER DIAGRAM, per Legend

DESCRIBE CORNER MONUMENT FOUND

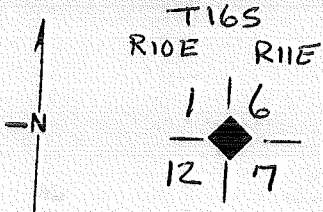

1
FD. 1" GALV. PIPE W/ 2" BRASS CAP, RSG. 0.2 FT IN A
SMALL ROCK COLLAR

DESCRIBE BEARING TREES OR OTHER OFFICIAL ACCESSORIES FOUND

2
11" JUN - N88°E - 24.88 FT. (NO SCRIB VIS.) I
46" DOUBLE JUN - S53°E - 74.00 FT. (S) I (SCRIB VIS.)
3
BOTH BT'S HAUG SPIKE AT SIDE CENTER.

DESCRIBE CORNER LOCATION RELATIVE TO NEAR-BY FEATURES, ALSO HOW TO REACH CORNER

PHOTO IDENTIFICATION DATA

Photo No. _____
Filed At. _____
Object Ident. _____
Ident. By _____

Signature

CORNER LEGEND:

- | | | |
|--------------|------------|------------------------|
| FS or Contr. | Unverified | Other |
| ○ | ◇ | Searched For/Not Found |
| ⊗ | ⊗ | Evidence Found/Accept. |
| ● | ◆ | Permanent Mon. Set/Pd. |

Searched By: F.AST

Title PLS

Division

Headquarters

Date 7/89

CORNER RECORD (PERPETUATION)

MONUMENT. DESCRIBE NEW MONUMENT SET, OR WORK DONE TO PRESERVE EXISTING MONUMENT

SET GALV. POST 3.0 FT. SOUTH W/LSM & PB

SET GALV. POST 5.0 FT. WEST W/PB

MONUMENT STAMPED

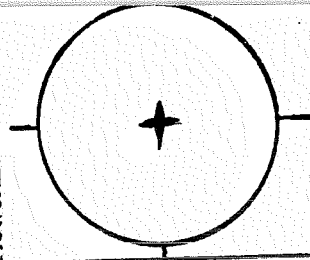

ACCESSORIES. DESCRIBE NEW BT'S WITNESS OBJECTS ETC. ESTABLISHED, OR WORK DONE TO PRESERVE EXISTING EVIDENCE

Work Done By FAST Title PLS Date _____ State Registration No. PLS 1938
or Agency _____

Flat or Record Prepared Yes No Filed At DESCH. Co. Surveyor's Office Date _____

History of Surveys, G.L.O., etc. G.L.O BY G. NEWMAN, CONTRACT # 141, APPROVED 8/13/1870

Index File No. E-25 T. 16 S., R. 10 E., W.M. Contract or Surv. No _____ Cor. _____

Index File No. F-21

CORNER RECORD (SEARCH) Contract or Survey No. _____
(Ref. FSM 7151.4)

Cor. No. 2156

T 16 S. R. 10 E. R.D. SISTERS County DESCHUTES N 1/16 Cor. of
Merid. Willamette N.F. Deschutes State Oregon Section 12

CORNER DIAGRAM, per legend

DESCRIBE CORNER MONUMENT FOUND

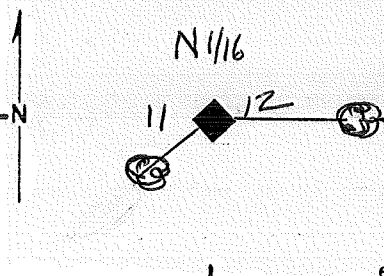

FD. 2 1/2" I.P. w/ 2 1/2" BRASS CAP, RSG. 0-2 FT.

DESCRIBE BEARING TREES OR OTHER OFFICIAL ACCESSORIES FOUND

12" P. PINE - N 45° E - 14.33 FT NO SCRIB UIS.

10" JUN. - WEST - 48.35 FT. NO SCRIB UIS.

PHOTO IDENTIFICATION DATA

Photo No. _____
Filed At. _____
Object Ident. _____
Ident. By _____
Signature

DESCRIBE CORNER LOCATION RELATIVE TO NEAR-BY FEATURES, ALSO HOW TO REACH CORNER

CORNER LEGEND:

- FS or Unverified
- Constr. Other
- Searched For/Not Found
- ◇ Searched For/Not Found
- ⊗ Evidence Found/Accept.
- ⊗ Evidence Found/Accept.
- Permanent Mon. Set/Pd.
- ◆ Permanent Mon. Set/Pd.

Searched By: F. AST

Title P.L.S

Division _____

Headquarters _____

Date 7/89

CORNER RECORD (PERPETUATION)

MONUMENT. DESCRIBE NEW MONUMENT SET, OR WORK DONE TO PRESERVE EXISTING MONUMENT

SET GALV. POST 8.0 FT. EAST W/PB

SET GALV. POST 6.0 FT. NORTH W/PB & LSH

MONUMENT STAMPED

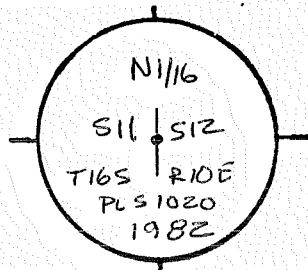

ACCESSORIES DESCRIBE NEW BT'S WITNESS OBJECTS ETC. ESTABLISHED, OR WORK DONE TO PRESERVE EXISTING EVIDENCE

Work Done By F. AST Title P. L. S. Date _____ State Registration No. PLS 1938
or Agency _____

Plat or Cor. Record Prepared Yes No Filed At DESCH. Co. Surveyor's Office Date _____

History of Surveys, G.L.O., etc.

Index File No. F-21 T. S., R. E., W.M. Contract or Surv. No. Cor. _____

Index
File No. F-22

CORNER RECORD (SEARCH) Contract or

(Ref. FSM 7151.4)

Survey No.

Cor. No. 2256

T 16 S. R. 10 E. Merid. Willamette

R.D. SISTERS

County DESCHUTES

Nw 1/16 Cor. of

N.F. Deschutes

State Oregon

Section 12

CORNER DIAGRAM per legend

DESCRIBE CORNER MONUMENT FOUND

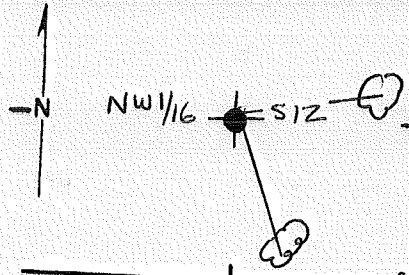

DESCRIBE BEARING TREES OR OTHER OFFICIAL ACCESSORIES FOUND

PHOTO IDENTIFICATION DATA

Photo No. _____
 Filed At _____
 Object Ident. _____
 Ident. By _____
 Signature _____

DESCRIBE CORNER LOCATION RELATIVE TO NEAR-BY FEATURES, ALSO HOW TO REACH CORNER

CORNER LEGEND:

- FS or Unverified
- Constr. Other
- ◇ Searched For/Not Found
- ⊗ ⊗ Evidence Found/Accept.
- ◆ Permanent Mon. Set/Pd.

Searched By: F.AST

Title PLS

Division

Headquarters

Date 7/89

CORNER RECORD (PERPETUATION)

MONUMENT. DESCRIBE NEW MONUMENT SET, OR WORK DONE TO PRESERVE EXISTING MONUMENT

SET A 2 1/2" x 30" I.P. W/ 2 1/2" BRASS CAP, RSG. 1.5 FT IN A
STONE MOUND. SET GALV. POST 3.0 FT. NORTH w/ LSM & PB
SET GALV. POST 3.0 FT. WEST w/ PB

MONUMENT STAMPED

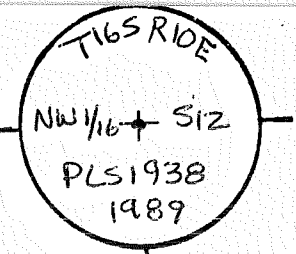

9

ACCESSORIES DESCRIBE NEW BT'S WITNESS OBJECTS ETC. ESTABLISHED, OR WORK DONE TO PRESERVE EXISTING EVIDENCE

18" P. PINE - N85°E - 41.20 FT. (NW 1/16 S12 B.T)

8" JUN. - S27°E - 39.0 FT. (NW 1/16 S12 B.T)

(BT'S HAVE ALUM. NAIL & BRASS WASHER) PLS 1938 "BETWEEN B.T")

10

Work Done By F. AST Title PLS Date _____ State Registration No. PLS 1938
or Agency _____

Platted or Record Prepared? No Filed At DESCH. Co. Surveyor's Office Date _____

11

History
of
Surveys,
G.L.O.,
etc.

12

Index File No.

F-22

T. 16 S., R. 10 E., W.M.

Contract or Surv. No

Cor.

13

USDA-FOREST SERVICE

Index File No. 41-57

CORNER RECORD (SEARCH)

(Ref. FSM 7151.4)

53-0464-3-0287 G-01

Tract or Survey No. _____ Cor. No. W 1/4

T 165 R. 10E

R.D. SISTERS County DESCHUTES 57

Merid. WM

N.F. DESCHUTES State ORE.

CORNER DIAGRAM

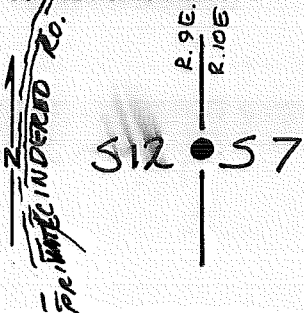

DESCRIBE CORNER MONUMENT FOUND

NONE

DESCRIBE BEARING TREES OR OTHER OFFICIAL ACCESSORIES FOUND

NONE

PHOTO IDENTIFICATION DATA

Photo No. _____
Filed At. _____
Object Ident. _____
Ident. By _____
Signature

DESCRIBE CORNER LOCATION RELATIVE TO NEAR-BY FEATURES, ALSO HOW TO REACH CORNER

CORNER LIES EAST OF CINDERED RD.
75' ± CINDERED RD. IS A SPUR OFF RD.
No. 1620

PLANE COORDINATE POSITION DATA

State _____ Zone _____
X _____
Y _____
Estab. By _____
Agency

Signature RCC

Title PLS 1632

Division +

Headquarters

Date 5/25/84

7100-52-(3/68)

T
CORNER RECORD (PERPETUATION)

MONUMENT: DESCRIBE NEW MONUMENT SET, OR WORK DONE TO PRESERVE EXISTING MONUMENT

SET A STANDARD USFS 2 1/2" X 30" GALV PIPE & BRASS CAP
FIRMLY IN GROUND RISING 4" ABOVE NATURAL GROUND
ERECTED STONE ~~BT'S~~ ^{MOUND} AROUND MONUMENT.

T163
PAGE 10E
1/4

SIZ: 57 9

ACCESSORIES: DESCRIBE NEW BT'S WITNESS OBJECTS ETC. ESTABLISHED, OR WORK DONE TO PRESERVE EXISTING EVIDENCE 1984

PLS 1632

A 18" DBH P. PINE BEARS N 57° 30' W 24.95 FT SCRIBED
"1/4 5 12 BT." ; 60d NAIL IN SW BASE.
A 8" DBH P. PINE BEARS N 54° E 40.16 FT SCRIBED
"1/4 5 7 BT." ; 60d NAIL IN SE BASE.

10

Work Done By: RCC Title PLS 1632 Date 5/84 State Registration No. OR-1632
or Agency

Certified Cor. Record Prepared? Yes No Filed At: DES. CO. SURV. OFFICE Date 12 June 1984

REMARKS

GEO. W. NEWMAN IN 1871 SET A STONE 15 X 14 X 5
NO BT'S

53-0466-3-02829 W 1/4 12

Index File No. 0157 T. 16S R. 10 M. WM

Tract or Surv. No. Cor. 13
U.S. G.P.O. 1977-725-576-186

USDA-FOREST SERVICE

Index File No. 0957

CORNER RECORD (SEARCH)
(Ref. FSM 7151.4)

Tract or Survey No. _____

Cor. No. G-09

T 16S R. 10E

R.D. SISTERS

County DESCHUTES

Merid. WMT

N.F. Des.

State OR

W 1/4 S. 9

CORNER DIAGRAM

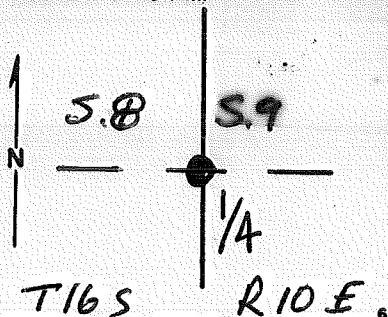

DESCRIBE CORNER MONUMENT FOUND

FOUND 5/8" IRON PIN AS PER RECORDED SURVEY NO. 0144Z
FITS ORIGINAL G.L.O. B.T. STUMPS AND LINE TREE

DESCRIBE BEARING TREES OR OTHER OFFICIAL ACCESSORIES FOUND

DESCRIBE CORNER LOCATION RELATIVE TO NEAR-BY FEATURES, ALSO HOW TO REACH CORNER

PHOTO IDENTIFICATION DATA

Photo No. _____

Filed At. _____

Object Ident. _____

Ident. By _____

Signature _____

PLANE COORDINATE POSITION DATA

State _____ Zone _____

X _____

Y _____

Estab. By _____

Agency _____

Signature

Don Gresdel

Title

PLS

Division

Headquarters

Date

6/02

FS-7100-52 (3/68)

CORNER RECORD (PERPETUATION)

MONUMENT: DESCRIBE NEW MONUMENT SET, OR WORK DONE TO PRESERVE EXISTING MONUMENT

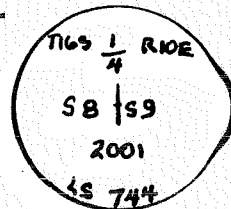

REPLACED 5/8" IRON PIN WITH 2" GALVANIZED IRON PIPE WITH 2 1/2" BRASS CAP
SCRIBED NEW BEARING TREES AS FOLLOWS:

11" YELLOW PINE BEARS	S49°31'E, 14 1/2 FT.	SCRIBED	1/4 SB BT
7" " " "	N33°50'W, 33 1/2 FT.	"	X BT
8" JUNIPER	S20°53'W, 42 1/2 FT.	"	1/4 S9 BT
11" " "	S74°32'W, 23 1/2 FT.	"	X BT

ACCI

ME TO PRESERVE EXISTING EVIDENCE

MEASUREMENTS TO CENTER OF TREE AT ROOT CROWN.
A BRASS DISC STAMPED "LS 744" IS NAILED IN LOWER BLAZE.

Work Done By Don Gredel Title PLS Date 6/02 State Registration No. 744
or Agency

Certified Cor. Record Prepared? Yes No Filed At: Des. Co. Date

REMARKS

G.L.O. 1902 WILLIAM E. AND C.L. CAMPBELL
DESCHUTES CO. RECORDED SURVEY NO. 01442

Index File No. T. R. M. Tract or Surv. No. Cor.

0957

GPO: 1986 O - 439-095

G-09

File No. G-17

T 16 S. R. 10 E.

Merid. Willamette

R.D. SISTERS

N.F. Deschutes

CORNER RECORD (SEARCH) Contract or Survey No.

(Ref. FSM 7151.4)

County DESCHUTES

State Oregon

Cor. No. 1757

w 1/4 Cor. of Section 11

CORNER DIAGRAM, per legend

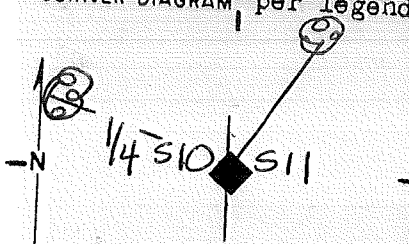

DESCRIBE CORNER MONUMENT FOUND

FD. A 2 1/2" I.P. w/ 2 1/2" BRASS CAP. RSG. 0.5 FT.
FD CARBONITE POST 4.0 FT. SOUTH w/ L SM

DESCRIBE BEARING TREES OR OTHER OFFICIAL ACCESSORIES FOUND

10" JUN. - N73°W - 15.77 FT. SCRIB. VIS (1/4 S10 BT)
19" JUN. - N34°E - 18.09 FT. SCRIB. VIS (1/4 S11 BT)
BOTH BT'S HAVE SPIKE & BRASS WASHER "LS 1020" AT SIDE CENTER

DESCRIBE CORNER LOCATION RELATIVE TO NEAR-BY FEATURES, ALSO HOW TO REACH CORNER

PHOTO IDENTIFICATION DATA

Photo No. _____
Filed At. _____
Object Ident. _____
Ident. By _____

Signature

CORNER LEGEND:

- | | |
|----------------------------------|--|
| FS or | Unverified |
| Coatr. | Other |
| <input type="radio"/> | <input type="checkbox"/> Searched For/Not Found |
| <input checked="" type="radio"/> | <input checked="" type="checkbox"/> Evidence Found/Accept. |
| <input type="radio"/> | <input checked="" type="checkbox"/> Permanent Mon. Set/Pd. |

Searched By: FAST

Title P.L.S. Division

Headquarters

Date 7/89

CORNER RECORD (PERPETUATION)

MONUMENT. DESCRIBE NEW MONUMENT SET, OR WORK DONE TO PRESERVE EXISTING MONUMENT

SET GALV. POST W/PB 3.0 FT. SOUTH

MONUMENT STAMPED

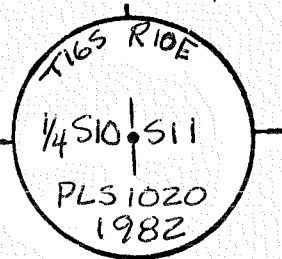

ACCESSORIES DESCRIBE NEW BT'S WITNESS OBJECTS ETC. ESTABLISHED, OR WORK DONE TO PRESERVE EXISTING EVIDENCE

Work Done By F. FAST Title PLS Date _____ State Registration No. PLS 1938
or Agency _____

Planned or Record Prepared Yes No Filed At DESCH. Co. Surveyor's Office Date _____

History of Surveys, G.L.O., etc.

G.L.O. BY G. NEWMAN, CONTRACT # 141, APPROVED 8/13/1870

Index File No G17 T.16 S., R. 10 E., W.M.

Contract or Surv. No _____

Cor. _____

Index File No. 6-19

CORNER RECORD (SEARCH) Contract or Survey No. _____
(Ref. FSM 7151.4)

Cor. No. 1957

T 16 S. R. 10 E. R.D. SISTERS County DESCHUTES C114 Cor. of
Merid. Willamette N.F. Deschutes State Oregon Section 11

CORNER DIAGRAM, per legend

DESCRIBE CORNER MONUMENT FOUND

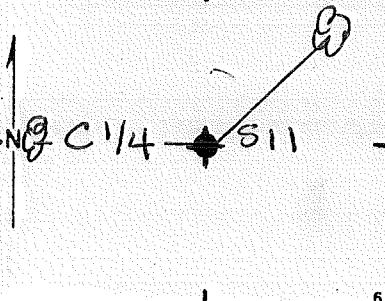

DESCRIBE BEARING TREES OR OTHER OFFICIAL ACCESSORIES FOUND

PHOTO IDENTIFICATION DATA

Photo No. _____

Filed At. _____

Object Ident. _____

Ident. By _____

Signature _____

DESCRIBE CORNER LOCATION RELATIVE TO NEAR-BY FEATURES, ALSO HOW TO REACH CORNER

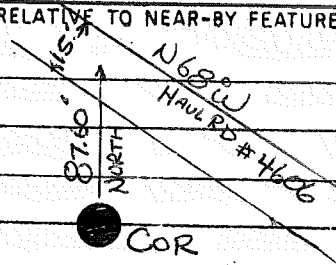

CORNER LEGEND:

FS or Unverified
Constr. Other

○ ◊ Searched For/Not Found

⊗ ⊠ Evidence Found/Accept.

● ◆ Permanent Mon. Set./Fd.

Searched By: F.AST

Title P.L.S.

Division _____

Headquarters _____

Date 7/89

CORNER RECORD (PERPETUATION)

MONUMENT. DESCRIBE NEW MONUMENT SET, OR WORK DONE TO PRESERVE EXISTING MONUMENT

SET 2 1/2" x 30" I.P. W/ 2 1/2" BRASS CAP, P.S.G. 1.4 FT. IN A
 MOUND OF STONE. SET GALV. POST. 3.0 FT. WEST
 W/LSM

MONUMENT STAMPED

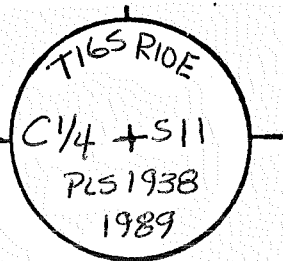

ACCESSORIES DESCRIBE NEW BT'S WITNESS OBJECTS ETC. ESTABLISHED, OR WORK DONE TO PRESERVE EXISTING EVIDENCE

12" P. PINE - WEST - 10.7 FT. (C1/4 S11 B.T.)
 11" P. PINE - N50°E - 27.85 FT. (C1/4 S11 B.T.)
 BT'S HAVE ALUM. NAIL & BRASS WASHER PLS 1938 BETWEEN B.T.

Work Done By F. AST Title PLS Date _____ State Registration No. PLS 1938
 or Agency

Plat of Certified Cor. Record Prepared? Yes No Filed At DESCH. Co. Surveyor's Office Date _____

History
 of
 Surveys,
 G.L.O.,
 etc.

Index File No. G-19 T. 16 S., R. 10 E., W.M.

Contract or Surv. No

Cor.

9

10

11

12

13

Index File No. G-21

CORNER RECORD (SEARCH) Contract or
(Ref. FSM 7151.4) Survey No.

T 16 S. R. 10 E.

R.D. SISTERS

County DESCHUTES

Cor. No. 2157

Merid. Willamette

N.F. Deschutes

State Oregon

1/4 Cor. of Section 12

CORNER DIAGRAM, per legend

DESCRIBE CORNER MONUMENT FOUND

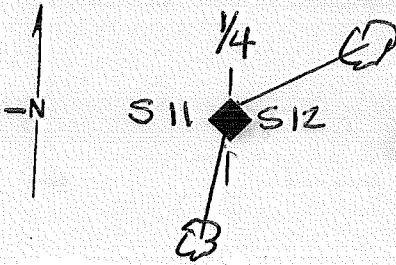

FD. 2" I.P. w/ 2" BRASS CAP, RSG. 0.1 FT
CARS. POST 3.0 FT. West w/LSM

DESCRIBE BEARING TREES OR OTHER OFFICIAL ACCESSORIES FOUND

20" JUN. - S63°E - 20.74 FT. (1/4 S12 BT)

11" P. PINE - S6°W - 16.33 FT. GROWN OVER FACE

BT'S HAVE NAIL & WASHER" PLS 1020" SIDE CENTER

PHOTO IDENTIFICATION DATA

Photo No. _____
Filed At. _____
Object Ident. _____
Ident. By _____

Signature

DESCRIBE CORNER LOCATION RELATIVE TO NEAR-BY FEATURES, ALSO HOW TO REACH CORNER

CORNER LEGEND:

- FS or Unverified
- contr. Other
- Searched For/Not Found
- ◇ Searched For/Not Found
- ⊗ Evidence Found/Accept.
- ⊗ Evidence Found/Accept.
- Permanent Mon. Set/Pd.
- ◆ Permanent Mon. Set/Pd.

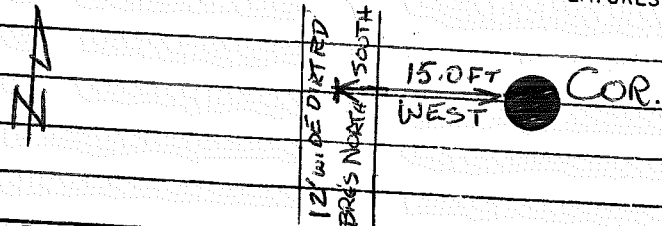

Searched By: FAST

Title PLS

Division

Headquarters

Date 7/89

CORNER RECORD (PERPETUATION)

MONUMENT. DESCRIBE NEW MONUMENT SET, OR WORK DONE TO PRESERVE EXISTING MONUMENT

MONUMENT STAMP

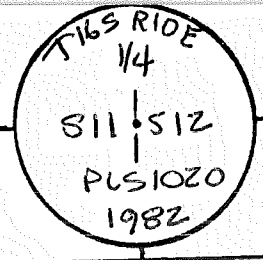

ACCESSORIES DESCRIBE NEW BT'S WITNESS OBJECTS ETC. ESTABLISHED, OR WORK DONE TO PRESERVE EXISTING EVIDENCE

Work Done By F. AST Title P.L.S. Date _____ State Registration No. or Agency PLS 1938

Established For Record Prepared? Yes No Filed At DESM. Co. Surveyor's Office Date _____

History of Surveys, G.L.O., etc. G.L.O. BY G. NEWMAN, CONTRACT # 141, APPROVED 8/13/1870

Index File No. G-21

T16 S., R. 10 E., W.M.

Contract or Surv. No

Cor.

12
13

Index File No. G-23

CORNER RECORD (SEARCH) Contract or Survey No.

T 16 S. R. 10 E.

R.D. SISTERS

County DESCHUTES

Cor. No. 2357

Merid. Willamette

N.F. Deschutes

State Oregon

C114 Cor. of Section 12

CORNER DIAGRAM, per legend

DESCRIBE CORNER MONUMENT FOUND

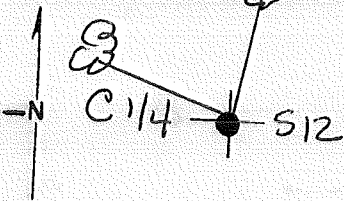

DESCRIBE BEARING TREES OR OTHER OFFICIAL ACCESSORIES FOUND

PHOTO IDENTIFICATION DATA

Photo No. _____
 Filed At. _____
 Object Ident. _____
 Ident. By _____
 Signature _____

DESCRIBE CORNER LOCATION RELATIVE TO NEAR-BY FEATURES, ALSO HOW TO REACH CORNER

CORNER LEGEND:

- FS or Unverified
- Contr. Other
- ◇ Searched For/Not Found
- ⊗ ⊗ Evidence Found/Accept.
- ◆ Permanent Mon. Set/Pd.

Searched By: F. AST

Title PLS

Division

Headquarters

Date 7/89

CORNER RECORD (PERPETUATION)

MONUMENT. DESCRIBE NEW MONUMENT SET, OR WORK DONE TO PRESERVE EXISTING MONUMENT

SET 2 1/2" X 30" I.P. W/ 2 1/2" BRASS CAP, RSG. 1.8 FT. IN A
 ROCK MOUND. SET GALV. POST. 3.0 FT. NORTH W/LSM.

MONUMENT STAMPED

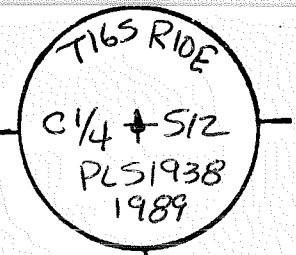

9

ACCESSORIES DESCRIBE NEW BT'S WITNESS OBJECTS ETC. ESTABLISHED, OR WORK DONE TO PRESERVE EXISTING EVIDENCE

12" JUN. - S 74° W - 33.75 FT. (C1/4 S1/2 B-T)

9" JUN. - N 8° E - 33.26 FT. (C1/4 S1/2 B-T)

BT'S HAVE ALUM. NAIL & BRASS WASHER "PLS 1938" BETWEEN B-T

10

Work Done By F. AST Title PLS Date _____ State Registration No. PLS 1938
 or Agency _____

Flat or Record Prepared? Yes No Filed At DESCH Co. Surveyor's Office Date _____

11

History _____
 of _____
 Surveys, _____
 G.L.O., _____
 etc. _____

12

Index File No.

G-23

T. 16 S., R. 10 E., W.M.

Contract or Surv. No

Cor.

13

Index
File No. G-25

T 16 S. R. 10 E.

Merid. Willamette

121402)

CORNER RECORD (SEARCH) Contract or
(Ref. FSM 7151.4) Survey No. _____

R.D. SISTERS County DESCHUTES

N.F. Deschutes State Oregon

Cor. No. 2557
E 1/4 Cor. of Section 12

13

CORNER DIAGRAM per legend

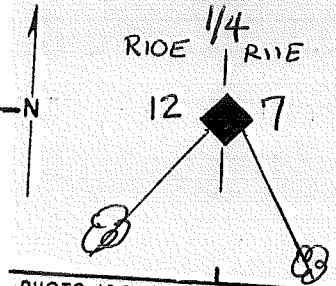

DESCRIBE CORNER MONUMENT FOUND

FD. 2 1/2" GALV. PIPE W/ 2 1/2" BRASS CAP. RSG. 0.8 FT. IN A
ROCK MOUND

DESCRIBE BEARING TREES OR OTHER OFFICIAL ACCESSORIES FOUND

12" JUN. - S 34° W - 20.37 FT. (1/4 5 1/2 BT) SCRIB. VIS.
12" JUN. - S 30° E - 55.77 FT. (1/4 5 7 BT) SCRIB. VIS.

PHOTO IDENTIFICATION DATA

Photo No. _____
Filed At. _____
Object Ident. _____
Ident. By _____
Signature _____

CORNER LEGEND:

- | | | |
|------------------|---------------------|------------------------|
| FS or
Constr. | Unverified
Other | |
| ○ | ◇ | Searched For/Not Found |
| ⊗ | ⊗ | Evidence Found/Accept. |
| ● | ◆ | Permanent Mon. Set/Pd. |

DESCRIBE CORNER LOCATION RELATIVE TO NEAR-BY FEATURES, ALSO HOW TO REACH CORNER

Searched By: FAST

Title P.L.S. Division

Headquarters

Date 7/89

CORNER RECORD (PERPETUATION)

MONUMENT. DESCRIBE NEW MONUMENT SET, OR WORK DONE TO PRESERVE EXISTING MONUMENT

SET GALV. POST 3.0 FT. NORTH W/LSM & PB

MONUMENT STAMPED

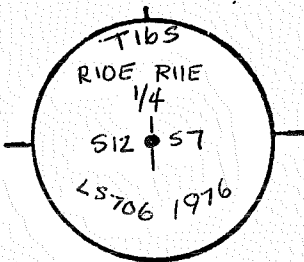

ACCESSORIES DESCRIBE NEW BT'S WITNESS OBJECTS ETC. ESTABLISHED, OR WORK DONE TO PRESERVE EXISTING EVIDENCE

Work Done By FAST Title P.L.S. Date _____ State Registration No. or Agency PLS 1938

Established by Record Prepared? Yes No Filed At DESCH. Co. Surveyor's Office Date _____

History of Surveys, G.L.O., etc. G.L.O BY G. NEWMAN, CONTRACT # 141, APPROVED 8/13/1870

Index File No. G-25 T.16 S., R.10 E., W.M.

Contract or Surv. No

Cor.

9
10
11
12
13

Index File No. H-19

CORNER RECORD (SEARCH) Contract or

(Ref. FSM 7151.4)

T 16 S. R. 10 E.

R.D. SISTERS

Survey No. _____

Cor. No. 1958

Merid. Willamette

N.F. Deschutes

County DESCHUTES

State Oregon

Cor. of _____

Section _____

CORNER DIAGRAM, per legend

DESCRIBE CORNER MONUMENT FOUND

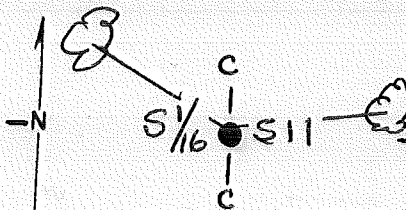

DESCRIBE BEARING TREES OR OTHER OFFICIAL ACCESSORIES FOUND

PHOTO IDENTIFICATION DATA

Photo No. _____

Filed At. _____

Object Ident. _____

Ident. By _____

Signature _____

DESCRIBE CORNER LOCATION RELATIVE TO NEAR-BY FEATURES, ALSO HOW TO REACH CORNER

CORNER LEGEND:

FS or Unverified

Contr. Other

Searched For/Not Found

Evidence Found/Accept.

Permanent Mon. Set/Pd.

Searched By: FAST

Title PLS

Division _____

Headquarters _____

Date 7/89

CORNER RECORD (PERPETUATION)

MONUMENT. DESCRIBE NEW MONUMENT SET, OR WORK DONE TO PRESERVE EXISTING MONUMENT

SET 2 1/2" x 30" I.P. W/ 2 1/2" BRASS CAP, RSG. 1.0 FT. IN
 A ROCK MOUND. SET GALV. POST. 3.0 FT SOUTH w/PB
 SET GALV. POST 4.0 FT. EAST w/LSM & PB.

MONUMENT STAMPED

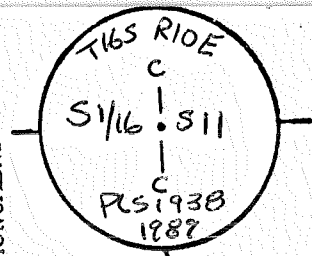

ACCESSORIES DESCRIBE NEW BT'S WITNESS OBJECTS ETC. ESTABLISHED, OR WORK DONE TO PRESERVE EXISTING EVIDENCE

9" JWD. - N 55° W - 34.50 FT. (CS 1/16 S11 BOT)
 10" P. PINE - N 84° E - 34.00 FT. (CS 1/16 S11 BOT)
 BOTH BT'S HAVE ALUM. NAIL & BRASS WASHER PLS 1938 BETWEEN BOT

Work Done By FAST Title P.L.S. Date _____ State Registration No. PLS 1938
 or Agency _____
 Plat. or Record Prepared? Yes No Filed At DESN. Co. Surveyor's Office Date _____

History
 of
 Surveys,
 G.L.O.,
 etc.

Index File No.

4-19

T. 16 S., R. 10 E., W.M.

Contract or Surv. No

Cor.

12

13

15

Index File No. H-21 CORNER RECORD (SEARCH) Contract or

(Ref. FSM 7151.4)

Survey No.

Cor. No. 2158

T 16 S. R. 10 E. R.D. SISTERS County DESCHUTES

S 1/16 Cor. of

Merid. Willamette N.F. Deschutes State Oregon

Section 12

CORNER DIAGRAM, per legend

DESCRIBE CORNER MONUMENT FOUND

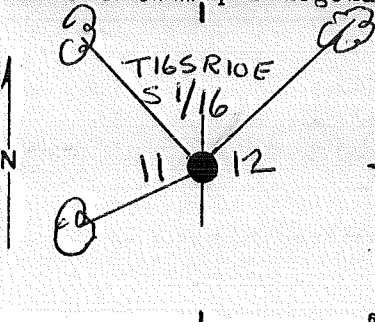

FD. 5/8" IR RSG. 0.1 FT. N 20° E - 1.5 FT (NOT HELD)

DESCRIBE BEARING TREES OR OTHER OFFICIAL ACCESSORIES FOUND

PHOTO IDENTIFICATION DATA

Photo No. _____
Filed At. _____
Object Ident. _____
Ident. By _____

Signature

DESCRIBE CORNER LOCATION RELATIVE TO NEAR-BY FEATURES, ALSO HOW TO REACH CORNER

CORNER LEGEND:

- | | | |
|-------------------------------------|-------------------------------------|------------------------|
| FS or | Unverified | |
| Contr. | Other | |
| <input type="checkbox"/> | <input type="checkbox"/> | Searched For/Not Found |
| <input checked="" type="checkbox"/> | <input checked="" type="checkbox"/> | Evidence Found/Accept. |
| <input checked="" type="checkbox"/> | <input checked="" type="checkbox"/> | Permanent Mon. Set/Fd. |

Searched By: F.AST

Title PLS

Division

Headquarters

Date 7/89

CORNER RECORD (PERPETUATION)

MONUMENT STAMPED

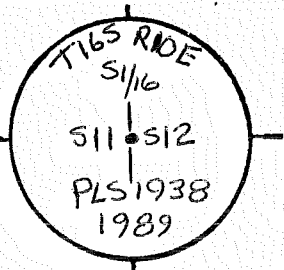

MONUMENT. DESCRIBE NEW MONUMENT SET, OR WORK DONE TO PRESERVE EXISTING MONUMENT

SET A 2 1/2" I.P. W/ 2 1/2" BRASS CAP RSG. 1.7 FT
IN A MOUND OF STONE. SET GALV. POST 7.0 FT WEST
W/ LSM & RB.

ACCESSORIES DESCRIBE NEW BT'S WITNESS OBJECTS ETC. ESTABLISHED, OR WORK DONE TO PRESERVE EXISTING EVIDENCE

15" P.P. - N48°W - 47.5 FT. (S1116 S11 BOT) ALUM NAIL & BRASS WASHER "PLS 1938"
11" JUNIPER - N48°E - 62.80 FT. (S1116 S12 BOT)
POWER POLE - S68°W - 11.98 FT. W/ ALUM. NAIL & BRASS WASHER "PLS 1938" SOUTH SIDE CENTER

Work Done By F. AST Title P.L.S. Date 11/89 State Registration No. or Agency PLS 1938

Plat PE Certified Cor. Record Prepared Yes No Filed At DESCH. Co. Surveyor's Office Date _____

History of Surveys, G.L.O., etc.

Index File No. H-21 T. 16 S., R. 10 E., W.M. Contract or Surv. No. _____ Cor. _____

16

CORNER RECORD (SEARCH) Contract or Survey No. _____
(Ref. FSM 7151.4)

Cor. No. 2358

index File No. H-23

T 16 S. R. 10 E. R.D. _____

SISTERS

County DESCHUTES

CS 1/16 Cor. of

Merid. Willamette

N.F. Deschutes

State Oregon

Section 12

CORNER DIAGRAM, PHOTO Legend

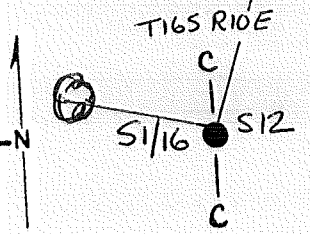

DESCRIBE CORNER MONUMENT FOUND

DESCRIBE BEARING TREES OR OTHER OFFICIAL ACCESSORIES FOUND

PHOTO IDENTIFICATION DATA

Photo No. _____
Filed At. _____
Object Ident. _____
Ident. By _____
Signature

DESCRIBE CORNER LOCATION RELATIVE TO NEAR-BY FEATURES, ALSO HOW TO REACH CORNER

CORNER LEGEND:

- FS or Unverified
- Contr. Other
- Searched For/Not Found
- ⊗ Evidence Found/Accept.
- Permanent Mon. Set/Yd.

Searched By: F. AST

Title P.L.S.

Division _____

Headquarters _____

Date 7/89

CORNER RECORD (PERPETUATION)

MONUMENT. DESCRIBE NEW MONUMENT SET, OR WORK DONE TO PRESERVE EXISTING MONUMENT

SET 2 1/2" x 30" I.P. w/ 2 1/2" BRASS CAP. RSG. 0.4 FT.
IN A MOUND OF STONE. SET POST 30 FT WEST
w/ LSN & PB.

MONUMENT STAMPED

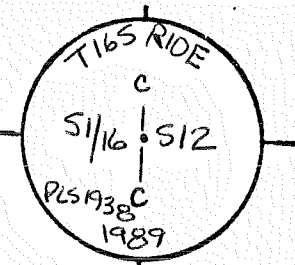

ACCESSORIES DESCRIBE NEW BT'S WITNESS OBJECTS ETC. ESTABLISHED, OR WORK DONE TO PRESERVE EXISTING EVIDENCE

4" JUNIPER - N 75° W - 27.20 FT. (CS 1/16 S 12 BOT)
9" JUNIPER - N 13° E - 62.45 FT. (CS 1/16 S 12 BOT)
BOTH BT'S HAVE ALUM. NAIL & BRASS WASHER "PLS 1938" BETWEEN BOT

Work Done By F. AST Title P.L.S. Date 11/89 State Registration No. PLS 1938
Certified for Record Prepared? Yes No Filed At DESCH. Co. Surveyor's Office Date

History of Surveys, G.L.O., etc.

Index File No. H-23 T. 16 S., R. 10 E., W.M. Contract or Surv. No. Cor.

Index
File No. H-24

CORNER RECORD (SEARCH) Contract or

T 16 S. R. 10 E.

R.D. SISTERS

(Ref. FSM 7151.4)

Survey No. _____

Cor. No. 2458

Merid. Willamette

N.F. Deschutes

County DESCHUTES

SE 1/16 Cor. of

State Oregon

Section 12

CORNER DIAGRAM per legend

DESCRIBE CORNER MONUMENT FOUND

FD. 2 1/2" I.P. w/ 2 1/2" BRASS CAP, 0.4 FT. UNDERGROUND

DESCRIBE BEARING TREES OR OTHER OFFICIAL ACCESSORIES FOUND

14" JUNIPER - N28°W - 21.31 FT. (SE 1/16 S12 BT)

15" JUNIPER - N52°E - 63.87 FT. (SE 1/16 S12 BT)

DESCRIBE CORNER LOCATION RELATIVE TO NEAR-BY FEATURES, ALSO HOW TO REACH CORNER

CORNER FALLS IN DITCH ON SIDE OF DELICIOUS STREET.

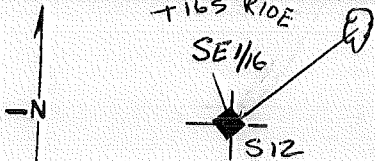

PHOTO IDENTIFICATION DATA

Photo No. _____
Filed At. _____
Object Ident. _____
Ident. By _____

Signature _____

CORNER LEGEND:

- FS or Unverified
- Contr. Other
- Searched For/Not Found
- ◇ Searched For/Not Found
- ⊗ Evidence Found/Accept.
- ⊗ Evidence Found/Accept.
- Permanent Mon. Set/Pd.
- ◆ Permanent Mon. Set/Pd.

Searched By: FAST

Title

PLS

Division

Headquarters

Date 7/89

CORNER RECORD (PERPETUATION)

MONUMENT. DESCRIBE NEW MONUMENT SET, OR WORK DONE TO PRESERVE EXISTING MONUMENT

MONUMENT STAMPED

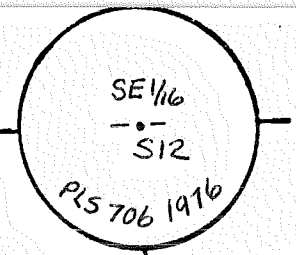

SET GAU. POST 3.0 FT. WEST W/LSM & PB

SET GAU. POST 3.0 FT SOUTH W/PB

ACCESSORIES DESCRIBE NEW BT'S WITNESS OBJECTS ETC. ESTABLISHED, OR WORK DONE TO PRESERVE EXISTING EVIDENCE

Work Done By F. AST Title PLS Date 11/89 State Registration No. PLS 1938
or Agency
Plat or Record Prepared? Yes No Filed At DESCH. Co. Surveyor's Office Date

History of Surveys, G.L.O., etc.

Index File No. H-24 T 16 S., R. 10 E., W.M. Contract or Surv. No. Cor. 13

Index File No. H-25

CORNER RECORD (SEARCH) Contract or

(5/16 12/1?)

T 16 S. R. 10 E.

R.D. SISTERS

(Ref. FSM 7151.4)

Survey No.

Cor. No. 2558

Merid. Willamette

N.F. Deschutes

County DESCHUTES

9/16

Cor. of

State Oregon

Section 12/1

CORNER DIAGRAM, per legend

DESCRIBE CORNER MONUMENT FOUND

5/8" IRON ROD, RISING 0.1 FEET, AS SET

BY PLS 706

DESCRIBE BEARING TREES OR OTHER OFFICIAL ACCESSORIES FOUND

PHOTO IDENTIFICATION DATA

Photo No. _____

Filed At. _____

Object Ident. _____

Ident. By _____

Signature

CORNER LEGEND:

FS or Unverified

Contr. Other



Searched For/Not Found



Evidence Found/Accept.



Permanent Mon. Set/Pd.

Searched By:

F. J. ST PLS

Title

Division

Headquarters

Date

CORNER RECORD (PERPETUATION)

MONUMENT DESCRIBE NEW MONUMENT SET, OR WORK DONE TO PRESERVE EXISTING MONUMENT

NONE

MONUMENT STAMPEL

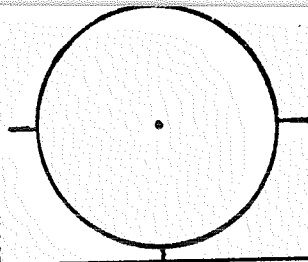

9

ACCESSORIES DESCRIBE NEW BT'S WITNESS OBJECTS ETC. ESTABLISHED, OR WORK DONE TO PRESERVE EXISTING EVIDENCE

NONE

10

Work Done By F. AST Title PLS Date 1-90 State Registration No. or Agency 1938

Plat Filed or Record Prepared? Yes No Filed At Desell Co. Surveyor's Office Date _____

11

History of Surveys, G.L.O., etc.

SURVEY BY B. ROGERS, PLS 706, 3/11/77

12

Index File No. H-25 T. 16 S., R. 10 E., W.M.

Contract or Surv. No

Cor. 2558

13

USDA-FOREST SERVICE D-7100-52(2/82)

Index File No. 0159

CORNER RECORD (SEARCH) Contract or Survey No. _____
(Ref. FSM 7151.4)

Cor. No. J-01

T 16 S. R. 10 E. R.D. SISTERS County DESCHUTES SW Cor. of

Merid. Willamette N.F. Deschutes State Oregon Section 7

CORNER DIAGRAM per legend

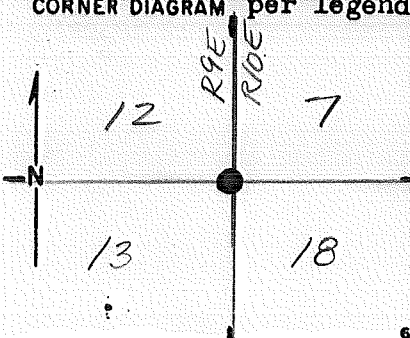

DESCRIBE CORNER MONUMENT FOUND

STONE - 2 NOTCHES SOUTH SIDE

16 X 12 X 10 - MOVED SLIGHTLY IN LOCATION - RISING 12"

DESCRIBE BEARING TREES OR OTHER OFFICIAL ACCESSORIES FOUND

6' HIGH SAWN STUMP W/ OLD TAG. OPEN BLAZE -
SCRIBING VISIBLE 10E S18 - HAS LOW HEALED MARK

559° E @ 20'

PHOTO IDENTIFICATION DATA

Photo No. _____

Filed At. _____

Object Ident. _____

Ident. By _____

Signature _____

DESCRIBE CORNER LOCATION RELATIVE TO NEAR-BY FEATURES, ALSO HOW TO REACH CORNER

EDGE OF CLEAR CUT - 90' WEST OF SPUR RD.

(RD # UNKNOWN)

CORNER LEGEND:

FS or Unverified
Contr. Other

Searched For/Not Found

Evidence Found/Accept.

Permanent Mon. Set/Pd.

Searched By: W. MILLER

Title LS Division ENG Headquarters 50

Date 4-29-83

CORNER RECORD (PERPETUATION)

MONUMENT: DESCRIBE NEW MONUMENT SET, OR WORK DONE TO PRESERVE EXISTING MONUMENT

SET 2 1/2" X 30" BCSP FROM BT (BURIED STONE) STONE
 OUT OF LOCATION BY 2' - STONE MOUND - B. C. RISING 5"

MONUMENT STAMPED

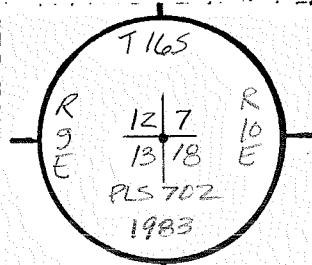

ACCESSORIES : DESCRIBE NEW BT'S WITNESS OBJECTS ETC. ESTABLISHED, OR WORK DONE TO PRESERVE EXISTING EVIDENCE

- 9" P. PINE - N 06° W @ 48³⁴ FT - SCRIBED (T 16 S R 9 E S 12 BT) 60d NAIL IN W. BASE
- 11" P. PINE - N 45 1/4° E @ 59⁹⁹ " " (T 16 S R 10 E S 7 BT) " " " SE "
- 19" P. PINE - S 42 1/2° E @ 41²⁹ " " (T 16 S R 10 E S 18 BT) " " " SW "
- 14" P. PINE - S 13 3/4° W @ 28⁷⁶ " " (T 16 S R 9 E S 13 BT) " " " W. "

Work Done By _____ Title _____ Date 5-9-83 State Registration No. _____ or Agency _____

Plat or _____ **Co. Surveyor's Office** _____ Date _____

History of Surveys, G.L.O., etc.

STONE - 16 X 18 X 8

22" PINE - S 58° E @ 191

Index File No. 0159 T. 16 S., R. 10 E., W.M. Contract or Surv. No. _____ Cor. J-01

File No. J-17

T S. R. E. R.D. _____

Merid. Willamette

CORNER DIAGRAM per legend

CORNER RECORD (SEARCH) Contract or Survey N^o. _____
(Ref. FSM 7151.4)

N.F. Deschutes County _____ State Oregon

Cor. No. 1759

Section _____ Cor. of _____

DESCRIBE CORNER MONUMENT FOUND

FD. A 2 1/2" I.P. w/ 2 1/2" BRASS CAP RSG. 0.4 FT.
FD. CARS. POST 5.0 FT EAST w/ LSM & PB

DESCRIBE BEARING TREES OR OTHER OFFICIAL ACCESSORIES FOUND

12" JUN. - N 11° W - 22.36 FT. (T165 R10E S10 BT)
13" JUN. - N 55° E - 13.93 FT. (T165 R10E S11 BT)

16" JUN. - S 18° E - 31.16 FT. (T165 R10E S14 BT)

3" JUN - S 64° W - 6.06 FT. (A) (BT)

ALL BT'S HAVE SPIKE SIDE CENTER

DESCRIBE CORNER LOCATION RELATIVE TO NEAR-BY FEATURES, ALSO HOW TO REACH CORNER

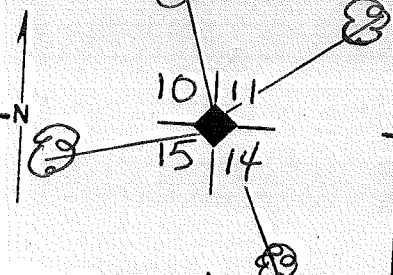

PHOTO IDENTIFICATION DATA

Photo No. _____
Filed At. _____
Object Ident. _____
Ident. By _____
Signature _____

CORNER LEGEND:

FS or Unverified
Contr. Other
○ ◇ Searched For/Not Found
⊗ ⊗ Evidence Found/Accept.
● ◆ Permanent Mon. Set/Pd.

Searched By: FAST

Title P.L.S. Division _____ Headquarters _____

Date 7/89

19

CORNER RECORD (PERPETUATION)

MONUMENT. DESCRIBE NEW MONUMENT SET, OR WORK DONE TO PRESERVE EXISTING MONUMENT

SET GALV POST 3.0 FT SOUTH W/LSM & PB

SET GALV. POST 3.0 FT NORTH W/PB

MONUMENT STAMPED

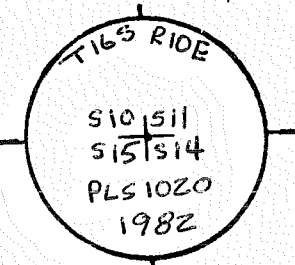

ACCESSORIES DESCRIBE NEW BT'S WITNESS OBJECTS ETC. ESTABLISHED, OR WORK DONE TO PRESERVE EXISTING EVIDENCE

Work Done By F. AST Title P.L.S. Date _____ State Registration No. PLS 1938
or Agency _____
E.P.E. or Record Prepared? Yes No Filed At DESCH. Co. Surveyor's Office Date _____

History of Surveys, G.L.O., etc. G.L.O. BY G. NEWMAN, CONTRACT #141, APPROVED 8/13/1870

Index File No. U.17 T. 16 S., R. 10 E., W.M. Contract or Surv. No _____ Cor. _____

File No. J-19

T 16 S. R. 10 E.

Merid. Willamette

CORNER RECORD (SEARCH) Contract or Survey N^o.

(Ref. FSM 7151.4)

R.D. SISTERS

County DESCHUTES

Cor. No. 1959

N.F. Deschutes

State Oregon

N 114 Cor. of Section 14

CORNER DIAGRAM, per legend

DESCRIBE CORNER MONUMENT FOUND

FD. $2\frac{1}{2}$ " I.P. w/ $2\frac{1}{2}$ " BRASSCAP, RSG. 0.4 FT.

FD. CARB. POST 3.0 FT. EAST w/LSM

DESCRIBE BEARING TREES OR OTHER OFFICIAL ACCESSORIES FOUND

7" JUN. - N71°E - 21.88 FT. (114 S11 BT)

9" P. PINE - S26°E - 13.44 FT. (14 S14 BT)

6 BOTH B.T'S HAVE SPIKE & BRASS WASHER PLS 1020" OUT SIDE CENTER

PHOTO IDENTIFICATION DATA

Photo No. _____

Filed At. _____

Object Ident. _____

Ident. By _____

Signature

DESCRIBE CORNER LOCATION RELATIVE TO NEAR-BY FEATURES, ALSO HOW TO REACH CORNER

CORNER LEGEND:

- | | | |
|---------------|------------|------------------------|
| FS or Constr. | Unverified | Other |
| ○ | ◇ | Searched For/Not Found |
| ⊗ | ⊗ | Evidence Found/Accept. |
| ● | ◆ | Permanent Mon. Set/Pd. |

Searched By: F. AST

Title P.L.S. Division

Headquarters

Date 7/89

20

CORNER RECORD (PERPETUATION)

MONUMENT. DESCRIBE NEW MONUMENT SET, OR WORK DONE TO PRESERVE EXISTING MONUMENT

SET GALV. POST 3.0 FT EAST W/LSM & PB

GET GALV. POST 3.0 FT NORTH W/PB.

MONUMENT STAMPED

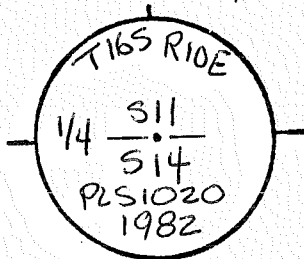

ACCESSORIES DESCRIBE NEW BT'S WITNESS OBJECTS ETC. ESTABLISHED, OR WORK DONE TO PRESERVE EXISTING EVIDENCE

Work Done By FAST Title PLS Date _____ State Registration No. PLS1938
or Agency _____

Plat PE Cor. Record Prepared Yes No Filed At DESCH. Co. Surveyor's Office Date _____

History of Surveys, G.L.O., etc.

G.L.O. BY G. NEWMAN, CONTRACT # 141, APPROVED 8/13/1870

Index File No. J-19 T.16 S., R.10 E., W.M.

Contract or Surv. No

Cor.

10
11
12
13

CORNER RECORD (SEARCH) Contract or Survey No. _____
(Ref. FSM 7151.4)

Cor. No. 2059

index File No. J-20
T 16 S. R. 10 E. R.D. SISTER
Merid. Willamette N.F. Deschutes State Oregon

County DESCHUTES E 1/16 Cor. of Section 14

CORNER DIAGRAM per legend

T16S R10E

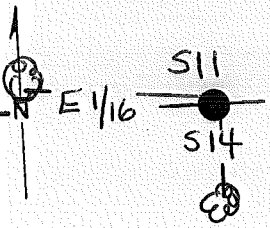

DESCRIBE CORNER MONUMENT FOUND

DESCRIBE BEARING TREES OR OTHER OFFICIAL ACCESSORIES FOUND

PHOTO IDENTIFICATION DATA

Photo No. _____
Filed At. _____
Object Ident. _____
Ident. By _____
Signature

DESCRIBE CORNER LOCATION RELATIVE TO NEAR-BY FEATURES, ALSO HOW TO REACH CORNER

CORNER FALLS UNDER OLD 3 STRAND BARB. WIRE
FENCE BRS NORTH-SOUTH

CORNER LEGEND:

- FS or Contr. Unverified Other
- ◇ Searched For/Not Found
- ⊗ ⊗ Evidence Found/Accept.
- ◆ Permanent Mon. Set/Pd.

Searched By: F.A.S.T

Title P.L.S

Division _____

Headquarters _____

Date 7/89

CORNER RECORD (PERPETUATION)

MONUMENT. DESCRIBE NEW MONUMENT SET, OR WORK DONE TO PRESERVE EXISTING MONUMENT

SET 2 1/2" x 30" I.P. w/ 2 1/2" BRASS CAP RSG. 1.4 FT. IN A STONE

MOUND. SET GALV. STEEL POST 2.3 FT SOUTH w/ LSM. & PB
& 4.0 FT EAST w/ PB.

MONUMENT STAMPED

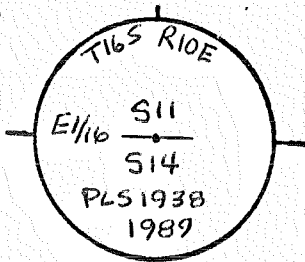

ACCESSORIES DESCRIBE NEW BT'S WITNESS OBJECTS ETC. ESTABLISHED, OR WORK DONE TO PRESERVE EXISTING EVIDENCE

7" JUNIPER - N 86° W - 46.58 FT. (E 1116 S 11 B.O.T)

8" JUNIPER - SOUTH - 10.80 FT. (E 1116 S 14 B.O.T)

BOTH BT'S HAVE ALUM. NAIL & BRASS WASHER PLS 1938" BETWEEN B.O.T

Work Done By F. AST

Title PLS

Date 11/89

State Registration No. or Agency

PLS 1938

Plat or Cor Record Prepared? Yes No

No

Filed At DESCH.

Co. Surveyor's Office Date

History of Surveys, G.L.O., etc.

Index File No. J-20 T.16 S., R.10 E., W.M.

Contract or Surv. No

Cor.

index
File No. J-21

CORNER RECORD (SEARCH) Contract or

(22)

T 16 S. R. 10 E.

(Ref. FSM 7151.4)

Survey No.

Cor. No. 2159

Merid. Willamette

R.D. SISTERS

County DESCHUTES

NW Cor. of

N.F. Deschutes

State Oregon

Section 13

CORNER DIAGRAM per legend

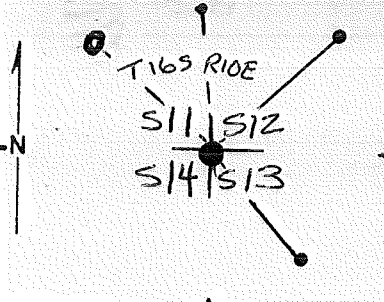

DESCRIBE CORNER MONUMENT FOUND

DESCRIBE BEARING TREES OR OTHER OFFICIAL ACCESSORIES FOUND

PHOTO IDENTIFICATION DATA

Photo No. _____
 Filed At. _____
 Object Ident. _____
 Ident. By _____

Signature

DESCRIBE CORNER LOCATION RELATIVE TO NEAR-BY FEATURES, ALSO HOW TO REACH CORNER

CORNER LEGEND:

- | | | |
|----------------------------------|-------------------------------------|------------------------|
| FS or | Unverified | |
| Contr. | Other | |
| <input type="radio"/> | <input type="checkbox"/> | Searched For/Not Found |
| <input checked="" type="radio"/> | <input checked="" type="checkbox"/> | Evidence Found/Accept. |
| <input checked="" type="radio"/> | <input checked="" type="checkbox"/> | Permanent Mon. Set/Fd. |

Searched By: FAST

Title PLS

Division

Headquarters

Date 7/89

CORNER RECORD (PERPETUATION)

MONUMENT. DESCRIBE NEW MONUMENT SET, OR WORK DONE TO PRESERVE EXISTING MONUMENT

SET 2 1/2" x 30" I.P. w/ 2 1/2" BRASS CAP, RSG. 0.4 FT IN A
SMALL ROCK COLLAR

MONUMENT STAMPED

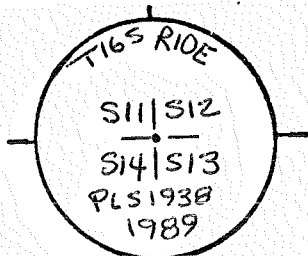

ACCESSORIES DESCRIBE NEW BT'S WITNESS OBJECTS ETC. ESTABLISHED, OR WORK DONE TO PRESERVE EXISTING EVIDENCE

1/2" GALV. IRON PIPE RSG. 0.6 FT. - N 9° W - 48.65 FT.

POWER POLE - N 45° W - 10.55 FT. WITH ALUM. NAIL & BRASS WASHER PLS 1938 SIDE CENTER
RM 1" x 24" STEEL BAR, RSG. 0.1 FT. - N 45° E - 35.50 FT. ← # BT TAG

RM 1" x 24" STEEL BAR, RSG. 0.1 FT. - S 35° E. - 30.93 FT.

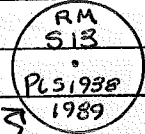
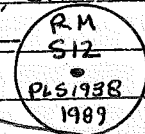

SET GALV. POST 1.0 FT ON BEARING BEHIND RMs & 1/2" IP w/ BT'S & LEM'S

Work Done By F. AST Title PLS Date 11/89 State Registration No. PLS 1938
or Agency

Platted Cor. Record Prepared Yes No Filed At DESCH. Co. Surveyor's Office Date

History of Surveys, G.L.O., etc. G.L.O. BY G. NEWMAN, CONTRACT # 141, APPROVED 8/13/1870

Index File No. S-21 T. 16 S., R. 10 E., W.M.

Contract or Surv. No

Cor.

Index
File No. V-22

CORNER RECORD (SEARCH) Contract or
(Ref. FSM 7151.4) Survey No.

(23)
Cor. No. 2259

T 16 S. R. 10 E. R.D. SISTERS County DESCHUTES Willb Cor. of
Merid. Willamette N.F. Deschutes State Oregon Section 13

CORNER DIAGRAM, per Legend

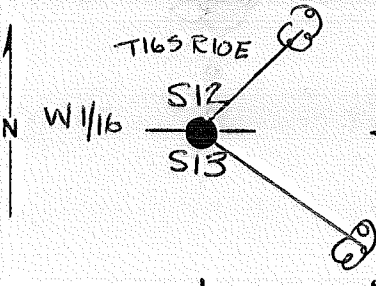

DESCRIBE CORNER MONUMENT FOUND

FD 5/8" IR - N8°E, 1.58 FT (NOT HELD)

DESCRIBE BEARING TREES OR OTHER OFFICIAL ACCESSORIES FOUND

PHOTO IDENTIFICATION DATA

Photo No. _____
Filed At. _____
Object Ident. _____
Ident. By _____
Signature _____

DESCRIBE CORNER LOCATION RELATIVE TO NEAR-BY FEATURES, ALSO HOW TO REACH CORNER

CORNER LEGEND:

- FS or Unverified
- Contr. Other
- ◇ Searched For/Not Found
- ⊗ ⊗ Evidence Found/Accept.
- ◆ Permanent Mon. Set/Pd.

Searched By: F.AST

Title P.L.S. Division Headquarters

Date 7/89

CORNER RECORD (PERPETUATION)

MONUMENT STAMPED

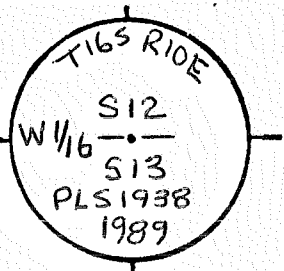

MONUMENT. DESCRIBE NEW MONUMENT SET, OR WORK DONE TO PRESERVE EXISTING MONUMENT

SET 2 1/2" x 30" I.P. w/ 2 1/2" BRASS CAP, R56.0. 4 FT. IN
SMALL ROCK COLLAR

SET GALV. STEEL POST 4.0 FT. SOUTH w/ LSM & PB
E 4.0 FT. EAST w/ PB.

ACCESSORIES DESCRIBE NEW BT'S WITNESS OBJECTS ETC. ESTABLISHED, OR WORK DONE TO PRESERVE EXISTING EVIDENCE

8" JUNIPER - N46°E - 16.80 FT. (W 1/16 S12 B.O.T)

17" P.P. - S78°E - 36.05 FT. (W 1/16 S13 B.O.T)

BOTH BT'S HAVE ALUM. NAIL & BRASS WASHER "PLS 1938" BETWEEN B.O.T

Work Done By F. EAST Title P.L.S. Date 11/89 State Registration No. PLS 1938
or Agency

Plat or Cor. Record Prepared Yes No Filed At DESCH. Co. Surveyor's Office Date

History of Surveys, G.L.O., etc.

Index File No. J22 T16 S., R10 E., W.M. Contract or Surv. No. Cor.

index
File No. J-23

T 16 S. R. 10 E. R.D. SISTERS
Merid. Willamette

CORNER DIAGRAM per legend

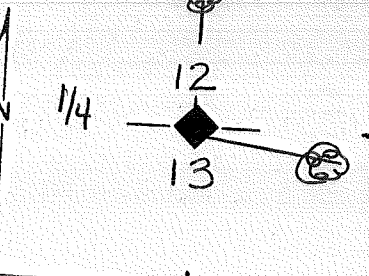

CORNER RECORD (SEARCH) Contract or
(Ref. FSM 7151.4) Survey No. _____
N. F. Deschutes County DESCHUTES
State Oregon

Cor. No. 2359
Cor. of _____
Section _____

DESCRIBE CORNER MONUMENT FOUND

FD. A 2 1/2" GALV. PIPE W/ 2 1/2" BRASS CAP RSG. 0.3 FT.
FD. ORIG. STONE PARTLY BURIED 1.0 FT. WEST OF MONUMENT.
12"x9"x12" W/X Us.

DESCRIBE BEARING TREES OR OTHER OFFICIAL ACCESSORIES FOUND

24" JUN. - NORTH - 84.05 FT. (1/4 S 12 BT) SCRIB. US.
13" JUN. - S 73° E - 47.10 FT. (1/4 S 13 BT) SCRIB. US.

PHOTO IDENTIFICATION DATA

Photo No. _____
Filed At. _____
Object Ident. _____
Ident. By _____
Signature _____

DESCRIBE CORNER LOCATION RELATIVE TO NEAR-BY FEATURES, ALSO HOW TO REACH CORNER

CORNER LEGEND:
FS or Unverified
Constr. Other
○ ◊ Searched For/Not Found
⊗ ⊗ Evidence Found/Accept.
● ◆ Permanent Mon. Set/Id.

Searched By: FAST

Title P.L.S Division _____ Headquarters _____ Date 7/89

24

CORNER RECORD (PERPETUATION)

MONUMENT. DESCRIBE NEW MONUMENT SET, OR WORK DONE TO PRESERVE EXISTING MONUMENT

SET GALV. POST 3.0 FT WEST W/LSM&PB

MONUMENT STAMPED

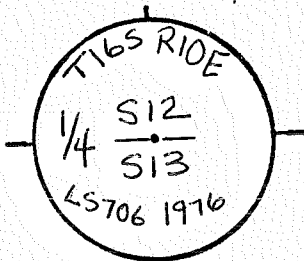

ACCESSORIES DESCRIBE NEW BT'S WITNESS OBJECTS ETC. ESTABLISHED, OR WORK DONE TO PRESERVE EXISTING EVIDENCE

Work Done By F.AST Title P.L.S. Date _____ State Registration No. PLS 1938
or Agency

Plat or Record Prepared? Yes No Filed At DESCH. Co. Surveyor's Office Date _____

History of Surveys, G.L.O., etc. G.L.O. BY G. NEWMAN, CONTRACT #141, APPROVED 8/13/1870

Index File No. J-23 T.16 S., R.10 E., W.M.

Contract or Surv. No

Cor.

9

10

11

12

13

Index File No. J-24

1200 12(482)

CORNER RECORD (SEARCH) Contract or Survey No. _____
(Ref. FSM 7151.4)

(25)

T 16 S. R. 10 E. R.D. SISTERS
Merid. Willamette

N.F. Deschutes

County DESCHUTES

State Oregon

Cor. No. 2459

Cor. of _____

CORNER DIAGRAM, per Legend

DESCRIBE CORNER MONUMENT FOUND

FD. 2 1/2" GALV. PIPE w/ 2 1/2" BRASS CAP, RSG. 0.2 FT.
FD. STEEL POST 14.0 FT. NORTH w/ PB

DESCRIBE BEARING TREES OR OTHER OFFICIAL ACCESSORIES FOUND

8" JUN. - N 46° W - 14.51 FT. SCRIB. VIS. (E 1/16 512 BT)
13" JUN. - S 34° W - 80.42 FT. SCRIB. VIS. (E 1/16 513 BT)

DESCRIBE CORNER LOCATION RELATIVE TO NEAR-BY FEATURES, ALSO HOW TO REACH CORNER

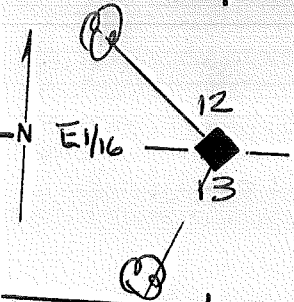

PHOTO IDENTIFICATION DATA

Photo No. _____
Filed At. _____
Object Ident. _____
Ident. By _____
Signature _____

CORNER LEGEND:
FS or Unverified
Constr. Other
○ ◊ Searched For/Not Found
⊗ ⊗ Evidence Found/Accept.
● ◆ Permanent Mon. Set/Fd.

Searched By: F. AST

Title P.L.S. Division _____

Headquarters _____

Date 7/89

CORNER RECORD (PERPETUATION)

MONUMENT. DESCRIBE NEW MONUMENT SET, OR WORK DONE TO PRESERVE EXISTING MONUMENT

SET GALV. POST 3.0 FT. NORTH W/PB
E 3.0 FT WEST W/LSM & PB

MONUMENT STAMPED

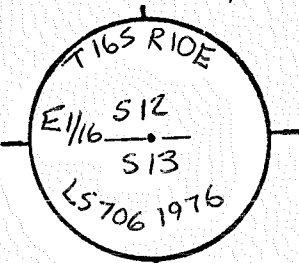

9

ACCESSORIES DESCRIBE NEW BT'S WITNESS OBJECTS ETC. ESTABLISHED, OR WORK DONE TO PRESERVE EXISTING EVIDENCE

Work Done By F. AST Title PLS Date _____ State Registration No. or Agency PLS 1938

Platted Cor. Record Prepared? No Filed At DESCH, Co. Surveyor's Office Date _____

History of Surveys, G.L.O., etc.

Index File No. J-24

T. 16 S., R. 10 E., W.M.

Contract or Surv. No

Cor.

12
13

Index
File No. J-25

T 16 S. R. 10 E.

Merid. Willamette

1214021

CORNER RECORD (SEARCH) Contract or
(Ref. FSM 7151.4) Survey No. _____

R.D. SISTERS

County DESCHUTES

N.F. Deschutes

State Oregon

Cor. No. 2559

Section 12 Cor. of _____

26

CORNER DIAGRAM, per Legend

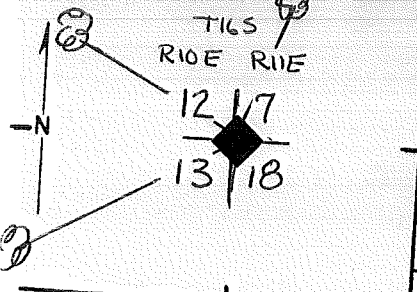

DESCRIBE CORNER MONUMENT FOUND

FD. 2 1/2" GALV. PIPE W/ 2 1/2" BRASS CAP RSG. 0.25 FT.
IN ROCK COLLAR

DESCRIBE BEARING TREES OR OTHER OFFICIAL ACCESSORIES FOUND

13" JUN. - N66°W - 126.80 FT. SCRIB. U/S. (T165 R10E S12 BT)

24" JUN. - N14°E - 81.70 FT. SCRIB. U/S. (T165 R11E S7 BT)

34" JUN. - S56°W - 161.50 FT. SCRIB. U/S. (T165 R10E S13 BT)

PHOTO IDENTIFICATION DATA

Photo No. _____
Filed At. _____
Object Ident. _____
Ident By _____
Signature _____

CORNER LEGEND:

- FS or Unverified
- Constr. Other
- ◇ Searched For/Not Found
- ⊗ ⊗ Evidence Found/Accept.
- ◆ Permanent Mon. Set/Fd.

DESCRIBE CORNER LOCATION RELATIVE TO NEAR-BY FEATURES, ALSO HOW TO REACH CORNER

Searched By: FAST

Title P.L.S.

Division _____

Headquarters _____

Date _____

CORNER RECORD (PERPETUATION)

MONUMENT. DESCRIBE NEW MONUMENT SET, OR WORK DONE TO PRESERVE EXISTING MONUMENT

SET GALV. POST 4.5 FT SOUTH W/PB&LSM

MONUMENT STAMPED

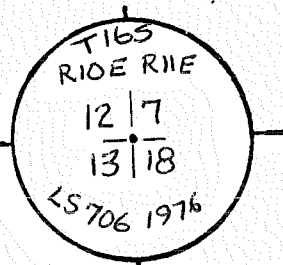

ACCESSORIES DESCRIBE NEW BT'S WITNESS OBJECTS ETC. ESTABLISHED, OR WORK DONE TO PRESERVE EXISTING EVIDENCE

Work Done By F. AST Title PLS Date _____ State Registration No. or Agency PLS 1938

Plate or Record Prepared? Yes No Filed At DESCH. Co. Surveyor's Office Date _____

History of Surveys, G.L.O., etc. G.L.O. BY G. NEWMAN, CONTRACT # 141, APPROVED 8/13/1870

Index File No. T. S., R. E., W.M. Contract or Surv. No. Cor.

Index File No. K-17

CORNER RECORD (SEARCH) Contract or Survey No. _____
 (Ref. FSM 7151.4)

T 16 S. R. 10 E.

R.D. SISTERS County DESCHUTES

Cor. No. 1760

Merid. Willamette

N.F. Deschutes State Oregon

N 1116 Cor. of Section 14

CORNER DIAGRAM per legend

DESCRIBE CORNER MONUMENT FOUND

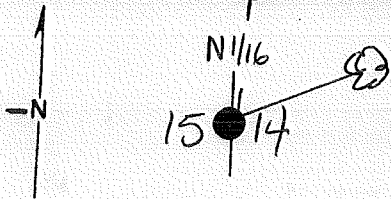

DESCRIBE BEARING TREES OR OTHER OFFICIAL ACCESSORIES FOUND

PHOTO IDENTIFICATION DATA

Photo No. _____
 Filed At. _____
 Object Ident. _____
 Ident. By _____

Signature

DESCRIBE CORNER LOCATION RELATIVE TO NEAR-BY FEATURES, ALSO HOW TO REACH CORNER

CORNER LEGEND:

- FS or Unverified
- Contr. Other
- Searched For/Not Found
- Evidence Found/Accept.
- Permanent Mon. Set/Pd.

Searched By: FAST

Title PLS

Division _____

Headquarters _____

Date 7/189

CORNER RECORD (PERPETUATION)

MONUMENT. DESCRIBE NEW MONUMENT SET, OR WORK DONE TO PRESERVE EXISTING MONUMENT

SET $2\frac{1}{2} \times 30$ " I.P. W/ $2\frac{1}{2}$ " BRASS CAP, RSG. 1.7 FT. IN A
MOUND OF STONE, SET GALV. POST 3.0 FT. NORTH W/LSMERS
SET GALV. POST 3.0 FT EAST W/PB.

MONUMENT STAMPEL

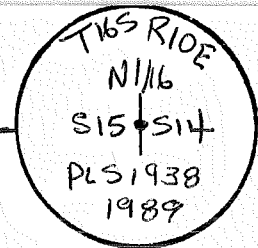

9

ACCESSORIES DESCRIBE NEW BT'S WITNESS OBJECTS ETC. ESTABLISHED, OR WORK DONE TO PRESERVE EXISTING EVIDENCE

16" P. PINE - N 5° E - 33.85 FT. (N116 S14 B.T)

16" JUN - N 66° E - 62.70 FT. (N116 S14 B.T)

BT'S HAVE ALUM. NAIL & BRASS WASHER "PLS 1938" BETWEEN B.T.

10

Work Done By F. AST Title PLS Date _____ State Registration No. PLS 1938
or Agency _____
Estate of Cor Record Prepared? Yes No Filed At DESCHUTES CO. Surveyor's Office Date _____

11

History of Surveys, G.L.O., etc.

12

Index File No.

K-17

T. 16 S., R. 10 E., W.M.

Contract or Surv. No

Cor.

13

Index File No. K-18

CORNER RECORD (SEARCH) Contract or Survey No. _____
(Ref. FSM 7151.4)

Cor. No. 1860

T 16 S. R. 10 E.

R.D. SISTERS

County DESCHUTES

Merid. Willamette

N.F. Deschutes

State Oregon

Cor. of _____

Section _____

CORNER DIAGRAM per legend

DESCRIBE CORNER MONUMENT FOUND

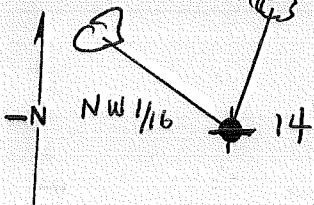

DESCRIBE BEARING TREES OR OTHER OFFICIAL ACCESSORIES FOUND

PHOTO IDENTIFICATION DATA

Photo No. _____
Filed At. _____
Object Ident. _____
Ident. By _____

Signature

DESCRIBE CORNER LOCATION RELATIVE TO NEAR-BY FEATURES, ALSO HOW TO REACH CORNER

CORNER LEGEND:

- FS or Unverified
- Contr. Other
- Searched For/Not Found
- Evidence Found/Accept.
- Permanent Mon. Set/Fd.

Searched By: FAST

Title PLS

Division _____

Headquarters _____

Date 7/87

CORNER RECORD (PERPETUATION)

MONUMENT. DESCRIBE NEW MONUMENT SET, OR WORK DONE TO PRESERVE EXISTING MONUMENT

SET A 2 1/2" x 30" I.P. W/ 2 1/2" BRASS CAP, RSG. 0.6 FT. IN
A ROCK COLLAR. SET GALV. POST 3.0 FT SOUTH W/PB
SET GALV. POST 3.0 FT WEST W/LSM & PB.

MONUMENT STAMPED

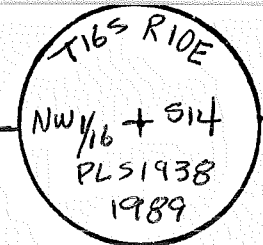

9

ACCESSORIES DESCRIBE NEW BT'S WITNESS OBJECTS ETC. ESTABLISHED, OR WORK DONE TO PRESERVE EXISTING EVIDENCE

8" P. PINE - N7°E - 32.70 FT. (NW 1/16 S14 B.O.T)
12" JUN. - N60°W - 29.72 FT. (NW 1/16 S14 B.O.T)
BT'S HAVE ALUM. NAIL & BRASS WASHER "PLS 1938" BETWEEN B.O.T.

10

Work Done By F. AST Title PLS Date _____ State Registration No. PLS 1938
or Agency _____

Flat or Record Prepared? Yes No Filed At DESCHUTES Co. Surveyor's Office Date _____

11

History
of
Surveys,
G.L.O.,
etc.

Index File No. T. 16 S., R. 10 E., W.M. Contract or Surv. No. _____ Cor. _____
K-18

12

13

File No. K-20

T 16 S. R. 10 E.

Merid. Willamette

CORNER RECORD (SEARCH) Contract or Survey No.

(Ref. FSM 7151.4)

R.D. SISTERS

County DESCHUTES

N.F. Deschutes

State Oregon

Cor. No. 2060

30
NE 1/16 Cor. of Section 14

CORNER DIAGRAM, per Legend

DESCRIBE CORNER MONUMENT FOUND

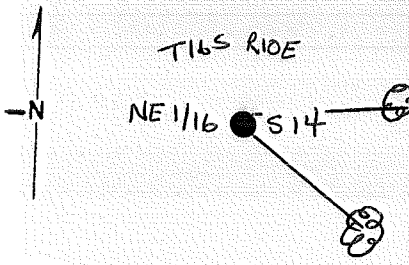

DESCRIBE BEARING TREES OR OTHER OFFICIAL ACCESSORIES FOUND

PHOTO IDENTIFICATION DATA

Photo No. _____

Filed At _____

Object Ident. _____

Ident. By _____

Signature _____

DESCRIBE CORNER LOCATION RELATIVE TO NEAR-BY FEATURES, ALSO HOW TO REACH CORNER

CORNER LEGEND:

- FS or Unverified
- Costr. Other
- Searched For/Not Found
- ⊗ Evidence Found/Accept.
- Permanent Mon. Set/Pd.

Searched By: F. AST

Title P.L.S. Division

Headquarters

Date 7/89

CORNER RECORD (PERPETUATION)

MONUMENT. DESCRIBE NEW MONUMENT SET, OR WORK DONE TO PRESERVE EXISTING MONUMENT

SET A 2 1/2" x 30" I.P. w/ 2 1/2" BRASS CAP R56. O. 6 FT.
IN A MOUND OF STONE

SET GALV. STEEL POST 4.0 FT. NORTH W/L.S.M. & PB
& 4.0 FT. EAST. W/PB.

MONUMENT STAMPED

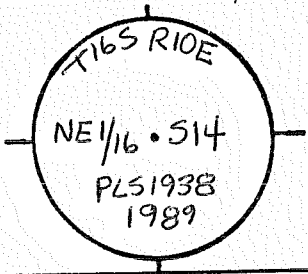

ACCESSORIES DESCRIBE NEW BT'S WITNESS OBJECTS ETC. ESTABLISHED, OR WORK DONE TO PRESERVE EXISTING EVIDENCE

6" P.P. - N 88° E - 40.00 FT. (NE 1/16 514 BOT)

5" JUNIPER - S 46° E - 34.30 FT. (NE 1/16 514 BOT)

BOTH BT'S HAVE ALUM. NAIL & BRASS WASHER "PLS 1938" BETWEEN BOT

Work Done By F. AST Title P.L.S Date 11/89 State Registration No. or Agency PLS 1938

Plat Filed or Record Prepared? Yes No Filed At DESCH Co. Surveyor's Office Date

History of Surveys, G.L.O., etc.

Index File No. K-20 T.16 S., R.10 E., W.M.

Contract or Surv. No

Cor.

12

13

File No. K-21

T 16 S. R. 10 E.

Merid. Willamette

CORNER RECORD (SEARCH) Contract or

(Ref. FSM 7151.4)

Survey No.

R.D. SISTERS

County DESCHUTES

Cor. No. 2160

N.F. Deschutes

State Oregon

N1116 Cor. of Section 13

CORNER DIAGRAM per legend

DESCRIBE CORNER MONUMENT FOUND

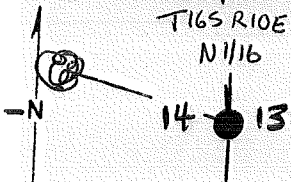

DESCRIBE BEARING TREES OR OTHER OFFICIAL ACCESSORIES FOUND

PHOTO IDENTIFICATION DATA

Photo No. _____

Filed At. _____

Object Ident. _____

Ident. By _____

Signature

DESCRIBE CORNER LOCATION RELATIVE TO NEAR-BY FEATURES, ALSO HOW TO REACH CORNER

CORNER LEGEND:

FS or Unverified
Constr. Other

○ ◇ Searched For/Not Found

⊗ ⊗ Evidence Found/Accept.

● ◆ Permanent Mon. Set/Pd.

Searched By: FAST

Title P.L.S. Division

Headquarters

Date 7-89

CORNER RECORD (PERPETUATION)

MONUMENT. DESCRIBE NEW MONUMENT SET, OR WORK DONE TO PRESERVE EXISTING MONUMENT

SET A 2 1/2" x 30" I.P. w/ 2 1/2" BRASS CAP. RSG. 0.7 FT. IN

A MOUND OF STONE

SET GALV. STEEL POST 3.0 FT. WEST W/ LSM. & PB

& 4.0 FT. SOUTH W/ PB.

ACCESSORIES DESCRIBE NEW BT'S WITNESS OBJECTS ETC. ESTABLISHED, OR WORK DONE TO PRESERVE EXISTING EVIDENCE

7" JUNIPER - N 70° W - 91.60 FT. (N 1/16 S 14 BOT) ALUM. NAIL & BRASS WASHER "PLS 1938"
POWER POLE - N 2° W - 145.47 FT. ALUM. NAIL & BRASS WASHER "PLS 1938" SIDE CENTER
ON WEST SIDE OF POLE W/ BT TAG.

MONUMENT STAMPED

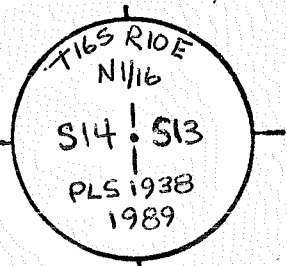

Work Done By FAST Title P.L.S. Date 11/89 State Registration No. PLS 1938
or Agency

Established or Record Prepared? Yes No Filed At DESCH. Co. Surveyor's Office Date

History
of
Surveys,
G.L.O.,
etc.

Index File No.

T. S., R. E., W.M.

Contract or Surv. No

Cor.

12

13

USDA-FOREST SERVICE

Index File No. 019561

CORNER RECORD (SEARCH)

(Ref. FSM 7151.4)

Tract or Survey No. 53-0466-3-02827

Cor. No. W 1/4

2-01

T 165 R. 10E

R.D. SISTERS County DESCHUTES

SEC 18

Merid. _____

N.F. DESCHUTES State OREGON

CORNER DIAGRAM

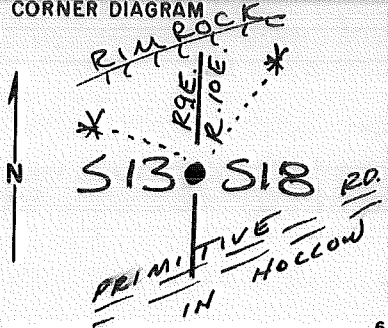

DESCRIBE CORNER MONUMENT FOUND

FOUND 17' x 9' x 7" BASALT STONE SCRIBED 1/4

DESCRIBE BEARING TREES OR OTHER OFFICIAL ACCESSORIES FOUND

NONE

PHOTO IDENTIFICATION DATA

Photo No. _____
Filed At. _____
Object Ident. _____
Ident. By _____
Signature _____

DESCRIBE CORNER LOCATION RELATIVE TO NEAR-BY FEATURES, ALSO HOW TO REACH CORNER

CORNER LIES NORTH OF OLD SPUR RD
NO. UNKNOWN. AT THE BASE OF A 20' HIGH
BLUFF

PLANE COORDINATE POSITION DATA

State _____ Zone _____
X _____
Y _____
Estab. By _____
Agency _____

Signature RCC

Title PLS 1632

Division +

Headquarters _____

Date 5/25/84

7100-52 (3/68)

T
CORNER RECORD (PERPETUATION)

MONUMENT: DESCRIBE NEW MONUMENT SET, OR WORK DONE TO PRESERVE EXISTING MONUMENT

SET A STANDARD USFS 2 1/2" X 30" GALV PIPE & BRASS CAP
FIRMLY IN GROUND RISING 6" ABOVE NATURAL GROUND
ERECTED STONE ~~PLATE~~ ^{MOULD} AROUND MONUMENT

T163
R16 RICE
1/4
S13; S18
1984
R16 1632
9

ACCESSORIES: DESCRIBE NEW BT'S WITNESS OBJECTS ETC. ESTABLISHED, OR WORK DONE TO PRESERVE EXISTING EVIDENCE

A 12" DBH P. PINE BEARS N77°30'E 17.48 FT SCRIBED
"1/4 S 18 BT"; 60d NAIL IN N. BASE.

A 12" DBH P. PINE BEARS N27°E 65.15 FT. SCRIBED
"1/4 S 13 BT"; 60d NAIL IN SE BASE.

10

Work Done By: RCC Title: PLS 1632 Date: 5/84 State Registration No. OR-1632
or Agency

Certified Cor. Record Prepared Yes No Filed At: DES. CO. SURV. OFFICE Date 12 June 1984

REMARKS

GEO. W. NEWMAN SET A STONE 17 X 9 X 7 IN 1871
NO BT'S

Index File No. 0161 T. 163 R. 9E10 M. WM

Tract or Surv. No. 53-0966-3-02829 W 1/4 12
U.S. G.P.O. 1977-725-576 13

Index
File No. L-17

CORNER RECORD (SEARCH) Contract or
(Ref. FSM 7151.4) Survey No.

T 16 S. R. 10 E.

R.D. SISTERS

County DESCHUTES

Cor. No. 1761

Merid. Willamette

N.F. Deschutes

State Oregon

W $\frac{1}{4}$ Cor. of

CORNER DIAGRAM, per legend

1 DESCRIBE CORNER MONUMENT FOUND

FD. ORIG. 12"x8"x9" STONE LAYING FLAT, FLUSH W/GRND.
 $\frac{1}{4}$ VIS. ON FACE

2 DESCRIBE BEARING TREES OR OTHER OFFICIAL ACCESSORIES FOUND

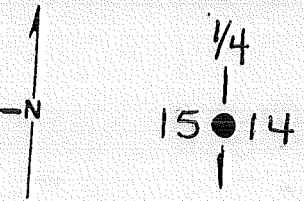

6 PHOTO IDENTIFICATION DATA

Photo No. _____
Filed At. _____
Object Ident. _____
Ident. By _____
Signature _____

CORNER LEGEND:
FS or Unverified
Constr. Other
○ ◊ Searched For/Not Found
⊗ ⊗ Evidence Found/Accept.
● ◆ Permanent Mon. Set/Pd.

3 DESCRIBE CORNER LOCATION RELATIVE TO NEAR-BY FEATURES, ALSO HOW TO REACH CORNER

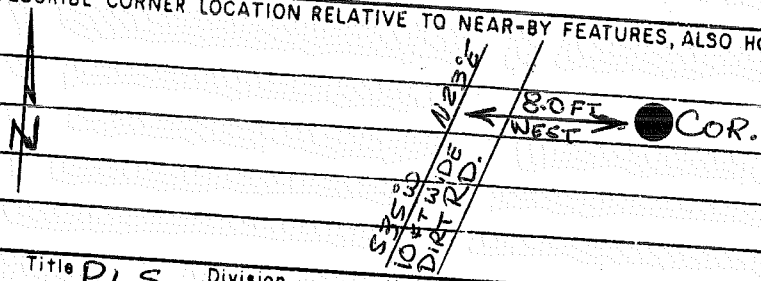

Searched By: FAST

Title PLS. Division

Headquarters

Date 7/89

CORNER RECORD (PERPETUATION)

MONUMENT. DESCRIBE NEW MONUMENT SET, OR WORK DONE TO PRESERVE EXISTING MONUMENT

SET A. 2 1/2" I.P. W/ 2 1/2" BRASS CAP, RSG. 0.8 FT. IN P
 MOUND OF STONE. BURIED ORIG. STONE ON WEST SIDE
 OF MONUMENT. SET GALV. POST 4.0 FT. NORTH W/LSM

MONUMENT STAMPED

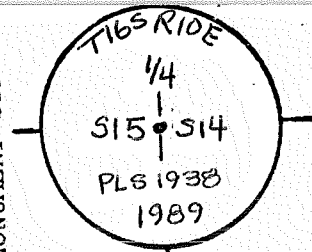

ACCESSORIES DESCRIBE NEW BT'S WITNESS OBJECTS ETC. ESTABLISHED, OR WORK DONE TO PRESERVE EXISTING EVIDENCE

15" P. PINE - N 24° W - 39.53 FT. (1/4 S15 B•T)

6" JUN. - N 60° E - 32.37 FT. (1/4 S14 B•T)

BOTH BT'S HAVE ALUM. NAIL & BRASS WASHER "PLS 1938" BETWEEN B•T

Work Done By F. EAST Title PLS Date 1/89 State Registration No. PLS 1938
 or Agency

Flat or Certified for Record Prepared? Yes No Filed At DESCH. Co. Surveyor's Office Date

History
 of
 Surveys,
 G.L.O.,
 etc.

Index File No.

L-17

T. 16 S., R. 10 E., W.M.

Contract or Surv. No

Cor.

12
13

Index File No. L-18

CORNER RECORD (SEARCH) Contract or Survey No. (Ref. FSM 7151.4)

Cor. No. 1861 ⁽⁸³⁾

T 16 S. R. 10 E. R.D. SISTERS County DESCHUTES W/16 Cor. of Merid. Willamette N.F. Deschutes State Oregon Section 14

CORNER DIAGRAM per legend

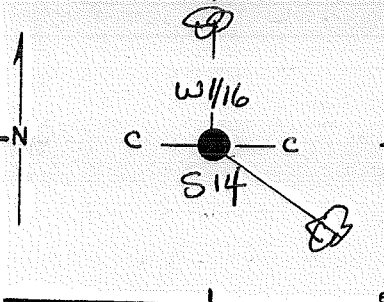

DESCRIBE CORNER MONUMENT FOUND

DESCRIBE BEARING TREES OR OTHER OFFICIAL ACCESSORIES FOUND

PHOTO IDENTIFICATION DATA

Photo No. _____
Filed At. _____
Object Ident. _____
Ident. By _____
Signature _____

DESCRIBE CORNER LOCATION RELATIVE TO NEAR-BY FEATURES, ALSO HOW TO REACH CORNER

CORNER LEGEND:

- FS or Unverified
- Constr. Other
- ◇ Searched For/Not Found
- ⊗ ⊗ Evidence Found/Accept.
- ◆ Permanent Mon. Set/Pd.

Searched By: FAST

Title PLS

Division _____

Headquarters _____

Date _____

7/89

CORNER RECORD (PERPETUATION)

MONUMENT STAMPED

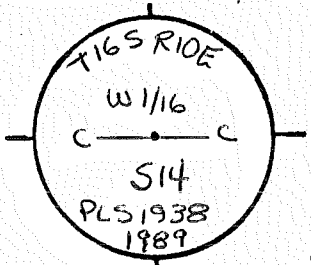

MONUMENT. DESCRIBE NEW MONUMENT SET, OR WORK DONE TO PRESERVE EXISTING MONUMENT

SET 2 1/2" x 30" I.P. W/ 2 1/2" BRASS CAP, RSG. 1.6 FT IN A
ROCK MOUND. SET. GALV. POST 4.0 FT. NORTH W/ LSM & PB

ACCESSORIES DESCRIBE NEW BT'S WITNESS OBJECTS ETC. ESTABLISHED, OR WORK DONE TO PRESERVE EXISTING EVIDENCE

18" P. PINE - NORTH - 14.60 FT. (CW 1/16 S14 BOT)
7" JUN. - S57°E - 76.70 FT. (CW 1/16 S14 BOT)

Work Done By FAST Title PLS Date _____ State Registration No. or Agency PLS 1938

Plat PE Certified Cor. Record Prepared? Yes No Filed At DESCA Co. Surveyor's Office Date _____

History
of
Surveys,
G.L.O.,
etc.

Index File No. L-18 T. 16 S., R. 10 E., W.M.

Contract or Surv. No

Cor.

34

Index File No. L-19

CORNER RECORD (SEARCH) Contract or Survey No.

Cor. No. 1961

T 16 S. R. 10 E. R.D. SISTERS County DESCHUTES

C114 Cor. of

Merid. Willamette N.F. Deschutes State Oregon

Section 14

CORNER DIAGRAM, per legend

DESCRIBE CORNER MONUMENT FOUND

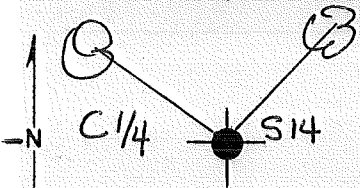

DESCRIBE BEARING TREES OR OTHER OFFICIAL ACCESSORIES FOUND

PHOTO IDENTIFICATION DATA

Photo No. _____
Filed At. _____
Object Ident. _____
Ident. By _____

DESCRIBE CORNER LOCATION RELATIVE TO NEAR-BY FEATURES, ALSO HOW TO REACH CORNER

CORNER LEGEND:

- FS or Unverified
- Constr. Other
- ◇ Searched For/Not Found
- ⊗ ⊗ Evidence Found/Accept.
- ◆ Permanent Mon. Set/Pd.

Searched By: FAST

Title PLS

Division

Headquarters

Date

7/89

CORNER RECORD (PERPETUATION)

MONUMENT STAMPED

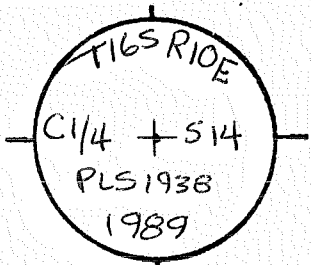

MONUMENT. DESCRIBE NEW MONUMENT SET, OR WORK DONE TO PRESERVE EXISTING MONUMENT

SET 2 1/2" x 30" I.P. W/ 2 1/2" BRASS CAP, P.S.G. 0.7 FT IN A
MOUND OF STONE. SET GALV. POST 3.0 FT. NORTH W/LSM

ACCESSORIES DESCRIBE NEW BT'S WITNESS OBJECTS ETC. ESTABLISHED, OR WORK DONE TO PRESERVE EXISTING EVIDENCE

10" JUN. - N30°W - 45.90 FT. (C1/4 S14 B.O.T)

16" P. PINE - N34°E - 48.26 FT. (C1/4 S14 B.O.T)

BT'S HAVE ALUM. NAIL & BRASS WASHER "PLS 1938" BETWEEN B.O.T

Work Done By F. AST Title PLS Date _____ State Registration No. PLS 1938
or Agency _____

Established Cor. Record Prepared? Yes No Filed At DESCH. Co. Surveyor's Office Date _____

History
of
Surveys,
G.L.O.,
etc.

Index File No. L-19 T. 16 S., R. 10 E., W.M. Contract or Surv. No. Cor. _____

index
File No. L-21

CORNER RECORD (SEARCH) Contract or

(27)

T 16 S. R. 10 E.

R.D. SISTERS

Survey No. _____
County DESCHUTES

Cor. No. 2161

Merid. Willamette

N.F. Deschutes

State Oregon

W 1/4 Cor. of
Section 13

CORNER DIAGRAM, per legend

DESCRIBE CORNER MONUMENT FOUND

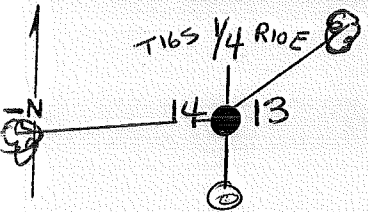

FD. ORIG. 14" x 12" x 8" STONE W/ 1/4 VIS.

DESCRIBE BEARING TREES OR OTHER OFFICIAL ACCESSORIES FOUND

PHOTO IDENTIFICATION DATA

Photo No. _____
Filed At. _____
Object Ident. _____
Ident. By _____
Signature

DESCRIBE CORNER LOCATION RELATIVE TO NEAR-BY FEATURES, ALSO HOW TO REACH CORNER

CORNER LEGEND:

- FS or Unverified
- Contr. Other
- ◊ Searched For/Not Found
- ⊗ ⊗ Evidence Found/Accept.
- ◆ Permanent Mon. Set/Pd.

Searched By: F.A.S.T.

Title
PLS

Division

Headquarters

Date 7/89

CORNER RECORD (PERPETUATION)

MONUMENT. DESCRIBE NEW MONUMENT SET, OR WORK DONE TO PRESERVE EXISTING MONUMENT

SET 2 1/2" X 30" I.P. W/ 2 1/2" BRASS CAP, RSG. 0.4 FT. IN
 SMALL ROCK COLLAR. ORIG. 14" X 12" X 8" STONE BURIED IN STONE COLLAR
 ON WEST SIDE. SET GALV. STEEL POST 4.0 FT. NORTH W/ LSM & PB
 & 4.0 FT. SOUTH W/ PB

MONUMENT STAMPED

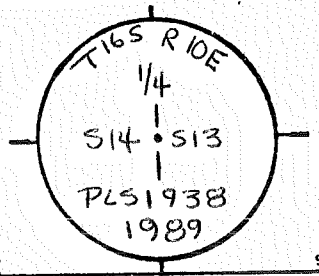

ACCESSORIES DESCRIBE NEW BT'S WITNESS OBJECTS ETC. ESTABLISHED, OR WORK DONE TO PRESERVE EXISTING EVIDENCE

10" JUNIPER - N 54° E - 17.80 FT. (1/4 S 13 BOT) ALUM. NAIL & BRASS WASHER PLS 1938
 13" JUNIPER - S 81° W - 50.40 FT. (1/4 S 14 BOT)
 POWER POLE - SOUTH - 7.88 FT. HAS ALUM. NAIL & BRASS WASHER "PLS 1938" SIDE CENTER

Work Done By FAST Title PLS Date 11/89 State Registration No. PLS 1938
 or Agency

Platted or Record Prepared Yes No Filed At DESCH. Co. Surveyor's Office Date

History of Surveys, G.L.O., etc. G.L.O. BY G. NEWMAN, CONTRACT #141, APPROVED 8/13/1970

Index File No. L-21 T. 16 S., R. 10 E., W.M. Contract or Surv. No. Cor.

9

10

11

12

13

INDEX
File No. L-22 22

CORNER RECORD (SEARCH) Contract or

(Ref. FSM 7151.4)

Survey No. _____

(35)

T 16 S. R. 10 E.

R.D. SISTERS

County DESCHUTES

Cor. No. 2361

Merid. Willamette

N.F. Deschutes

State Oregon

CW116 Cor. of
Section 13

CORNER DIAGRAM per Legend

DESCRIBE CORNER MONUMENT FOUND

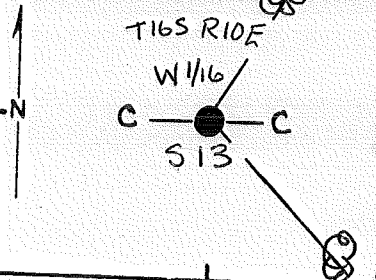

DESCRIBE BEARING TREES OR OTHER OFFICIAL ACCESSORIES FOUND

PHOTO IDENTIFICATION DATA

Photo No. _____
 Filed At. _____
 Object Ident. _____
 Ident. By _____
Signature

DESCRIBE CORNER LOCATION RELATIVE TO NEAR-BY FEATURES, ALSO HOW TO REACH CORNER

CORNER LEGEND:

- FS or Unverified
- Contr. Other
- Searched For/Not Found
- Evidence Found/Accept.
- Permanent Mon. Set/Pd.

Searched By: F.AST

Title
P.L.S

Division

Headquarters

Date
7/89

CORNER RECORD (PERPETUATION)

MONUMENT. DESCRIBE NEW MONUMENT SET, OR WORK DONE TO PRESERVE EXISTING MONUMENT

SET 2 1/2" x 30" I.P. w/ 2 1/2" BRASS CAP, RSG. 0.5 FT. WITH SMALL
ROCK COLLAR. SET GALV. POST 3.0 FT. NORTH w/ LSM

MONUMENT STAMPEL

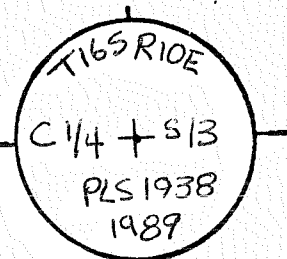

ACCESSORIES DESCRIBE NEW BT'S WITNESS OBJECTS ETC. ESTABLISHED, OR WORK DONE TO PRESERVE EXISTING EVIDENCE

15" P. PINE FORKED ON TOP - NORTH - 40.70 FT. C 1/4 S13 B.F. ALUM NAIL & BRASS WASHER PLS 1938

RM. 1" x 24" STEEL BAR - N 81° W - 6.70 FT. ←



SET GALV. POST 1.0 FT POST RM ON
LINE W/BT & LSM.

RP 3" JUM. - S 29° W - 101.82 FT. ALUM NAIL & BRASS WASHER PLS 1938 SIDE CENTER.

Work Done By F. AST Title PLS Date _____ State Registration No. PLS 1938
or Agency _____

Examined For Record Prepared? Yes No Filed At DESCH Co. Surveyor's Office Date _____

History of Surveys, G.L.O., etc.

Index File No. L-23 T. 16 S., R. 10 E., W.M.

Contract or Surv. No _____

Cor. _____

Index File No. L-25

CORNER RECORD (SEARCH) Contract or Survey No. (Ref. FSM 7151.4)

T 16 S. R. 10 E.

R.D. SISTERS

County DESCHUTES

Cor. No. 2561

Merid. Willamette

N.F. Deschutes

State Oregon

E 1/4 Cor. of Section 13

CORNER DIAGRAM, per legend

DESCRIBE CORNER MONUMENT FOUND

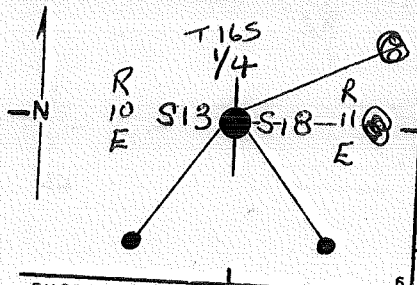

FD. 1/2" I.R. RSG. 0.4 FT. WITH THE ORIG. STONE
12" x 13" x 5" BURIED WEST OF I.R. w/ 1/4" VIS ON WEST FACE

DESCRIBE BEARING TREES OR OTHER OFFICIAL ACCESSORIES FOUND

PHOTO IDENTIFICATION DATA

Photo No. _____
Filed At. _____
Object Ident. _____
Ident. By _____
Signature

DESCRIBE CORNER LOCATION RELATIVE TO NEAR-BY FEATURES, ALSO HOW TO REACH CORNER

CORNER LEGEND:

- FS or Contr. Unverified
- FS or Contr. Other
- Searched For/Not Found
- Evidence Found/Accept.
- Permanent Mon. Set/Fd.

Searched By: FAST

Title P.L.S. Division

Headquarters

Date 7/89

CORNER RECORD (PERPETUATION)

MONUMENT. DESCRIBE NEW MONUMENT SET, OR WORK DONE TO PRESERVE EXISTING MONUMENT

SET 2 1/2" I.P. W/ 2 1/2" BRASS CAP, RSG. 0.5 FT. IN A MOUND OF STONE. BURIED ORIG. STONE ON WEST SIDE OF MONUMENT WITH 1/2" I.R. BURIED INSIDE IRON PIPE.

SET GALV. POST 4.0 FT. NORTH W/ LSM & PB.

ACCESSORIES DESCRIBE NEW BT'S WITNESS OBJECTS ETC. ESTABLISHED, OR WORK DONE TO PRESERVE EXISTING EVIDENCE

4" JUN. R.P. - N 70° E - 143.70 FT. ALUM. NAIL & BRASS WASHER

2" JUN R.P. - EAST - 43.10 FT.

RM. 1" x 24" STEEL BAR - S 35° E - 6.40 FT.

RM 1" x 24" STEEL BAR S 35° W - 8.40 FT.

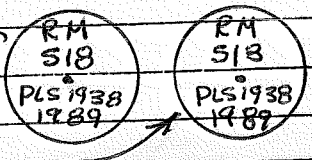

MONUMENT STAMPED

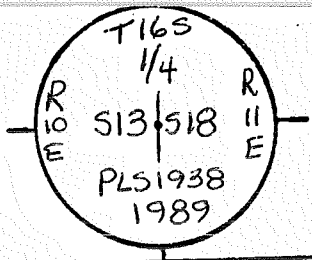

Work Done By F. AST Title P. L. S. Date 11/89 State Registration No. or Agency PLS 1938

State of DE Cor Record Prepared No Filed At DESCH. Co. Surveyor's Office Date 11

History of Surveys, G.L.O., etc.

Index File No. L-25

T. 16 S., R. 10 E., W.M.

Contract or Surv. No

Cor.

12
13

Index
File No. M-21

CORNER RECORD (SEARCH) Contract or

(Ref. FSM 7151.4)

Survey No.

Cor. No. 2162

T 16 S. R. 10 E.

R.D. SISTERS

County DESCHUTES

S/16 Cor. of
Section 13

Merid. Willamette

N.F. Deschutes

State Oregon

CORNER DIAGRAM per legend

DESCRIBE CORNER MONUMENT FOUND

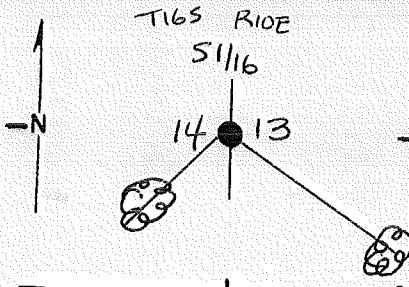

DESCRIBE BEARING TREES OR OTHER OFFICIAL ACCESSORIES FOUND

PHOTO IDENTIFICATION DATA

Photo No. _____
Filed At _____
Object Ident. _____
Ident. By _____
Signature _____

DESCRIBE CORNER LOCATION RELATIVE TO NEAR-BY FEATURES, ALSO HOW TO REACH CORNER

CORNER LEGEND:

- | | | | |
|--------|------------|---|--------------------------|
| FS or | Unverified | | |
| Contr. | Other | ○ | ◇ Searched For/Not Found |
| | | ⊗ | Evidence Found/Accept. |
| | | ● | Permanent Mon. Set/Pd. |

Searched By: F. AST

Title
PLS

Division

Headquarters

Date 7-89

CORNER RECORD (PERPETUATION)

MONUMENT. DESCRIBE NEW MONUMENT SET, OR WORK DONE TO PRESERVE EXISTING MONUMENT

SET 2 1/2" X 30" I.P. W/ 2 1/2" BRASS CAP, P.S.G. 0.4 FT. IN A SMALL
 ROCK COLLAR. SET GALV. POST 4.0 FT NORTH W/ LSM & PB
 SET POST 4.0 FT. EAST W/ PB.

MONUMENT STAMPED

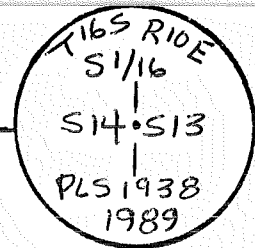

9

ACCESSORIES DESCRIBE NEW BT'S WITNESS OBJECTS ETC. ESTABLISHED, OR WORK DONE TO PRESERVE EXISTING EVIDENCE

4" JUNIPER - S 30° W - 6.75 FT. (S 1/16 S14 B.O.T)
 14" P.P. - S 51° E - 69.5 FT. (S 1/16 S13 B.O.T)
 BOTH BT'S HAVE ALUM. NAIL & BRASS WASHER "PLS 1938" BETWEEN B.O.T

10

Work Done By F. AST Title PLS Date 11/89 State Registration No. PLS 1938
 or Agency

Plate or Record Prepared Yes No Filed At DESCH. Co. Surveyor's Office Date

11

History
 of
 Surveys,
 G.L.O.,
 etc.

12

Index File No.

M-21

T. 16 S., R. 10 E., W.M.

Contract or Surv. No

Cor.

13

INDEX
File No. M-22

CORNER RECORD (SEARCH) Contract or
(Ref. FSM 7151.4) Survey No.

Cor. 39
No. 2262

T 16 S. R. 10 E.

R.D. SISTERS County DESCHUTES

SW 1/16 Cor. of

Merid. Willamette

N.F. Deschutes State Oregon

Section 13

CORNER DIAGRAM, per Legend

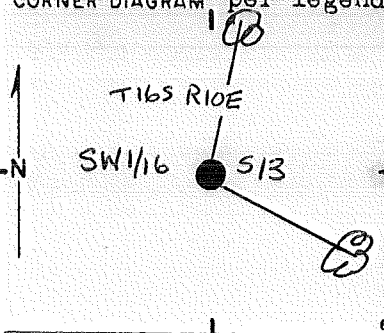

DESCRIBE CORNER MONUMENT FOUND

DESCRIBE BEARING TREES OR OTHER OFFICIAL ACCESSORIES FOUND

PHOTO IDENTIFICATION DATA

Photo No. _____
Filed At. _____
Object Ident. _____
Ident. By _____
Signature

DESCRIBE CORNER LOCATION RELATIVE TO NEAR-BY FEATURES, ALSO HOW TO REACH CORNER

CORNER LEGEND:

- | | | |
|--------|------------|------------------------|
| FS or | Unverified | |
| Contr. | Other | |
| ○ | ◇ | Searched For/Not Found |
| ⊗ | ⊗ | Evidence Found/Accept. |
| ● | ◆ | Permanent Mon. Set/Pd. |

Searched By: F.A.S.T

Title P.L.S. Division

Headquarters

Date 7/89

CORNER RECORD (PERPETUATION)

MONUMENT. DESCRIBE NEW MONUMENT SET, OR WORK DONE TO PRESERVE EXISTING MONUMENT

SET A 2 1/2" X 30" I.P. W/ 2 1/2" BRASS CAP. RSG. 0.4 FT.
IN ROCK COLLAR. SET GALV. POST 4.0 FT. NORTH W/LSMERS
P 4.0 FT. WEST W/P.B.

MONUMENT STAMPED

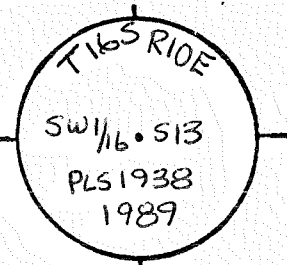

ACCESSORIES DESCRIBE NEW BT'S WITNESS OBJECTS ETC. ESTABLISHED, OR WORK DONE TO PRESERVE EXISTING EVIDENCE

9" JUNIPER - N 8° E - 49.94 FT. (SW 1/16 S13 BOT)
6" TWIN JUNIPER - S 68° E - 50.48 FT. (SW 1/16 S13 BOT)
BOTH BT'S HAVE ALUM. NAIL & BRASS WASHER "PLS 1938" BETWEEN BOT

Work Done By FAST Title PLS Date _____ State Registration No. or Agency PLS 1938

Filed For Record Prepared Yes No Filed At DESCH. Co. Surveyor's Office Date _____

History of Surveys, G.L.O., etc.

Index File No. 0163 CORNER RECORD (SEARCH) Contract or Survey No. N-01
 (Ref. FSM 7151.4) Merid. Willamette N.F. Deschutes State Oregon Section 18
 T 16 S. R. 10 E. R.D. SISTERS County DES SW Cor. of

CORNER DIAGRAM per legend

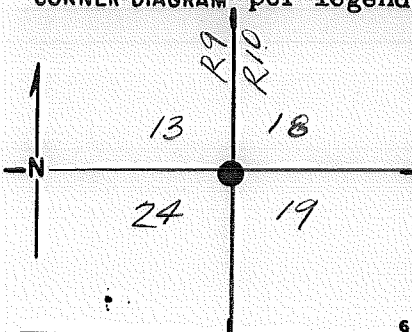

DESCRIBE CORNER MONUMENT FOUND

23 X 11 X 7 (BURIED 14")
STONE - 11 X 10 - RSG 9" - FIRMLY PLANTED IN GROUND
4 CHISEL MARKS ON S. SIDE 2 ON N.
KNITTING NEEDLE BY STONE

DESCRIBE BEARING TREES OR OTHER OFFICIAL ACCESSORIES FOUND

SAWN STUMP - DECAYED - HAS LOW BLAZE (AXE MARK ONLY) IN LOCATION. N 26° E @ 23' FROM FACE OF BLAZE.

PHOTO IDENTIFICATION DATA

Photo No. _____
 Filed At. _____
 Object Ident. _____
 Ident. By _____
 Signature _____

DESCRIBE CORNER LOCATION RELATIVE TO NEAR-BY FEATURES, ALSO HOW TO REACH CORNER

LOCATED BY PHOTO SCALING 1:24,000 COLOR. 200' EAST OF RD. PUT UP LOCATION SIGN

CORNER LEGEND:

- | | | |
|--------------|------------|------------------------|
| FS or Contr. | Unverified | |
| | Other | |
| ○ | ◇ | Searched For/Not Found |
| ⊗ | ⊗ | Evidence Found/Accept. |
| ● | ◆ | Permanent Mon. Set/Fd. |

Searched By: W. MILLER

Title LS

Division ENG.

Headquarters SO

Date 4/29/83

CORNER RECORD (PERPETUATION)

MONUMENT STAMPED

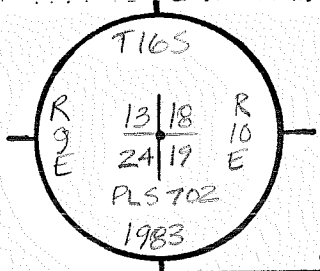

MONUMENT: DESCRIBE NEW MONUMENT SET, OR WORK DONE TO PRESERVE EXISTING MONUMENT
SET BCSP (2 1/2" X 30") RSG. 4" IN PLACE OF STONE
(BURIED IN GROUND ON NE SIDE OF B.C.)

ACCESSORIES : DESCRIBE NEW BT'S WITNESS OBJECTS ETC. ESTABLISHED, OR WORK DONE TO PRESERVE EXISTING EVIDENCE

- 14" P. PINE S 15° W @ 22 ⁷⁰ FT. TO 60d IN NW BASE, SCRIBED - (T165 R9E 324 BT)
 - 13" P. PINE S 37° E @ 40 ⁶⁶ FT. " " " SE " " - (T165 R10E 519 BT)
 - 4" P. PINE N 57 1/4° E @ 56 ¹⁹ FT. " " " NE " " - (X BT)
 - 5" P. PINE N 32 1/2° W @ 46 ⁷⁹ FT. " " " SW " " - (X BT)
- USHIKATA COMPASS DECL. 19 1/2° E

Work Done By _____ Title _____ Date _____ State Registration No. _____
 or Agency _____

Plat of PE Cor. Record Prepared? Yes No Filed At _____ Co. Surveyor's Office Date _____

History STONE - 20 X 9 X 6
 of 20" PINE - N 28° E @ 23'
 Surveys, _____
 G.L.O., _____
 etc. _____

Index File No. 0163 T. 16 S., R. 10 E., W.M. Contract or Surv. No. _____ Cor. N-01

Index File No. N-17

CORNER RECORD (SEARCH) Contract or

(Ref. FSM 7151.4)

Survey No. _____

Cor. No. 1763

T 16 S. R. 10 E.

R.D. SISTERS

County DESCHUTES

SW Cor. of

Merid. Willamette

N.F. Deschutes

State Oregon

Section 14

CORNER DIAGRAM, per legend

DESCRIBE CORNER MONUMENT FOUND

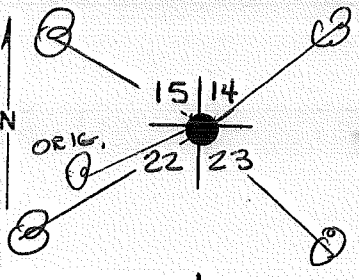

FD. ORIG. 15" x 12" x 8" STONE W/SMALL ROCK COLLAR & SPIKE IN CENTER

DESCRIBE BEARING TREES OR OTHER OFFICIAL ACCESSORIES FOUND

34" P. PINE STUMPS 5.0 FT HIGH - S54W - 48.65 FT. SCRIB VIZ. (TILS RIDE)

PHOTO IDENTIFICATION DATA

Photo No. _____
Filed At. _____
Object Ident. _____
Ident. By _____
Signature

DESCRIBE CORNER LOCATION RELATIVE TO NEAR-BY FEATURES, ALSO HOW TO REACH CORNER

CORNER LEGEND:

- FS or Unverified
- Contr. Other
- ◇ Searched For/Not Found
- ⊗ ⊗ Evidence Found/Accept.
- ◆ Permanent Mon. Set/Fd.

Searched By: FAST

Title P.L.S

Division _____

Headquarters _____

Date 7/87

CORNER RECORD (PERPETUATION)

MONUMENT STAMPED

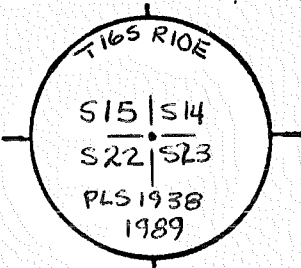

MONUMENT. DESCRIBE NEW MONUMENT SET, OR WORK DONE TO PRESERVE EXISTING MONUMENT

SET 2 1/2" x 30" I.P. W/ 2 1/2" BRASS CAP, RSG. O. 6 FT. IN A SMALL
 ROCK COLLAR. BURIED ORIG. STONE ON WEST SIDE OF MONUMENT.
 SET GALV. POST 4.0 FT NORTH W/ LSM

ACCESSORIES DESCRIBE NEW BT'S WITNESS OBJECTS ETC. ESTABLISHED, OR WORK DONE TO PRESERVE EXISTING EVIDENCE

11" JUN. - N65°W - 79.60 FT. (T165 RIOE S15 BOT)
 6" P. PINE - N50°E - 49.97 FT. (T165 RIOE S14 BOT)
 12" P. PINE - S42°E - 8.80 FT. (T165 RIOE S23 BOT)
 8" P. PINE - S48°W - 19.60 FT. (T165 RIOE S22 BOT)

ALL BT'S HAVE ALUM. NAILED BRASS WASHER PLS 1938 BETWEEN BOT

Work Done By FAST Title P.L.S Date _____ State Registration No. PLS 1938
 or Agency _____

Plat or Record Prepared? No Filed At DESCH. Co. Surveyor's Office Date _____

History _____
 of _____
 Surveys, _____
 G.L.O., _____
 etc. _____

Index File No. N-17 T. S., R. E., W.M. Contract or Surv. No. Cor. _____

Index File No. N-18

CORNER RECORD (SEARCH) Contract or Survey No. _____
(Ref. FSM 7151.4)

Cor. No. 1863 41

T 16 S. R. 10 E. R.D. SISTER County DESCHUTES Will. Cor. of
Merid. Willamette N.F. Deschutes State Oregon Section 14

CORNER DIAGRAM, per legend

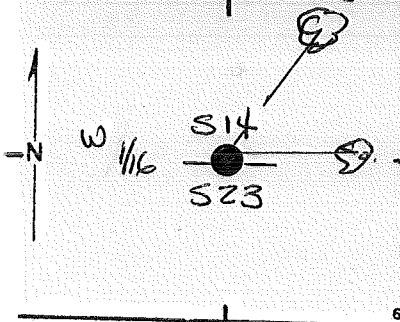

DESCRIBE CORNER MONUMENT FOUND

DESCRIBE BEARING TREES OR OTHER OFFICIAL ACCESSORIES FOUND

PHOTO IDENTIFICATION DATA

Photo No. _____
Filed At. _____
Object Ident. _____
Ident. By _____
Signature

DESCRIBE CORNER LOCATION RELATIVE TO NEAR-BY FEATURES, ALSO HOW TO REACH CORNER

CORNER LEGEND:

- | | | | |
|--------------|------------|------------------------|--|
| FS or Contr. | Unverified | Other | |
| ○ | ◇ | Searched For/Not Found | |
| ⊗ | ⊗ | Evidence Found/Accept. | |
| ● | ◆ | Permanent Mon. Set/Fd. | |

Searched By: FAST

Title PLS Division _____ Headquarters _____ Date 7/89

CORNER RECORD (PERPETUATION)

MONUMENT. DESCRIBE NEW MONUMENT SET, OR WORK DONE TO PRESERVE EXISTING MONUMENT

SET 2 1/2" X 30" I.P. W/ 2 1/2" BRASS CAP, RSG. 0.7 FT. IN A SMALL
ROCK COLLAR.

SET GALV. POST 4.0 FT. EAST W/PB.

SET GALV. POST 4.0 FT NORTH W/LSM & PB.

ACCESSORIES DESCRIBE NEW BT'S WITNESS OBJECTS ETC. ESTABLISHED, OR WORK DONE TO PRESERVE EXISTING EVIDENCE

12" P. PINE - N 34° E - 38.30 FT. (W/116 S14 BOT)

17" JUN. - S 89° E - 112.40 FT. (W/116 S23 BOT)

BOTH BT'S HAVE ALUM. NAIL & BRASS WASHER "PLS 1938" BETWEEN B.T)

MONUMENT STAMPED

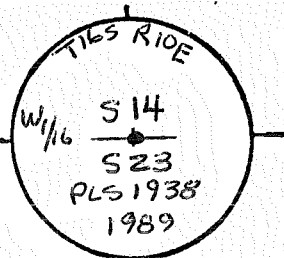

9

Work Done By FAST Title P.L.S Date _____ State Registration No. PLS 1938
or Agency

Plat or Record Prepared Yes No Filed At DESCH. Co. Surveyor's Office Date _____

10

11

History
of
Surveys,
G.L.O.,
etc.

12

Index File No. N-18 T. 16 S., R. 10 E., W.M.

Contract _____ or Surv. No _____

Cor. _____

13

Index File No. N-19 CORNER RECORD (SEARCH) Contract or Survey No. 1963
 (Ref. FSM 7151.4)
 T 16 S. R. 10 E. R.D. SISTERS County DESCHUTES N¹/₄ Cor. of
 Merid. Willamette N.F. Deschutes State Oregon Section 23

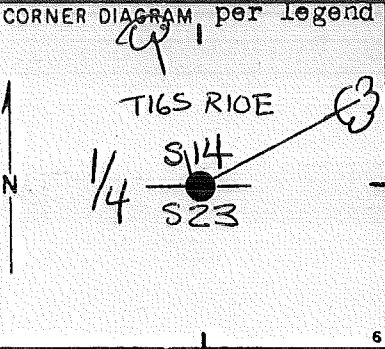

DESCRIBE CORNER MONUMENT FOUND

1 FD. ORIG. STONE 17" x 10" x 7" w/1/4 VIS.

2

DESCRIBE BEARING TREES OR OTHER OFFICIAL ACCESSORIES FOUND

3

6

PHOTO IDENTIFICATION DATA

Photo No. _____

Filed At. _____

Object Ident. _____

Ident. By _____

Signature _____

7

DESCRIBE CORNER LOCATION RELATIVE TO NEAR-BY FEATURES, ALSO HOW TO REACH CORNER

8

CORNER LEGEND:

FS or Contr. Unverified Other

○ ◇ Searched For/Not Found

⊗ ⊗ Evidence Found/Accept.

● ◆ Permanent Mon. Set/Fd.

9

Searched By: FAST Title PLS. Division _____ Headquarters _____ Date 7/89

CORNER RECORD (PERPETUATION)

MONUMENT. DESCRIBE NEW MONUMENT SET, OR WORK DONE TO PRESERVE EXISTING MONUMENT

SET 2 1/2" x 30" I.P. w/ 2 1/2" BRASS CAP RSG. 1.03 FT.
 IN A MOUND OF STONE. BURIED ORIG. STONE ON
 WEST SIDE OF MONUMENT. SET GALV. STEEL POST
 4.0 FT. WEST W/L SM & PB.

MONUMENT STAMPED

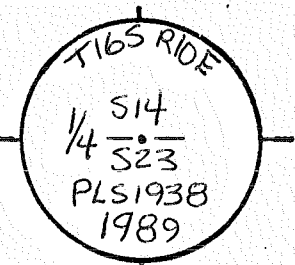

ACCESSORIES DESCRIBE NEW BT'S WITNESS OBJECTS ETC. ESTABLISHED, OR WORK DONE TO PRESERVE EXISTING EVIDENCE

13" P.P. - N 16° W - 64.52 FT. (1/4 514 BOT)
 15" JUNIPER - N 68° E - 74.40 FT. (1/4 514 BOT)
 BOTH BT'S HAVE ALUM. NAIL & BRASS WASHER PLS 1938 AT FACE BETWEEN BOT

Work Done By F. AST Title P.L.S. Date 11/89 State Registration No. PLS1938
 or Agency

Platted or Cor. Record Prepared? Yes No Filed At DESCH. Co. Surveyor's Office Date

History of Surveys, G.L.O., etc.

Index File No. N-19 T. 16 S., R. 10 E., W.M. Contract or Surv. No. 7/89 Cor.

9
10
11
12
13

Index

File No. N-21

CORNER RECORD (SEARCH) Contract or

(43)

T 16 S. R. 10 E.

(Ref. FSM 7151.4)

Survey No. _____

Cor. No. 2163

Merid. Willamette

R.D. SISTERS

County DESCHUTES

SE Cor. of

N.F. Deschutes

State Oregon

Section 14

CORNER DIAGRAM, per Legend

DESCRIBE CORNER MONUMENT FOUND

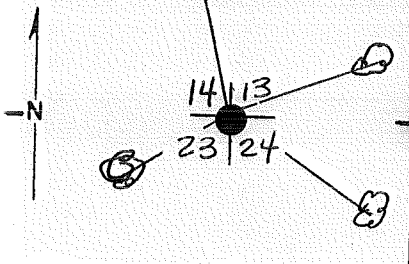

FD. 1" I.D., IRON PIPE, BSG. 1.7 FT.

FD. ORIG. STONE W/3 NOTCHES 14" X 12" X 9", NOTCHES ON EAST FACE

DESCRIBE BEARING TREES OR OTHER OFFICIAL ACCESSORIES FOUND

PHOTO IDENTIFICATION DATA

Photo No. _____

Filed At. _____

Object Ident. _____

Ident. By _____

Signature

DESCRIBE CORNER LOCATION RELATIVE TO NEAR-BY FEATURES, ALSO HOW TO REACH CORNER

CORNER LEGEND:

- FS or Contr. Unverified Other
- ◇ Searched For/Not Found
- ⊗ ⊗ Evidence Found/Accept.
- ◆ Permanent Mon. Set/Pd.

Searched By: FAST

Title PLS

Division _____

Headquarters _____

Date

7/89

CORNER RECORD (PERPETUATION)

MONUMENT STAMPED

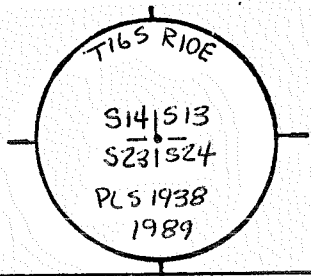

MONUMENT. DESCRIBE NEW MONUMENT SET, OR WORK DONE TO PRESERVE EXISTING MONUMENT

AT ORIG. COR. POSITION, SET A 2 1/2" I.P. W/ 2 1/2" BRASS CAP
 RSG. ~~2.0~~ FT. W/MOUND OF STONE. PLACED 1" I.P. IN SIDE 2 1/2"
 I.P. BURIED 14"x12"x9" ORIG STONE ON WEST SIDE OF MONUMENT
 SET GALV. POST 4.0 FT. WEST W/CSM & PB.

ACCESSORIES DESCRIBE NEW BT'S WITNESS OBJECTS ETC. ESTABLISHED, OR WORK DONE TO PRESERVE EXISTING EVIDENCE

7" P. PINE - N10°W - 179.25 FT. (T16S R10E S14 BOT)
 13" JUN. - N74°E - 97.95 FT. (T16S R10E S13 BOT)
 9" P. PINE - S65°E - 118.95 FT. (T16S R10E S24 BOT)
 6" & 9" TWIN JUN. - S56°W - 40.20 FT. (T16S R10E S23 BOT) SCRIBED ALL 6" TREE
 ALL BT'S HAVE ALUM NAIL & BRASS WASHER "PLS 1938" AT FACE BETWEEN BOT

Work Done By F. AST Title PLS Date _____ State Registration No. PLS 1938
 or Agency _____
 Plat. No. DE Cor. Record Prepared? (Yes) No Filed At DESCH. Co. Surveyor's Office Date _____

History _____
 of _____
 Surveys, _____
 G.L.O., _____
 etc. _____

Index File No. N-21 T. 16 S., R. 10 E., W.M. Contract or Surv. No. _____ Cor. _____

9
10
11
12
13

44

File No. N-23

CORNER RECORD (SEARCH) Contract or
(Ref. FSM 7151.4) Survey No. _____

T 16 S. R. 10 E. Merid. Willamette

R.D. SISTERS

County DESCHUTES

Cor. No. 2363

Legend

DESCRIBE CORNER MONUMENT FOUND

N 1/4 Cor. of Section 24

FD. ORIG. STONE 16" x 11" x 7" w/ 1/4 VIS.

DESCRIBE BEARING TREES OR OTHER OFFICIAL ACCESSORIES FOUND

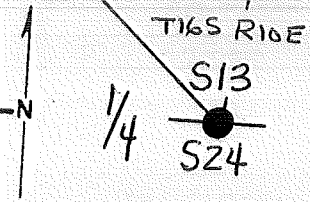

PHOTO IDENTIFICATION DATA

Photo No. _____
Filed At. _____
Object Ident. _____
Ident. By _____

Signature

DESCRIBE CORNER LOCATION RELATIVE TO NEAR-BY FEATURES, ALSO HOW TO REACH CORNER

- CORNER LEGEND:
- | | | |
|--------------|------------------|------------------------|
| FS or Contr. | Unverified Other | |
| ○ | ◇ | Searched For/Not Found |
| ⊗ | ⊗ | Evidence Found/Accept. |
| ● | ◆ | Permanent Mon. Set/Fd. |

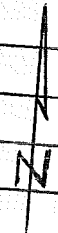

10 FT. WIDE DIRT RD BRG'S E/W

Searched By: F. AST

Title P.L.S.

Division _____

Headquarters _____

Date 7/89

CORNER RECORD (PERPETUATION)

MONUMENT. DESCRIBE NEW MONUMENT SET, OR WORK DONE TO PRESERVE EXISTING MONUMENT

SET 2 1/2" x 30" I.P. w/ 2 1/2" BRASS CAP RSG. 0.6 FT. IN SMALL
ROCK COLLAR. BURIED ORIG. STONE ON WESTSIDE
OF MONUMENT. SET GALV STEEL POST 4.0 FT WEST
W/LSM

MONUMENT STAMPED

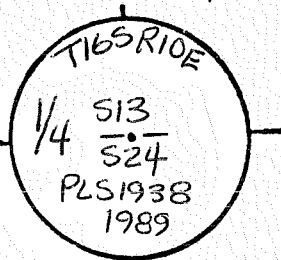

ACCESSORIES DESCRIBE NEW BT'S WITNESS OBJECTS ETC. ESTABLISHED, OR WORK DONE TO PRESERVE EXISTING EVIDENCE

13" P.P. - N10°E - 80.53 FT. (1/4 513 B.O.T)
10" JUNIPER - N56°W - 85.25 FT. (1/4 513 B.O.T)
BOTH BT'S HAVE ALUM. NAIL & BRASS WASHER "PLS 1938" AT FACE BETWEEN B.O.T

Work Done By F. EAST Title PLS Date 11/89 State Registration No. PLS 1938
or Agency

Established for Record Prepared? Yes No Filed At DESCH. Co. Surveyor's Office Date

History
of
Surveys,
G.L.O.,
etc.

Index File No N-23 T. 16 S., R. 10 E., W.M.

Contract or Surv. No

Cor.

USDA-FOREST SERVICE

Index File No. 2563

T 16 S R. 10 E

Merid. WMT

CORNER RECORD (SEARCH)

(Ref. FSM 7151.4)

R.D. Sisters

County Deschutes

N.F. Deschutes

State OR

Tract or Survey No. _____

Cor. No. N-25

NE S. 24

CORNER DIAGRAM

DESCRIBE CORNER MONUMENT FOUND

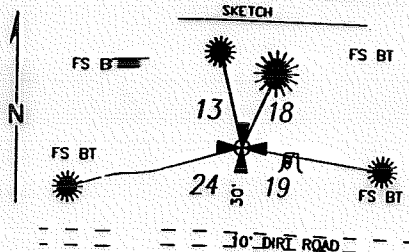

FOUND FOREST SERVICE 2.5" BRASS CAP ON 2.5" IRON PIPE 1.2' ABOVE GROUND IN ROCK MOUND.
FOUND ORIG STONE ALONGSIDE CAP.
FOUND TREES AS PER FRED AST.

FOUND 30" PINE STUMP, 3' HIGH, S 56° E 3 FEET.
NO EVIDENCE OF BLAZE ON NE SIDE, NW SIDE MISSING.
I ASSUME GLO CALL TO BE IN ERROR.

PHOTO IDENTIFICATION DATA

Photo No. _____

Filed At. _____

Object Ident. _____

Ident. By _____

Signature

PLANE COORDINATE POSITION DATA

State _____ Zone _____

X _____

Y _____

Estab. By _____

Agency

DESCRIBE CORNER LOCATION RELATIVE TO NEAR-BY FEATURES, ALSO HOW TO REACH CORNER

Signature WC Kauffman

Title PLS

Division DC

Headquarters Bend

Date 7/96

FS-7100-52 (3/68)

CORNER RECORD (PERPETUATION)

MONUMENT: DESCRIBE NEW MONUMENT SET, OR WORK DONE TO PRESERVE EXISTING MONUMENT

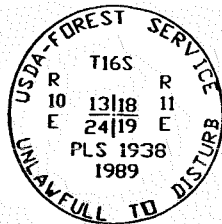

ACCESSORIES : DESCRIBE NEW BT'S WITNESS OBJECTS ETC. ESTABLISHED, OR WORK DONE TO PRESERVE E)

SET NAIL AND BRASS DISK, MKD. COUNTY SURVEYOR, IN SIDE OF 4 EXISTING BT'S.

- 1) A 6" PINE BEARS N 28° E AT 9.04 FEET, NAIL SE SIDE UP 1".
- 2) A 6" PINE BEARS S 70° E AT 31.78 FEET, NAIL SW SIDE UP 3".
- 3) A 13" PINE BEARS S 84° W AT 57.61 FEET, NAIL N SIDE UP 1".
- 4) A 8" PINE BEARS N 14° W AT 43.12 FEET, NAIL W SIDE UP 1".

10

Work Done By Bill Kavffman Title PLS Date 7/96 State Registration No. 1031
or Agency _____

Certified Cor. Record Prepared? Yes No Filed At: PC Date 7/96 11

HISTORY OF ORIGINAL CORNER AND/OR PREVIOUS REVEALS:

REMARKS

G.L.O. 1871- CONTRACT NO. 141- GEORGE W. NEWMAN
 1) SET A STONE 12" X 12" X 6" 2) A 20" PINE BEARS S 55° W 4 LKS.
 1976, CS 1528, GEORGE COLVIN FND. STONE AND SET S.R.
 1984, CS 1530, WILLIAM BAHRKE FND. STONE AND 5/8" REBAR.
 1990, CS 1448, FRED AST FND. 5/8" IRON ROD & ORIG. STONE. REPLACED W/2.5" BRASS CAP ON 30" IRON PIPE.
 1) SCRIBED A 6" PINE BEARS N 28° E 9.2 FEET.
 2) SCRIBED A 5" PINE BEARS S 69° E 31.9 FEET.
 3) SCRIBED A 13" PINE BEARS S 85° E 57.6 FEET.
 4) SCRIBED A 8" PINE BEARS N 15° W 42.9 FEET.

12

Index File No. 2563 T. 16 R. 10 M. WMT Tract or Surv. No. _____ Cor. N-25 13
 GPO: 1986 O- 439-095

USDA-FOREST SERVICE D-7100-52(2/82)

Index File No. 0165

CORNER RECORD (SEARCH) Contract or

(Ref. FSM 7151.4)

Survey No.

Cor. No. P-01

T 16 S. R. 10 E.

R.D. SISTERS

County DES.

W 1/4 Cor. of

Merid. Willamette

N.F. Deschutes

State Oregon

Section 19

CORNER DIAGRAM per legend

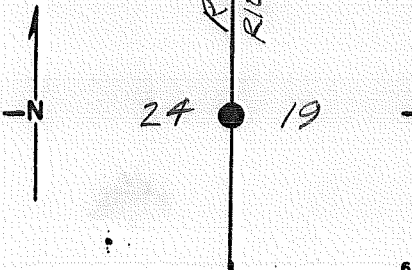

DESCRIBE CORNER MONUMENT FOUND

STONE 16 X 12 X 5 WITH 1/4

CHISELED, FEW STONES IN AREA.

DESCRIBE BEARING TREES OR OTHER OFFICIAL ACCESSORIES FOUND

25" P. PINE S50°E 4 1/2 FT W/OLD ALUM BT TAG,
CHOPPED OPEN, NO SCRIBING VISIBLE, NO BT ON RECORD,
6 LINETREE 60' N

PHOTO IDENTIFICATION DATA

Photo No. _____
Filed At. _____
Object Ident. _____
Ident. By _____
Signature

DESCRIBE CORNER LOCATION RELATIVE TO NEAR-BY FEATURES, ALSO HOW TO REACH CORNER

TAKE RD# 1648 SOUTHERLY TO JUNCTION RD# 1648 C, TURN
LEFT (EASTERLY) 0.5 MILE INTO SPUR RD, TURN RIGHT (SOUTH)
PROCEED 0.2 MI CORNER LIES 125' W. SET LOCATION TAG 100'
EAST OF CORNER

CORNER LEGEND:

- FS or Unverified
- Contr. Other
- Searched For/Not Found
- Evidence Found/Accept.
- Permanent Mon. Set/Fd.

Searched By: R. TAYLOR

Title ST

Division

ENG

Headquarters

SO

Date

5-2-83

4

5

CORNER RECORD (PERPETUATION)

MONUMENT: DESCRIBE NEW MONUMENT SET, OR WORK DONE TO PRESERVE EXISTING MONUMENT

BURIED STONE ON NORTH SIDE OF BCSP (2 1/2" X 30")
RISING 4" IN STONE MOUND

MONUMENT STAMPED

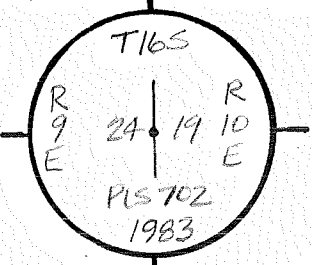

ACCESSORIES: DESCRIBE NEW BT'S WITNESS OBJECTS ETC. ESTABLISHED, OR WORK DONE TO PRESERVE EXISTING EVIDENCE

13" P.PINE - S 73 1/2° W @ 42⁵⁸ FT - SCRIBED (E/4 524 BT) - 60d SPIKE IN (S.) BASE
14" P.PINE - N 59° E @ 59⁶¹ FT - " (W/4 519 BT) - " " " (N.) "

Work Done By _____ Title _____ Date 5/10/83 State Registration No. _____ or Agency _____

Plat or Cor. Record Prepared? Yes No Filed At: _____ Co. Surveyor's Office Date _____

History of Surveys, G.L.O., etc. STONE - 15X12X5 (FOOT OF HILL BEARS NW & SE)

Index File No. 0165 T. 16 S., R. 10 E., W.M. Contract or Surv. No. _____ Cor. P-01

USDA-FOREST SERVICE D-7100-52(2/82)

Index File No. 0167

CORNER RECORD (SEARCH) Contract or Survey No. (Ref. FSM 7151.4)

Cor. No. R-01

T 16 S. R. 10 E. R.D. SISTERS County DES. SW Cor. of Merid. Willamette N.F. Deschutes State Oregon Section 19

CORNER DIAGRAM per legend

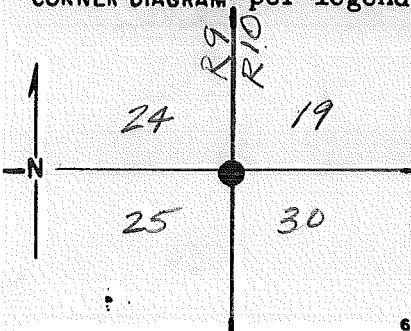

DESCRIBE CORNER MONUMENT FOUND

STONE 14 X 12 X 5 WITH 4 NOTCHES ON NORTH FACE, APPEARS UNDISTURBED.

DESCRIBE BEARING TREES OR OTHER OFFICIAL ACCESSORIES FOUND

DEAD AND DOWN 25" P. PINE W/BT TAG TACKED ON.

SCRIBED - T 16 S R 10 E S 30 BT

PHOTO IDENTIFICATION DATA

Photo No. Filed At. Object Ident. Ident. By Signature

DESCRIBE CORNER LOCATION RELATIVE TO NEAR-BY FEATURES, ALSO HOW TO REACH CORNER

LOCATED ON E. EDGE OF CLEAR CUT. TAKE RD # 1648 SOUTHERLY TO JUNCTION OF RD # 1648 C. TURN LEFT (EASTERLY) PROCEED 800' TO SPUR RD. TURN RIGHT (SOUTHERLY) PROCEED 0.6 MILE. CORNER LOCATED 400' E. OF RD. SET LOCATION TAG 400' W OF COR.

CORNER LEGEND:

FS or Unverified Contr. Other Searched For/Not Found Evidence Found/Accept. Permanent Mon. Set/Fd.

Searched By: R. TAYLOR

Title ST Division ENG Headquarters 50

Date 5-2-83

CORNER RECORD (PERPETUATION)

MONUMENT: DESCRIBE NEW MONUMENT SET, OR WORK DONE TO PRESERVE EXISTING MONUMENT

SET 2 1/2" X 30" BCSP IN LOCATION OF STONE (BURIED
STONE ON W. SIDE OF CAP) R56.4". NO STONE MOUND DUE TO
LACK OF ROCK IN AREA.

MONUMENT STAMPED

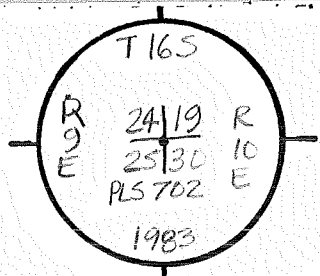

ACCESSORIES: DESCRIBE NEW BT'S WITNESS OBJECTS ETC. ESTABLISHED, OR WORK DONE TO PRESERVE EXISTING EVIDENCE

8" P. PINE - SCRIBED (T16SR10E519BT) - N56° E @ 70⁷⁸ FT - 60d MIL IN (NW) BASE
 8" P. PINE " (T16SR10E530BT) - S36° E @ 6⁰⁸ FT - " " " (W) "
 10" P. PINE " (T16SR10E525BT) - S22° W @ 203³⁹ FT - " " " (W) "
 12" P. PINE " (T16SR10E524BT) - N08° W @ 30²⁶ FT - " " " (W) "
 SILVA COMPASS - DECL. @ 19° E

Work Done By _____ Title _____ Date 5/11/83 State Registration No. _____ or Agency _____

Plat or Cor. Record Prepared? Yes No Filed At: _____ Co. Surveyor's Office Date _____

History of Surveys, G.L.O., etc. STONE 14 X 12 X 5
22" PINE - S45° E @ 37°

Index File No. 0167 T. 16 S., R. 10 E., W.M. Contract or Surv. No. _____ Cor. R-01

USDA-FOREST SERVICE

Index
File No. 2567

T 16 S R. 10 E

Merid. WMT

CORNER RECORD (SEARCH)
(Ref. FSM 7151.4)

R.D. Sisters

County Deschutes

N.F. Deschutes

State Oregon

Tract or Survey No. _____
Cor. No. R-25

NE S. 25

CORNER DIAGRAM

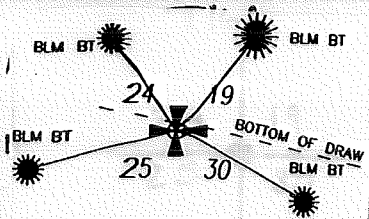

DESCRIBE CORNER MONUMENT FOUND

FD BCSP

DESCRIBE BEARING TREES OR OTHER OFFICIAL ACCESSORIES FOUND

FD 4 BTs

PHOTO IDENTIFICATION DATA

Photo No. _____

Filed At. _____

Object Ident. _____

Ident. By _____

Signature

PLANE COORDINATE POSITION DATA

State _____ Zone _____

X _____

Y _____

Estab. By _____

Agency

Signature

WC Kaufman

Title

PLS

Division

DC

Headquarters

Bad

Date

7/17/96

FS-7100-52 (3/68)

CORNER RECORD (PERPETUATION)

MONUMENT: DESCRIBE NEW MONUMENT SET, OR WORK DONE TO PRESERVE EXISTING MONUMENT

FOUND 3 1/4" BLM BEASS CAP ON IRON PIPE 0.3' ABOVE GROUND.
 FOUND ORIG STONE ALONGSIDE CAP.
 FOUND TREES AS PER GARRISON.

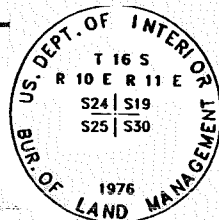

ACCESSORIES : DESCRIBE NEW BT'S WITNESS OBJECTS ETC. ESTABLISHED, OR WORK DONE TO PRESERVE EXISTING EVIDENCE

SET NAIL AND BRASS DISK, MKD. COUNTY SURVEYOR, IN SIDE OF 4 EXISTING BT'S.

- 1) A 16" PINE BEARS N 2' E AT 66.88 FEET, NAIL NW SIDE UP 1'.
- 2) A 10" PINE BEARS S 24' E AT 39.04 FEET, NAIL NE SIDE UP 1'.
- 3) A 24" PINE BEARS S 72' W AT 44.56 FEET, NAIL NW SIDE UP 1'.
- 4) A 14" JUNIPER BEARS N 48' W AT 98.04 FEET, NAIL NE SIDE UP 4'.

Work Done By Bill Kaufman Title PLS Date 7/96 State Registration No. 1031
 or Agency _____
 Certified Cor. Record Prepared? (Yes) No _____ Filed At: Des. Co Date _____

HISTORY OF ORIGINAL CORNER AND/OR PREVIOUS REMOVALS:

REMARKS

G.L.O. 1871 - CONTRACT NO. 141 - GEORGE W. NEWMAN
 1) SET A STONE 30" X 12" X 6" 2) A 24" PINE BEARS S 10' E 65 LKS.

B.L.M. 1976 - GROUP NO. 350 - JOSEPH GARRISON
 FOUND ORIG. STONE & ACCESSORIES. SET 2.5" IRON POST W/BRASS CAP, RESET STONE.
 1) SCRIBED A 12" PINE BEARS N 1' E 101 LKS.
 2) SCRIBED A 6" PINE BEARS S 21' 30" E 60 LKS.
 3) FND. ORIG. BT, A 30" PINE SNAG BEARS S 10' E 65 LKS.
 4) SCRIBED A 20" PINE BEARS S 74' W 67 LKS.
 5) SCRIBED A 10" JUNIPER BEARS N 44' 30' W 148 LKS.

Index File No. 2567 T. 16 R. 10 M. 10 Tract or Surv. No. GPO: 1986 O-439-095 Cor. R-25

USDA-FOREST SERVICE D-7100-52(2/82)

Index File No. 0169

CORNER RECORD (SEARCH)
(Ref. FSM 7151.4)

Contract or Survey No.

Cor. No. T-01

T 16 S. R. 10 E.

R.D. SISTERS

County DESCHUTES

Cor. of w/4

Merid. Willamette

N.F. Deschutes

State Oregon

Section 30

CORNER DIAGRAM per Legend

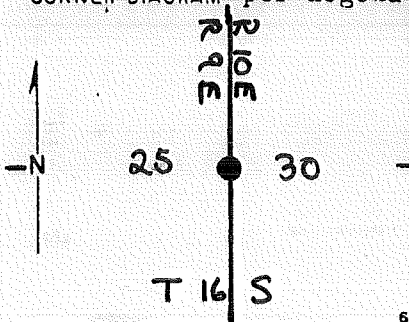

DESCRIBE CORNER MONUMENT FOUND

SFNF

DESCRIBE BEARING TREES OR OTHER OFFICIAL ACCESSORIES FOUND

SFNF

PHOTO IDENTIFICATION DATA

Photo No. _____
 Filed At. _____
 Object Ident. _____
 Ident. By _____
 Signature _____

DESCRIBE CORNER LOCATION RELATIVE TO NEAR-BY FEATURES, ALSO HOW TO REACH CORNER

FROM PHOTO, DROVE TO APPROX LOCATION, FOUND SIGN BOARD, STATING COR. 8 FT SOUTH, FALLS IN MANZANITA GROWTH, CHOPPED BRUSH, DUG W/SHOVEL. ALUM. BT TAGS ON SIGN BOARD. TREE AND 28" P. PINE 40' SOUTH.

CORNER LEGEND:

- | | | |
|---|---|------------------------|
| ○ | ◇ | Searched For/Not Found |
| ⊗ | ⊗ | Evidence Found/Accept. |
| ● | ◆ | Permanent Mon. Set/Fd. |

Searched By:

R. TAYLOR

Title

ST

Division

CS

Headquarters

50

Date

5-2-83

CORNER RECORD (PERPETUATION)

MONUMENT. DESCRIBE NEW MONUMENT SET, OR WORK DONE TO PRESERVE EXISTING MONUMENT

SET A 2 1/2" X 30" BCSP RSG. 9" IN A STONE MOUND

MONUMENT STAMPED

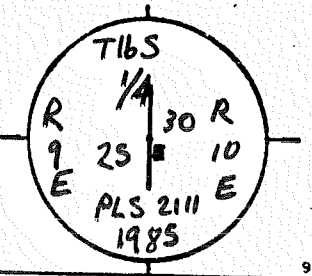

ACCESSORIES DESCRIBE NEW BT'S WITNESS OBJECTS ETC. ESTABLISHED, OR WORK DONE TO PRESERVE EXISTING EVIDENCE

A 6" P. PINE BRS S50°E @ 85.48 FT TO A 60-PENNY SPIKE IN THE NE BASE, MKD. W/4 S30 BT.
 A 5" P. PINE BRS N35°W @ 84.01 FT TO A 60-PENNY SPIKE IN THE ENE BASE, MKD. E/4 S25 BT.

Work Done By W. MILLER Title PLS Date 7/85 State Registration No. 2111
 or Agency

Plat of DE Certified for Record Prepared? Yes No Filed At DES. Co. Surveyor's Office Date 7/14/85

History of Surveys, G.L.O., etc. STONE - 17 X 16 X 16

Index File No. 0169 T. 16 S., R. 10 E., W.M. Contract or Surv. No. Cor. T-01

Index File No. 0171

CORNER RECORD (SEARCH) Contract or Survey No. _____

Cor. No. V-01

T 16 S. R. 10 E. R.D. _____

SISTERS County DESCHUTES

NW Cor. of _____

Merid. Willamette

N.F. Deschutes State Oregon

Section 31

CORNER DIAGRAM per legend

DESCRIBE CORNER MONUMENT FOUND

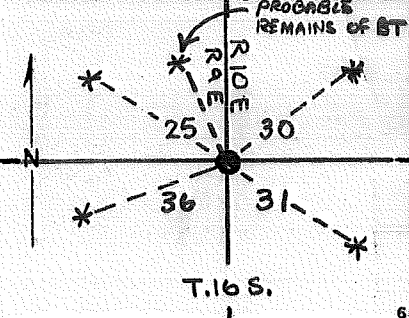

Found stone 1 1/4"x9"x6" with six notches on the East edge, well-bedded in a collar of stone.

DESCRIBE BEARING TREES OR OTHER OFFICIAL ACCESSORIES FOUND

Burnt pine in location with axe marks in BT location.

PHOTO IDENTIFICATION DATA

Photo No. _____
Filed At. _____
Object Ident. _____
Ident. By _____
Signature _____

DESCRIBE CORNER LOCATION RELATIVE TO NEAR-BY FEATURES, ALSO HOW TO REACH CORNER

- CORNER LEGEND:
- FS or Contr. Unverified Other
 - ◇ Searched For/Not Found
 - ⊗ ⊗ Evidence Found/Accept.
 - ◆ Permanent Mon. Set/Pd.

Searched By: W. MILLER Title PLS Division 25 Headquarters 50 Date 1985

CORNER RECORD (PERPETUATION)

MONUMENT. DESCRIBE NEW MONUMENT SET, OR WORK DONE TO PRESERVE EXISTING MONUMENT

Set 2 1/2" X 30" Brass-Capped Steel Pipe in location of the stone, rising 4" in a stone collar. I buried the original stone on the north side of the cap.

MONUMENT STAMPEL

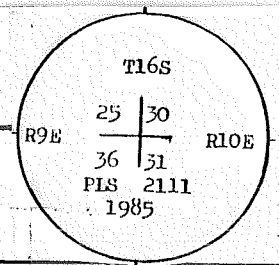

ACCESSORIES DESCRIBE NEW BT'S WITNESS OBJECTS ETC. ESTABLISHED, OR WORK DONE TO PRESERVE EXISTING EVIDENCE

- 1) A 5" White Fir bears N 43 1/4° W at 36.94 Ft. to a 60d spike in the NE base, mkd. 'X' BT.
- 2) A 11" White Fir bears N 42 1/2° E at 37.72 Ft. to a 60d spike in the NW base, mkd. T16SR10ES30BT.
- 3) A 9" White Fir bears S 37 1/4° E at 16.29 Ft. to a 60d spike in the NNE base, mkd. T16SR10ES31BT.
- 4) A 8" White Fir bears S 86 1/4° W at 21.34 Ft. to a 60d spike in the S base, mkd. T16SR9ES36BT.

Burnt Pine snag bears N 25° W at 25.3 Ft.

Work Done By W. MILLER Title PLS Date 6/85 State Registration No. or Agency 2111

Plat or Cor. Record Prepared? (Yes) No Filed At DES Co. Surveyor's Office Date 6/21/85

History of Surveys, G.L.O., etc.

Set Stone 13 X 8 X 6 for corner to Secs 30 & 31 from which A Pine 12 in diam bears N 27° W 34 lks. dist.

Index File No. 0171 T. 16 S., R. 10 E., W.M. Contract or Surv. No. Cor. V-01

USDA-FOREST SERVICE

Index File No. 2371

CORNER RECORD (SEARCH)

(Ref. FSM 7151.4)

Tract or Survey No. _____

Cor. No. V-23

T 165 R 10 E
Merid. WMT

R.D. SISTERS
N.F. Dec.

County DESCHUTES
State OR

5/4 sec. 25

CORNER DIAGRAM

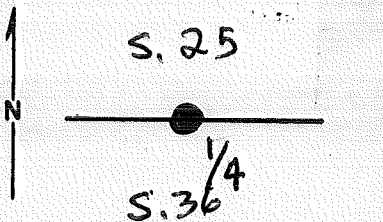

T165 R10E

PHOTO IDENTIFICATION DATA

Photo No. _____
Filed At. _____
Object Ident. _____
Ident. By _____
Signature

PLANE COORDINATE POSITION DATA

State _____ Zone _____
X _____
Y _____
Estab. By _____
Agency

DESCRIBE CORNER MONUMENT FOUND

FOUND 14"x12"x10" STONE FIRMLY SET, SCRIBED $\frac{1}{4}$

DESCRIBE BEARING TREES OR OTHER OFFICIAL ACCESSORIES FOUND

DESCRIBE CORNER LOCATION RELATIVE TO NEAR-BY FEATURES, ALSO HOW TO REACH CORNER

Signature

Don Grestel

Title

PLS

Division

Headquarters

Date

6/02

FS-7100-52 (3/68)

CORNER RECORD (PERPETUATION)

MONUMENT: DESCRIBE NEW MONUMENT SET, OR WORK DONE TO PRESERVE EXISTING MONUMENT

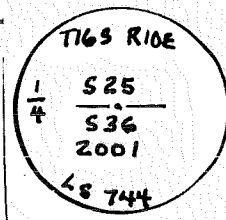

SET 2" IRON PIPE WITH 2 1/2" BRASS CAP AT CORNER POSITION AND BURIED ORIG. STONE ALONGSIDE. SCRIBED NEW BEARING TREES AS FOLLOWS:

9" YELLOW PINE BEARS S46°44'E, 51⁰ FT. SCRIBED 1/4 S36 BT
 11" " " " S05°11'E, 33 FT. " X BT
 11" " " " N55°15'W, 12⁰ FT. " 1/4 S25 BT
 6" JUNIPER " N43°42'E, 19⁰ FT. " 1/4 S25 BT

RESERVE EXISTING EVIDENCE

MEASUREMENTS TO CENTER OF TREE AT ROOT CROWN. A BRASS DISC STAMPED "LS 744" IS NAILED IN LOWER BLAZE

Work Done By: Don Gresdal Title: PLS Date: 6/02 State Registration No. 744
 or Agency
 Certified Cor. Record Prepared Yes No Filed At: Des. Co. Date

REMARKS

G.L.O. SURVEY OF 1871 BY GEORGE W. NEWMAN

SET STONE 14" x 8" x 74

Index File No. 2371 T. R. M. Tract or Surv. No. Cor. V-23
 GPO: 1986 O-439-095

Index

File No. 2571

CORNER RECORD (SEARCH)

(Ref. FSM 7151.4)

Tract or Survey No. _____

Cor. No. V-25

T 16 S R. 10 E R.D. SISTERS County Deschutes SE Cor. Sec. 25

Merid. Will N.F. Deschutes State Oregon NWCOR. SEC. 31

CORNER DIAGRAM

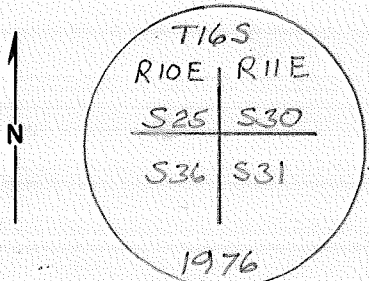

DESCRIBE CORNER MONUMENT FOUND

AT ORIG Cor Sec. 25, 30, 31 & 36 on W. BDP T16SR10E, Mon
By George W. NEWMAN IN 1871. With A Stone 17"x10"x8"
(Rec 18"x8"x5"), Firmly set in Small Mound of Stone.
No marks Visible

DESCRIBE BEARING TREES OR OTHER OFFICIAL ACCESSORIES FOUND

A Pine 36" Dia, Brs S37°W (Rec S43°W)
85 Yrs Dist, MKD @ ILLEG. Scriber MKS
Visible on DOUBLE FACE Open By ME.

PHOTO IDENTIFICATION DATA

Photo No. _____

Filed At. _____

Object Ident. _____

Ident. By _____

Signature

PLANE COORDINATE POSITION DATA

State _____ Zone _____

X _____

Y _____

Estab. By _____

Agency

DESCRIBE CORNER LOCATION RELATIVE TO NEAR-BY FEATURES, ALSO HOW TO REACH CORNER

Snow Creek Ditch
Forest Road 1139, 420' S. of

VIS. by D.T. 10/99

Signature

Title

Division

Headquarters

Date

7100-52-(3, 68)

Dan Sankwich

Survey Tech

7/76

CORNER RECORD (PERPETUATION)

MONUMENT: DESCRIBE NEW MONUMENT SET, OR WORK DONE TO PRESERVE EXISTING MONUMENT

AT The Cor Pt. Set A 2 1/2" x 28" IP 24" in GRD, @ BC MKD.
Orig Stone Deposited Along side IP.

9

ACCESSORIES: DESCRIBE NEW BT's WITNESS OBJECTS ETC. ESTABLISHED, OR WORK DONE TO PRESERVE EXISTING EVIDENCE

A PINE 14" DIA. BRS N30°E 851Ks MKD T16SR11E S30 BT
A PINE 11" DIA. BRS S69°E 381Ks MKD T16SR11E S31 BT
A PINE 10" DIA. BRS N20 1/2°W 761Ks MKD T16SR10E S25 BT

BT. TAGS Posted

10

Work Done By Joe Garrison Title BLM Date 7/76 State Registration No. or Agency _____

Certified Cor. Record Prepared? Yes No Filed At: _____ Date _____

11

REMARKS

NORTHWEST CORNER OF S. 31

FOUND 3-1/4" BCSP RISING 6" ABOVE GROUND AS SET BY THE BLM AND PER PLAT FILED BY COLVIN AND CERTIFICATE FILED BY KAUFFMAN.

N=907530.29 E=4667963.75

5/00
#001088
Walt Miller

Index File No. 2571 T. 16 S R. 10 E W M.

Tract or Surv. No. _____

Cor. V-25¹²₁₃

Index File No. 0173

CORNER RECORD (SEARCH)
(Ref. FSM 7151.4)

Contract or Survey No. _____

Cor. No. X-01

T. 16 S. R. 10 E. R.D. _____

SISTERS

County DESCHUTES

W/4 Cor. of

Merid. Willamette

N.F. Deschutes

State Oregon

Section 31

CORNER DIAGRAM per Legend

DESCRIBE CORNER MONUMENT FOUND

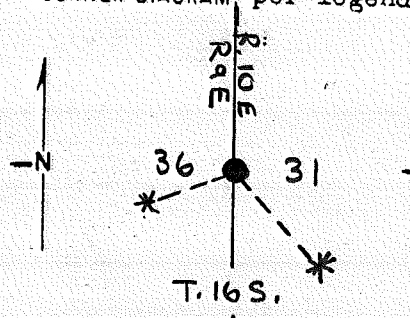

SF/NF

DESCRIBE BEARING TREES OR OTHER OFFICIAL ACCESSORIES FOUND

SF/NF

PHOTO IDENTIFICATION DATA

Photo No. _____
Filed At. _____
Object Ident. _____
Ident. By _____
Signature _____

DESCRIBE CORNER LOCATION RELATIVE TO NEAR-BY FEATURES, ALSO HOW TO REACH CORNER

CORNER LEGEND:

- | | | |
|--------------|------------|------------------------|
| FS or Contr. | Unverified | |
| ○ | ◇ | Searched For/Not Found |
| ⊗ | ⊗ | Evidence Found/Accept. |
| ● | ◆ | Permanent Mon. Set/Yd. |

Searched By: W. MILLER

Title

PLS

Division

CS

Headquarters

SO

Date

1985

CORNER RECORD (PERPETUATION)

MONUMENT. DESCRIBE NEW MONUMENT SET, OR WORK DONE TO PRESERVE EXISTING MONUMENT

SET 2 1/2" X 30" BCSP RSG. 4" IN A STONE COLLAR.

MONUMENT STAMPEE

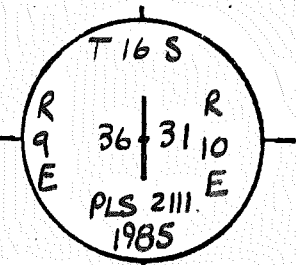

ACCESSORIES DESCRIBE NEW BT'S WITNESS OBJECTS ETC. ESTABLISHED, OR WORK DONE TO PRESERVE EXISTING EVIDENCE

A 5" P. PINE BRS S 4 1/2 @ 48⁶⁰ FT, TO A 60-d SPIKE IN NE BASE,
MKD: W/4 S 31 BT.

A 9" P. PINE BRS. S 77° W @ 13⁷¹ FT TO A 60-d SPIKE IN SE BASE,
MKD: E/4 S 36 BT.

Work Done By W. MILLER Title PLS Date 6/85 State Registration No. 2111

Plat DE Certified for Record Prepared? Yes No Filed At DES Co. Surveyor's Office Date 7/18/85

History of Surveys, G.L.O., etc.

Index

File No. 0175

CORNER RECORD (SEARCH) Contract or

(Ref. FSM 7151.4)

Survey No. _____

Cor. No. 2-01

T 16 S. R. 10 E. R.D. SISTERS

County DESCHUTES

SW Cor. of

Merid. Willamette

N.F. Deschutes

State Oregon

Section 31

CORNER DIAGRAM per legend

DESCRIBE CORNER MONUMENT FOUND

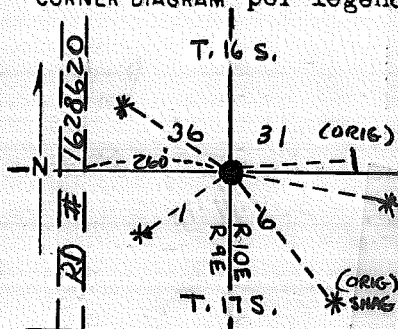

Found a well-bedded stone 16"x10"x10" with six notches on the N. and E. edges.

DESCRIBE BEARING TREES OR OTHER OFFICIAL ACCESSORIES FOUND

Found dead and down 14" Ponderosa Pine with upper and lower blazes. I opened the low blaze to find a scribed 'BT'. Bears N83°E at 26.9 Ft. from stone.

Found a 29" Ponderosa Pine snag, 20 Ft. high, scribed T17SR10ES6BT. S30E at 31.0 from Stone

Found a short pine stump at S 43°W at 55 Ft., but no scribbling.

PHOTO IDENTIFICATION DATA

Photo No. _____

Filed At. _____

Object Ident. _____

Ident. By _____

Signature _____

DESCRIBE CORNER LOCATION RELATIVE TO NEAR-BY FEATURES, ALSO HOW TO REACH CORNER

260' EAST OF RD.

CORNER LEGEND:

FS or Unverified

Contr. Other



Searched For/Not Found



Evidence Found/Accept.



Permanent Mon. Set/Pd.

Searched By:

W. MILLER

Title

PLS

Division

CS

Headquarters

SO

Date

1995

CORNER RECORD (PERPETUATION)

MONUMENT. DESCRIBE NEW MONUMENT SET, OR WORK DONE TO PRESERVE EXISTING MONUMENT

After testing a dist.-dist. intersect from the NE and SE BT'S
 (Hit 0.6 ft. SE of Orig. stone), I set a 2 1/2" X 30" Brass-Capped
 steel Pipe rising 3" in a stone collar. I buried the stone in
 the hole on the SE'ly side of the cap. The Brass Cap sits in the
 location of the stone.

MONUMENT STAMPED

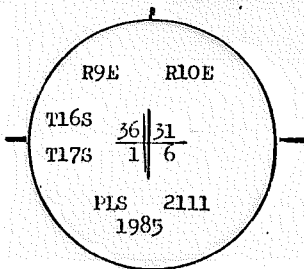

ACCESSORIES DESCRIBE NEW BT'S WITNESS OBJECTS ETC. ESTABLISHED, OR WORK DONE TO PRESERVE EXISTING EVIDENCE

- 1) A 7" White Fir Bears N63 3/4°W at 14.51 Ft. to a 60d spike
in the SW base, mkd. T16SR9ES36BT.
- 2) A 9" White Fir Bears N63°E at 18.31 Ft. to a 60d spike
in the SE base, mkd. T16SR10ES31BT.
- 3) A 8" White Fir Bears S83 3/4°E at 35.43 Ft. to a 60d spike
in the NNW base, mkd. T17SR10ES6BT.
- 4) A 7" White Fir Bears S47 1/2°W at 5.24 Ft. to a 60d spike;
in the SE base, mkd. T17SR9ES1BT.

Work Done By W. Miller Title PLS Date 6/85 State Registration No 2111
 or Agency
 Platified or Record Prepared? Yes No Filed At DES Co. Surveyor's Office Date 6/21/85

History of Surveys, G.L.O., etc. Set stone 14 x 12 x 8 for corner to Townships 16 & 17 South, Ranges 9 & 10 East from which

A Pine 10 in. diam. bears N 81°E 40 lks. dist	
A Pine 28 " " " S 32°E 44 " "	
A Pine 22 " " " S 40°W 82 " "	

Index File No. 0175 T. 16 S., R. 10 E., W.M. Contract or Surv. No. _____ Cor. 2-01

Index
File No. 0975

CORNER RECORD (SEARCH)
(Ref. FSM 7151.4)

Tract or
Survey No. _____
Cor. No. Z-09

T 16 S. R. 10 E., R.D. SISTERS County DESCHUTES SW COR.

Merid. W.M. N.F. DNE State OR S.33

CORNER DIAGRAM

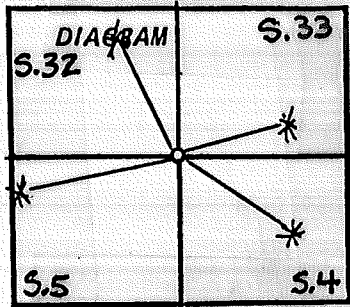

DESCRIBE CORNER MONUMENT FOUND

Found stone 16 x 8 x 7 out of the ground with 4 notches on one edge and 1 notch on another edge. However I found a hole filled with manzanita leaves which contained a piece of rotted lathe and bits of flagging into which the stone fit very well.

2

DESCRIBE BEARING TREES OR OTHER OFFICIAL ACCESSORIES FOUND

I found the B.T. which was a down and decayed log that was scribed TL6SR10ES33BT of which there was not enough remains of the stump to determine where it came from. There was also a cat track through the area of the tree.

3

PHOTO IDENTIFICATION DATA

Photo No. _____
Filed At. _____
Object Ident. _____
Ident. By _____
Signature

7

DESCRIBE CORNER LOCATION RELATIVE TO NEAR-BY FEATURES, ALSO HOW TO REACH CORNER

4

PLANE COORDINATE POSITION DATA

State _____ Zone _____
X _____
Y _____
Estab. By _____
Agency

8

Signature
Walt Miller

Title
PLS

Division
CS

Headquarters
SO

Date
12/86

5

CORNER RECORD (PERPETUATION)

MONUMENT: DESCRIBE NEW MONUMENT SET, OR WORK DONE TO PRESERVE EXISTING MONUMENT

I set in the hole for the stone a $2\frac{1}{2}$ " X 30" Aluminum Pipe Aluminum cap rising 4", from which:

A 5" Ponderosa Pine bears N73°E at 40.3 ft., to a 60-Penny spike in the NE base, marked X BT.

A 6" Ponderosa Pine bears S55°E at 52.3 ft., to a 60-Penny spike in the NE base, marked T17SR10ES4BT.

A 10" Ponderosa Pine bears S80½°W at 85.0 ft., to a 60-Penny spike in the S base, marked T17SR10ES5BT.

A 10" Ponderosa Pine bears N25°W at 99.6 ft., to a 60-Penny spike in the SW base, marked T16SR10ES32BT.

Resultant to the only B.T. is N54°E at 38ft., which I believe to be a transported location.

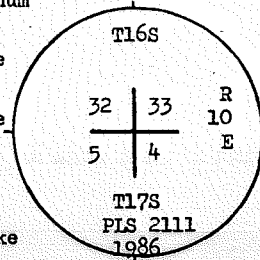

ISTING EVIDENCE

Work Done By Walt Miller Title PLS Date 12/86 State Registration No. 2111
 or Agency _____
 Certified Cor. Record Prepared? Yes No Filed At: DES. CO. Date 12/18/86

REMARKS

Original Survey By G. Newman Date 08/09/1871

ORIGINAL DESCRIPTION:

Set Stone 16x6x6 for corner to Secs 32 & 33 from which

A pine 6 in diam bears N 41° E 45 lks dist

Index File No. 0475 T. 16 R. 10 M. Tract or Surv. No. _____ Cor. 2-09

USDA-FOREST SERVICE

Index

File No. _____

CORNER RECORD (SEARCH)

(Ref. FSM 7.151.4)

Tract or

Survey No. _____

Cor.

No. Z-13

T. 16 S. R. 10 E.

R.D. SISTERS

County DESCHUTES

Sec. 33 of Sec. 33

Merid. WILLAMETTE

N.F. DESCHUTES

State OREGON

Cor. of Sec. 4 of Sec. 33

CORNER DIAGRAM PER LEGEND

DESCRIBE CORNER MONUMENT FOUND

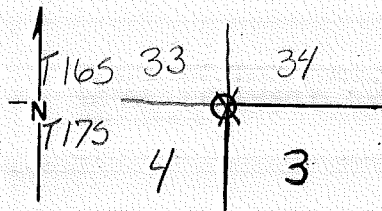

SEE : T175 R10E A-13

EV. FD.

DESCRIBE BEARING TREES OR OTHER OFFICIAL ACCESSORIES FOUND

PHOTO IDENTIFICATION DATA

Photo No. _____

Filed At. _____

Object Ident. _____

Ident. By _____

Signature

DESCRIBE CORNER LOCATION RELATIVE TO NEAR-BY FEATURES, ALSO HOW TO REACH CORNER

Corner Legend:

Searched for/Not Found

Evidence Found/Accept.

Permanent Monument

Signature _____

Title _____

Division _____

Headquarters _____

Date _____

D-7100-52 (3/79)

CORNER RECORD (PERPETUATION)

MONUMENT DESCRIBE NEW MONUMENT SET, OR WORK DONE TO PRESERVE EXISTING MONUMENT

MONUMENT STAMPED

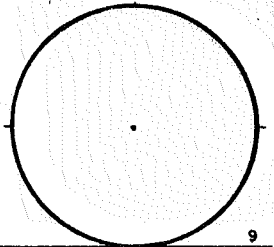

9

ACCESSORIES DESCRIBE NEW BT'S WITNESS OBJECTS ETC. ESTABLISHED, OR WORK DONE TO PRESERVE EXISTING EVIDENCE

10

Work Done By PLAT PREPARED OR Title _____ Date _____ State Registration No. or Agency _____
Certified Cor Record Prepared? Yes No Filed At: Co. SURVEYOR'S OFFICE Date _____

11

REMARKS

Index File No.

T.

S., R.

E., W. M.

Tract or Surv. No.

Cor.

12

13

Index File No. 2575

CORNER RECORD (SEARCH)
(Ref. FSM 7151.4)

Tract or Survey No. _____ Cor. No. 2-25

T 16S R. 10E R.D. SISTERS County Deschutes SE Cor. Sec 36
Merid. Will N.F. Deschutes State Oregon NW Cor. Sec. 6

CORNER DIAGRAM

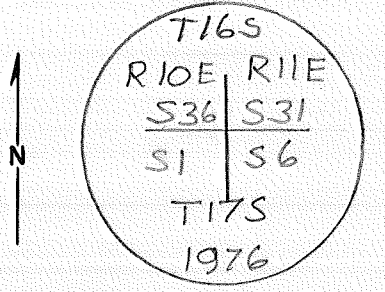

DESCRIBE CORNER MONUMENT FOUND

AT ORIG Township Cor Secs 1, 6, 31, & 36, AT the SW. Cor T16SR11E, Mon. By George W. NEWMAN IN 1871 with a Volcanic stone, 22"x12"x8", (Rec 18"x9"x7"), Firmly set 7" in Grnd. MKd. with 6 notches on N. and 6 Notches₂

DESCRIBE BEARING TREES OR OTHER OFFICIAL ACCESSORIES FOUND

on E. Edges; Cor Has Been Perpetuated By A 1" I.P. with 2" B.C. Protruding 4" Above GRND AT a dist of 1 K. N. of True Cor Pt. with B.C. MKD. I left The Ref. IP in its orig. Position  Orig B.T.

PHOTO IDENTIFICATION DATA

Photo No. _____
Filed At. _____
Object Ident. _____
Ident. By _____
Signature _____ 7

DESCRIBE CORNER LOCATION RELATIVE TO NEAR-BY FEATURES, ALSO HOW TO REACH CORNER

Mkd with Healed Blaze Facing Cor.
A Down & Rotted Pine snag, 18" Diam Brs S89°W, 86 Ks Dist. No MKs visible
A Pine 32" Dia. Brs. N64°W (Rec. N69°W) 95 Ks Dist. with scribe mks "ES36" and other mkds visible on Double open Blaze 1800' W. of Forest Road 1139 4

PLANE COORDINATE POSITION DATA

State _____ Zone _____
X _____
Y _____
Estab. By _____
Agency _____ 8

Signature D. F.
Dan Sankwich

Title S. A. Division Headquarters

Date 10/79 7100-52-(3/68) 5
7/76

CORNER RECORD (PERPETUATION)

MONUMENT: DESCRIBE NEW MONUMENT SET, OR WORK DONE TO PRESERVE EXISTING MONUMENT

AT Cor PT set A $2\frac{1}{2}' \times 28''$ IP 24" in Grnd with BC Mkd.
 ORIG Stone Deposited. Along side IP.

9

ACCESSORIES: DESCRIBE NEW BT's WITNESS OBJECTS ETC. ESTABLISHED, OR WORK DONE TO PRESERVE EXISTING EVIDENCE

A Pine 20" Brs. N 39° E 102 IKs, Mkd T16SR11ES31 BT
 A Pine 12" Brs. S $46\frac{3}{4}^\circ$ W 159 IKs, Mkd. T17SRIDES1 BT

B.T. Tags Posted

10

Work Done By Joe Garrison Title BLM Date 7/76 State Registration No. or Agency _____

Certified Cor. Record Prepared? Yes No Filed At: _____ Date _____

11

REMARKS

SOUTHWEST CORNER OF S. 31 #00108Y 5/00
 FOUND 3-1/4" BCSP RISING 7" ABOVE GROUND AS SET BY THE
 BLM AND PER CERTIFICATES FILED BY KAUFFMAN.
 N=902248.24 E=4667895.26 W. Miller

12

Index File No. 2575 T. 16 SR. 106M.

Tract or Surv. No.

Cor. 2-25¹³